



Revolution Products

MISIÓN LIBRARY FURNITURE 2026 PRICE LIST

EFFECTIVE 12/1/25, PLEASE ADD 50% TO ALL LIST PRICES IN THIS CATALOG.



Revolution Products
259 Whip O Will Drive
Clinton, SC29325
864-547-5727

MISIÓN

Welcome to **MISIÓN** from Revolution Products. Based in the Arts and Crafts movement of furniture **MISIÓN** will compliment any architectural setting.

Index

I.	Terms and Conditions	
II.	MISION Reading Tables	Pgs. 4-6
III.	MISION IT Tables with monitor racks	Pgs. 7-8
IV.	MISION IT Workstations with adjustable height work surfaces	Pgs. 9-10
V.	MISION Single Face & Hexagonal Study Carrels	Pg. 11
VI.	MISION Double Face Study Carrels	Pg. 12
VII.	MISION Display Units	Pg. 13
VIII.	MISION End Panels	Pgs. 14-27

MISIÓN

TERMS OF SALE: All prices are FOB Clinton, SC. Net 30 days from date of shipment. All prices are list and subject to change without notice. Interest of 2% per month will be assessed on past due invoices. Possession of price list does not constitute authority to purchase or sell products herein.

TAXES: All applicable taxes are extra. If a client is tax exempt please provide tax certificate.

ORDERING: Orders must have all pertinent information provided before they will be processed and entered including model numbers, quantities and finish, laminate and fabric selections where appropriate. Please provide a requested by date, or not to ship before date on your order.

WARRANTY: All items are warranted for 10 years unless otherwise stated. Warranty is for initial purchaser and only valid as long as the product is owned by original customer. The warranty, which begins at date of manufacture, covers defects in materials and workmanship found during the normal usage of product during the warranty period. Revolution Products will at its option repair or replace the defective product with a comparable component or product. Warranty does not cover any "Customers Own Material" used in manufacture. Except as stated above, Revolution Products makes no express or implied warranties as to any product and in particular makes no warranty of fitness for any particular use. At Revolution Products option, product repair, or replacement is the customer's exclusive remedy for any and all product defects.

BIFMA AND ANSI TESTING: All products offered by Revolution Products meet or exceed applicable BIFMA and ANSI testing standards.

NEW ACCOUNTS: New Accounts can only be established with the approval of a Revolution Products representative. New accounts will be subject to special credit reference requirements and deposit terms before they are approved.

MISIÓN

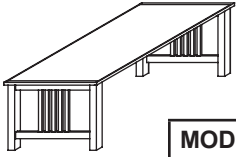

READING TABLES

MODEL NUMBER	DESCRIPTION	LIST PRICE
M-3648-O	Table 36" deep x 48" wide, HPL top 1 1/4" thick with 3/4" wide x 1 5/8" high drop edge banding on all edges in oak, 2 end frames consisting of 2 1/2" solid oak legs, apron and stretcher 2 1/2" high X 1 1/4" thick with 5 each vertical pilasters 1 7/8" wide x 3/4" thick, a ladder keel and metal leg plates add structural support to the table	5136.00
M-3060-O	Table 30" deep x 60" wide, HPL top 1 1/4" thick with 3/4" wide x 1 5/8" high drop edge banding on all edges in oak, 2 end frames consisting of 2 1/2" solid oak legs, apron and stretcher 2 1/2" high X 1 1/4" thick with 5 each vertical pilasters 1 7/8" wide x 3/4" thick, a ladder keel and metal leg plates add structural support to the table	5310.00
M-3660-O	Table 36" deep x 60" wide, HPL top 1 1/4" thick with 3/4" wide x 1 5/8" high drop edge banding on all edges in oak, 2 end frames consisting of 2 1/2" solid oak legs, apron and stretcher 2 1/2" high X 1 1/4" thick with 5 each vertical pilasters 1 7/8" wide x 3/4" thick, a ladder keel and metal leg plates add structural support to the table	5393.00
M-3672-O	Table 36" deep x 72" wide, HPL top 1 1/4" thick with 3/4" wide x 1 5/8" high drop edge banding on all edges in oak, 2 end frames consisting of 2 1/2" solid oak legs, apron and stretcher 2 1/2" high X 1 1/4" thick with 5 each vertical pilasters 1 7/8" wide x 3/4" thick, a ladder keel and metal leg plates add structural support to the table	5672.00
M-3696-O	Table 36" deep x 96" wide, HPL top 1 1/4" thick with 2 5/8" wide edge banding on ends and 1/2" deep edge banding on long edges in oak, 2 end frames consisting of 2 1/2" solid oak legs, apron and stretcher 2 1/2" high X 1 1/4" thick with 5 each vertical pilasters 1 7/8" wide x 3/4" thick, a ladder keel and metal leg plates and structure to the table	6806.00

MISIÓN

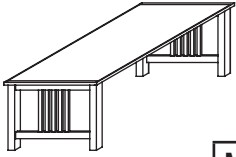

READING TABLES

MODEL NUMBER	DESCRIPTION	LIST PRICE
M-4272-O	Table 42" deep x 72" wide, HPL top 1 1/4" thick with 3/4" wide x 1 5/8" high drop edge banding on all edges in oak, 2 end frames consisting of 2 1/2" solid oak legs, apron and stretcher 2 1/2" high X 1 1/4" thick with 5 each vertical pilasters 1 7/8" wide x 3/4" thick, a ladder keel and metal leg plates add structural support to the table	6578.00
M-4284-O	Table 42" deep x 84" wide, HPL top 1 1/4" thick with 3/4" wide x 1 5/8" high drop edge banding on all edges in oak, 2 end frames consisting of 2 1/2" solid oak legs, apron and stretcher 2 1/2" high X 1 1/4" thick with 5 each vertical pilasters 1 7/8" wide x 3/4" thick, a ladder keel and metal leg plates add structural support to the table	6900.00
M-4296-O	Table 42" deep x 96" wide, HPL top 1 1/4" thick with 3/4" wide x 1 5/8" high drop edge banding on all edges in oak, 2 end frames consisting of 2 1/2" solid oak legs, apron and stretcher 2 1/2" high X 1 1/4" thick with 5 each vertical pilasters 1 7/8" wide x 3/4" thick, a ladder keel and metal leg plates add structural support to the table	6954.00
M-4872-O	Table 48" deep x 72" wide, HPL top 1 1/4" thick with 3/4" wide x 1 5/8" high drop edge banding on all edges in oak, 2 end frames consisting of 2 1/2" solid oak legs, apron and stretcher 2 1/2" high X 1 1/4" thick with 5 each vertical pilasters 1 7/8" wide x 3/4" thick, a ladder keel and metal leg plates add structural support to the table	6749.00
M-4884-O	Table 48" deep x 84" wide, HPL top 1 1/4" thick with 3/4" wide x 1 5/8" high drop edge banding on all edges in oak, 2 end frames consisting of 2 1/2" solid oak legs, apron and stretcher 2 1/2" high X 1 1/4" thick with 5 each vertical pilasters 1 7/8" wide x 3/4" thick, a ladder keel and metal leg plates add structural support to the table	6980.00

MISIÓN

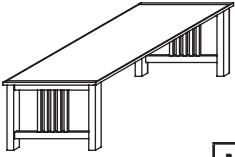

READING TABLES

MODEL NUMBER	DESCRIPTION	LIST PRICE
M-4896-O	Table 48" deep x 96" wide, HPL top 1 1/4" thick with 3/4" wide x 1 5/8" high drop edge banding on all edges in oak, 2 end frames consisting of 2 1/2" solid oak legs, apron and stretcher 2 1/2" high X 1 1/4" thick with 5 each vertical pilasters 1 7/8" wide x 3/4" thick, a ladder keel and metal leg plates add structural support to the table	7059.00
M-4242-O	Table 42" square, HPL top 1 1/4" thick with 3/4" wide x 1 5/8" deep drop edge banding on all edges, 2 1/2" solid oak legs, 2 1/2" high x 1 1/4" thick aprons	4049.00
M-4848-O	Table 48" square, HPL top 1 1/4" thick with 3/4" wide x 1 5/8" deep drop edge banding on all edges, 2 1/2" solid oak legs, 2 1/2" high x 1 1/4" thick aprons	4370.00
M-42R-O	Table 42" round, HPL top 1 1/4" thick with 3/4" wide x 1 5/8" deep drop edge banding on all edges, 2 1/2" square solid oak legs, 2 1/2" high aprons	4049.00
M-48R-O	Table 48" round, HPL top 1 1/4" thick with 3/4" wide x 1 5/8" deep drop edge banding on all edges, 2 1/2" square solid oak legs, 2 1/2" high aprons	4523.00
SUFFIX -M	For maple tables change suffix O to M and add 7 percent	
SUFFIX-C	For cherry tables change suffix O to C an consult factory for upcharge.	

MISIÓN

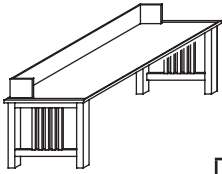

INFORMATION TECHNOLOGY TABLES WITH MONITOR RACKS

MODEL NUMBER	DESCRIPTION	LIST PRICE
M-3036-O-IT	IT table 30" deep x 36" wide, HPL top 1 1/4" thick with 3/4" wide x 1 5/8" high drop edge banding on all edges in oak, 10" high monitor rack across the back extending forward 10" on each end, 2 each end frames consisting of 2 1/2" solid oak legs, apron and stretcher 2 1/2" high X 1 1/4" thick with 5 each vertical pilasters 1 7/8" wide x 3/4" thick, a ladder keel and metal leg plates add structural support to the table	9515.00
M-3048-O-IT	IT table 30" deep x 48" wide, HPL top 1 1/4" thick with 3/4" wide x 1 5/8" high drop edge banding on all edges in oak, 10" high monitor rack across the back extending forward 10" on each end, 2 each end frames consisting of 2 1/2" solid oak legs, apron and stretcher 2 1/2" high X 1 1/4" thick with 5 each vertical pilasters 1 7/8" wide x 3/4" thick, a ladder keel and metal leg plates add structural support to the table	9231.00
M-3060-O-IT	IT table 30" deep x 60" wide, HPL top 1 1/4" thick with 3/4" wide x 1 5/8" high drop edge banding on all edges in oak, 10" high monitor rack across the back extending forward 10" on each end, 2 each end frames consisting of 2 1/2" solid oak legs, apron and stretcher 2 1/2" high X 1 1/4" thick with 5 each vertical pilasters 1 7/8" wide x 3/4" thick, a ladder keel and metal leg plates add structural support to the table	9551.00
M-3072-O-IT2	IT table 30" deep x 72" wide, HPL top 1 1/4" thick with 3/4" wide x 1 5/8" high drop edge banding on all edges in oak, 10" high monitor rack across the back extending forward 10" on each end, and 10" at the center point, dividing the table top into 2 separate work areas, 2 each end frames consisting of 2 1/2" solid oak legs, apron and stretcher 2 1/2" high X 1 1/4" thick with 5 each vertical pilasters 1 7/8" wide x 3/4" thick, a ladder keel and metal leg plates add structural support to the table	9647.00

MISIÓN

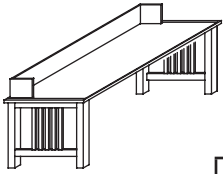

INFORMATION TECHNOLOGY TABLES WITH MONITOR RACKS

MODEL NUMBER	DESCRIPTION	LIST PRICE
M-3096-O-IT2	IT table 30" deep x 96" wide, HPL top 1 1/4" thick with 3/4" wide x 1 5/8" high	9515.00
	drop edge banding on all edges in oak, 10" high monitor rack across the back	
	extending forward 10" on each end, and 10" at the center point, dividing	
	the table top into 2 separate work areas, 2 each end frames consisting of 2 1/2"	
	solid oak legs, apron and stretcher 2 1/2" high X 1 1/4" thick with 5 each	
	vertical pilasters 1 7/8" wide x 3/4" thick, a ladder keel and metal leg plates add	
	structural support to the table	
M-3096-O-IT3	IT table 30" deep x 96" wide, HPL top 1 1/4" thick with 3/4" wide x 1 5/8" high	9618.00
	drop edges banding on all edges in oak, 10" high monitor rack across the back	
	extending forward 10" on each end, and 10" at two points point, dividing	
	the table top into 3 separate work areas, 2 each end frames consisting of 2 1/2"	
	solid oak legs, apron and stretcher 2 1/2" high X 1 1/4" thick with 5 each	
	vertical pilasters 1 7/8" wide x 3/4" thick, a ladder keel and metal leg plates add	
	structural support to the table	
SUFFIX -M	For maple IT tables change suffix O to M and add 7 percent	
SUFFIX -C	For cherry tables change suffix O to C an consult factory for upcharge.	

MISIÓN

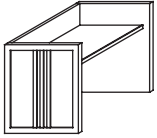

SINGLE FACE INFORMATION TECHNOLOGY WORK STATIONS WITH ADJUSTABLE HEIGHT WORK SURFACE

MODEL NUMBER	DESCRIPTION	LIST PRICE
M-3136-O-ITS	IT work station starter 31" deep x 36" wide x 39" high, 1 7/17" thick end panels	6330.00
	with 2 3/8" solid oak edge banding with vertical slats, adjustable height HPL top	
	1 1/4" thick with 3/4" deep solid oak edge banding on front edge	
M-3136-O-ITS-A	IT work station adder 31" deep x 36" wide x 39" high, 1 1/4" thick intermediate	4580.00
	panel with 1/4" solid oak edge banding, adjustable height HPL work surface	
	1 1/4" thick with 3/4" deep solid oak edge banding on front edge	
M-3148-O-ITS	IT work station starter 31" deep x 48" wide x 39" high, 1 7/16" thick end panels	7418.00
	with 2 3/8" solid oak edge banding with vertical slats, adjustable height HPL top	
	1 1/4" thick with 3/4" deep solid oak edge banding on front edge	
M-3148-O-ITS-A	IT work station adder 31" deep x 48" wide x 39" high, 1 1/4" thick intermediate	5483.00
	panel with 1/4" solid oak edge banding, adjustable height HPL work surface	
	1 1/4" thick with 3/4" deep solid oak edge banding on front edge	
M-3172-O-ITS	IT work station starter 31" deep x 72" wide x 39" high, 1 7/16" thick end panels	10562.00
	with 2 3/8" solid oak edge banding with vertical slats, adjustable height HPL top	
	1 1/4" thick with 3/4" deep solid oak edge banding on front edge and work	
	surface support	
M-3172-O-ITS-A	IT work station adder 31" deep x 72" wide x 39" high, 1 1/4" thick intermediate	8604.00
	panel with 1/4" solid oak edge banding, adjustable height HPL work surface	
	1 1/4" thick with 3/4" deep solid oak edge banding on front edge and work	
	surface support	

MISIÓN

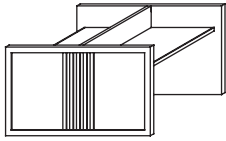

DOUBLE FACE INFORMATION TECHNOLOGY WORK STATIONS WITH ADJUSTABLE HEIGHT WORK SURFACE

MODEL NUMBER	DESCRIPTION	LIST PRICE
M-3136-O-ITDF	Carrel work station, double faced, starter 61" deep x 38" wide x 48" high,	10125.00
	1 7/16" thick end panels with 2 3/8" wide edge banding with 5 each 1 3/4" wide	
	vertical slats, 2 each 1 1/4" thick HPL work surfaces with 3/4" oak edge banding	
	on front edge	
M-3136-O-ITDF-A	Carrel work station, double faced, adder 61" deep x 36 1/2" wide x 48" high, 1 1/4" thick intermediate panel with 1/4" thick edge banding, 2 each 1 1/4" thick	6581.00
	HPL work surfaces with 3/4" thick oak edge banding on front edge	
M-3148-O-ITDF	Carrel work station, double faced, starter 61" deep x 50" wide x 48" high,	11057.00
	1 7/16" thick end panels with 2 3/8" wide edge banding with 5 each 1 3/4" wide	
	vertical slats, 2 each 1 1/4" thick HPL work surfaces with 3/4" oak edge banding	
	on front edge	
M-3148-O-ITDF-A	Carrel work station, double faced, adder 61" deep x 48 1/2" wide x 48" high, 1 1/4" thick intermediate panel with 1/4" thick edge banding, 2 each 1 1/4" thick	7521.00
	HPL work surfaces with 3/4" thick oak edge banding on front edge	
M-3172-O-ITDF	Carrel work station, double faced, starter 61" deep x 74" wide x 48" high,	14814.00
	1 7/16" thick end panels with 2 3/8" wide edge banding with 5 each 1 3/4" wide	
	vertical slats, 2 each 1 1/4" thick HPL work surfaces with 1/2" oak edge banding	
	on front edge and work surface support	
M-3172-O-ITDF-A	Carrel work station, double faced, adder 61" deep x 72 1/2" wide x 48" high, 1 1/4" thick intermediate panel with 1/4" thick edge banding, 2 each 1 1/4" thick	10488.00
	HPL work surfaces with 3/4" thick oak edge banding on front edge and work	
	surface support	
SUFFIX-M	For maple carrels change suffix O to M and add 7 percent.	
SUFFIX-C	For cherry tables change suffix O to C an consult factory for upcharge.	

MISIÓN

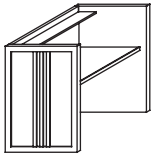

SINGLE FACE & HEXAGONAL STUDY CARRELS

MODEL NUMBER	DESCRIPTION	LIST PRICE
M-3136-O-C	Carrel work station starter 31" deep x 38" wide x 48" high, 1 7/16" thick end panels with 2 3/8" thick solid oak edge banding and 1 3/4" wide vertical slats, 1 1/4" thick HPL work surface with 3/4" deep solid oak edge banding on front edge	6581.00
M-3136-O-C-A	Carrel work station adder 31" deep x 36 1/2" wide x 48" high, 1 1/4" thick intermediate panel with 1/4" thick edge banding, 1 1/4" thick HPL work surface with 3/4" deep solid oak edge banding on front edge	4379.00
M-3150-O-C	Carrel work station starter 31" deep x 50" wide x 48" high, 1 7/16" thick end panels with 2 3/8" thick solid oak edge banding and 1 3/4" wide vertical slats, 1 1/4" thick HPL work surface with 3/4" deep solid oak edge banding on front edge	7295.00
M-3148-O-C-A	Carrel work station adder 31" deep x 48 1/2" wide x 48" high, 1 1/4" thick intermediate panel with 1/4" thick edge banding, 1 1/4" thick HPL work surface with 3/4" deep solid oak edge banding on front edge	4862.00
M-3174-O-C	Carrel work station starter 31" deep x 74" wide x 48" high, 1 7/16" thick end panels with 2 3/8" thick solid oak edge banding and 1 3/4" wide vertical slats, 1 1/4" thick HPL work surface with 3/4" deep solid oak edge banding on front edge and work surface support	10125.00
M-3172-O-C-A	Carrel work station adder 31" deep x 72 1/2" wide x 48" high, 1 1/4" thick intermediate panel with 1/4" thick edge banding, 1 1/4" thick HPL work surface with 3/4" deep solid oak edge banding on front edge and work surface support	8076.00
M-9898-O-HEX	Hexagonal OPAC station with 6 work spaces 98" x 98" with central core for wiring access, 1 1/4" thick HPL work surfaces with 3/4" deep solid oak edge banding on front edge, 1 1/4" thick divider panels with 1/4" solid oak edge banding	22283.00
M-9849-O-1/2HEX	Half hexagonal OPAC station with 3 work spaces 98" x 49" with open central core for wiring access, 1 1/4" thick HPL work surfaces with 3/4" deep solid oak edge banding on front edge, 1 1/4" thick divider panels with 1/4" solid oak edge banding	14433.00

MISIÓN

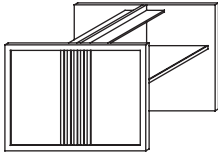

DOUBLE FACE STUDY CARRELS

MODEL NUMBER	DESCRIPTION	LIST PRICE
M-3136-O-CDF	Carrel work station, double faced, starter 61" deep x 38" wide x 48" high, 1 7/16" thick end panels with 2 3/8" wide edge banding with 5 each 1 3/4" wide vertical	9318.00
	slats, 2 each 1 1/4" thick HPL work surfaces with 3/4" oak edge banding on front	
	edge	
M-3136-O-CDF-A	Carrel work station, double faced, adder 61" deep x 36 1/2" wide x 48" high, 1 1/4" thick intermediate panel with 1/4" thick edge banding, 2 each 1 1/4" thick	5868.00
	HPL work surfaces with 3/4" thick oak edge banding on front edge	
M-3148-O-CDF	Carrel work station, double faced, starter 61" deep x 50" wide x 48" high, 1 7/16" thick end panels with 2 3/8" wide edge banding with 5 each 1 3/4" wide vertical	10493.00
	slats, 2 each 1 1/4" thick HPL work surfaces with 1/2" oak edge banding on front	
	edge	
M-3148-O-CDF-A	Carrel work station, double faced, adder 61" deep x 48 1/2" wide x 48" high, 1 1/4" thick intermediate panel with 1/4" thick edge banding, 2 each 1 1/4" thick	6935.00
	HPL work surfaces with 3/4" thick oak edge banding on front edge	
M-3172-O-CDF	Carrel work station, double faced, starter 61" deep x 74" wide x 48" high, 1 7/16" thick end panels with 2 3/8" wide edge banding with 5 each 1 3/4" wide vertical	14409.00
	slats, 2 each 1 1/4" thick HPL work surfaces with 3/4" oak edge banding on front	
	edge and work surface support	
M-3172-O-CDF-A	Carrel work station, double faced, adder 61" deep x 72 1/2" wide x 48" high, 1 1/4" thick intermediate panel with 1/4" thick edge banding, 2 each 1 1/4" thick	10487.00
	HPL work surfaces with 3/4" thick oak edge banding on front edge and work	
	surface support	
SUFFIX-M	For maple carrels change suffix O to M and add 7 percent.	
SUFFIX-C	For cherry tables change suffix O to C an consult factory for upcharge.	

MISIÓN

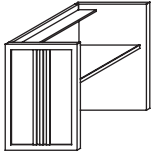

DISPLAY UNITS

MODEL NUMBER	DESCRIPTION	LIST PRICE
M-AS-3045-O	Atlas stand with 2 3/8" edge banding on end panels with vertical slats with 5 each pull out shelves	8061.00
M-DS-2445-O	Dictionary stand with 2 3/8" edge banding on end panels with vertical slats with base shelf and 1 adjustable shelf	6504.00
M-TI-72-DFT-O	Index table double faced, double tier 49" deep x 72" wide x 50" high, HPL top 1 1/4" thick with 3/4" wide x 1 5/8" high drop edge banding on all edges, 2 each end frames consisting of 2 1/2" solid oak legs, 2 1/2" high apron and stretcher with 5 each vertical pilasters 1 7/8" wide x 3/4" thick, double tier index rack with removable shelves, a ladder keel and metal leg plates for structural support	9504.00
M-TI-90-DFT-O	Index table double faced, double tier 49" deep x 90" wide x 50" high, HPL top 1 1/4" thick with 3/4" wide x 1 5/8" high drop edge banding on all edges, 2 each end frames consisting of 2 1/2" solid oak legs, 2 1/2" high apron and stretcher with 5 each vertical pilasters 1 7/8" wide x 3/4" thick, double tier index rack with removable shelves, a ladder keel and metal leg plates for structural support	11879.00
M-6331-DSP-O	Display table 63 1/2" wide x 31" deep x 38 11/16" high, HPL top 1 1/4" thick with 3/4" wide x 1 5/8" high drop edge banding on all edges, 2 each end frames consisting of 2 1/2" solid oak legs, 2 1/2" high apron and stretcher with 5 each vertical pilasters 1 7/8" wide x 3/4" thick, a ladder keel and metal leg plates for structural support glass case to be 59" wide x 29" deep x 9 11/16" high	14210.00
SUFFIX-M	For maple display products change suffix O to M and add 7 percent	
SUFFIX-C	For cherry tables change suffix O to C an consult factory for upcharge.	

MISIÓN

END PANELS IN OAK

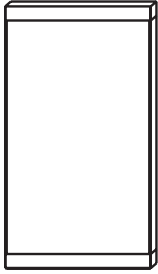

MODEL NUMBER	DESCRIPTION	LIST PRICE
M-4412-DF-O	End panel 44" high x 12" deep, 1 1/8" thick with 2 3/8" solid oak edge banding at top and bottom with 1/4" thick solid oak edge banding on vertical edges	1088.00
M-4413-DF-O	End panel 44" high x 13" deep, 1 1/8" thick with 2 3/8" solid oak edge banding at top and bottom with 1/4" thick solid oak edge banding on vertical edges	1127.00
M-4414-DF-O	End panel 44" high x 14" deep, 1 1/8" thick with 2 3/8" solid oak edge banding at top and bottom with 1/4" thick solid oak edge banding on vertical edges	1133.00
M-4416-DF-O	End panel 44" high x 16" deep, 1 1/8" thick with 2 3/8" solid oak edge banding at top and bottom with 1/4" thick solid oak edge banding on vertical edges	1203.00
M-4418-DF-O	End panel 44" high x 18" deep, 1 1/8" thick with 2 3/8" solid oak edge banding at top and bottom with 1/4" thick solid oak edge banding on vertical edges	1232.00
M-4420-DF-O	End panel 44" high x 20" deep, 1 1/8" thick with 2 3/8" solid oak edge banding at top and bottom with 1/4" thick solid oak edge banding on vertical edges	1256.00
M-4422-DF-O	End panel 44" high x 22" deep, 1 1/8" thick with 2 3/8" solid oak edge banding at top and bottom with 1/4" thick solid oak edge banding on vertical edges	1439.00
M-4424-DF-O	End panel 44" high x 24" deep, 1 1/8" thick with 2 3/8" solid oak edge banding at top and bottom with 1/4" thick solid oak edge banding on vertical edges	1464.00
M-4425-DF-O	End panel 44" high x 25" deep, 1 1/8" thick with 2 3/8" solid oak edge banding at top and bottom with 1/4" thick solid oak edge banding on vertical edges	1557.00
M-4428-DF-O	End panel 44" high x 28" deep, 1 1/8" thick with 2 3/8" solid oak edge banding at top and bottom with 1/4" thick solid oak edge banding on vertical edges	1565.00
M-4432-DF-O	End panel 44" high x 32" deep, 1 1/8" thick with 2 3/8" solid oak edge banding at top and bottom with 1/4" thick solid oak edge banding on vertical edges	1826.00
M-4812-DF-O	End panel 48" high x 12" deep, 1 1/8" thick with 2 3/8" solid oak edge banding at top and bottom with 1/4" thick solid oak edge banding on vertical edges	1088.00
M-4813-DF-O	End panel 48" high x 13" deep, 1 1/8" thick with 2 3/8" solid oak edge banding at top and bottom with 1/4" thick solid oak edge banding on vertical edges	1127.00

MISIÓN

END PANELS IN OAK

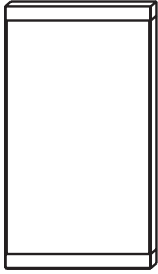

MODEL NUMBER	DESCRIPTION	LIST PRICE
M-4814-DF-O	End panel 48" high x 14" deep, 1 1/8" thick with 2 3/8" solid oak edge banding at top and bottom with 1/4" thick solid oak edge banding on vertical edges	1133.00
M-4816-DF-O	End panel 48" high x 16" deep, 1 1/8" thick with 2 3/8" solid oak edge banding at top and bottom with 1/4" thick solid oak edge banding on vertical edges	1203.00
M-4818-DF-O	End panel 48" high x 18" deep, 1 1/8" thick with 2 3/8" solid oak edge banding at top and bottom with 1/4" thick solid oak edge banding on vertical edges	1232.00
M-4820-DF-O	End panel 48" high x 20" deep, 1 1/8" thick with 2 3/8" solid oak edge banding at top and bottom with 1/4" thick solid oak edge banding on vertical edges	1256.00
M-4822-DF-O	End panel 48" high x 22" deep, 1 1/8" thick with 2 3/8" solid oak edge banding at top and bottom with 1/4" thick solid oak edge banding on vertical edges	1439.00
M-4824-DF-O	End panel 48" high x 24" deep, 1 1/8" thick with 2 3/8" solid oak edge banding at top and bottom with 1/4" thick solid oak edge banding on vertical edges	1464.00
M-4825-DF-O	End panel 48" high x 25" deep, 1 1/8" thick with 2 3/8" solid oak edge banding at top and bottom with 1/4" thick solid oak edge banding on vertical edges	1557.00
M-4828-DF-O	End panel 48" high x 28" deep, 1 1/8" thick with 2 3/8" solid oak edge banding at top and bottom with 1/4" thick solid oak edge banding on vertical edges	1565.00
M-4832-DF-O	End panel 48" high x 32" deep, 1 1/8" thick with 2 3/8" solid oak edge banding at top and bottom with 1/4" thick solid oak edge banding on vertical edges	1824.00
M-5012-DF-O	End panel 50" high x 12" deep, 1 1/8" thick with 2 3/8" solid oak edge banding at top and bottom with 1/4" thick solid oak edge banding on vertical edges	1161.00
M-5013-DF-O	End panel 50" high x 13" deep, 1 1/8" thick with 2 3/8" solid oak edge banding at top and bottom with 1/4" thick solid oak edge banding on vertical edges	1211.00
M-5014-DF-O	End panel 50" high x 14" deep, 1 1/8" thick with 2 3/8" solid oak edge banding at top and bottom with 1/4" thick solid oak edge banding on vertical edges	1236.00
M-5016-DF-O	End panel 50" high x 16" deep, 1 1/8" thick with 2 3/8" solid oak edge banding at top and bottom with 1/4" thick solid oak edge banding on vertical edges	1280.00

MISIÓN

END PANELS IN OAK

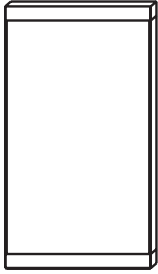

MODEL NUMBER	DESCRIPTION	LIST PRICE
M-5018-DF-O	End panel 50" high x 18" deep, 1 1/8" thick with 2 3/8" solid oak edge banding at top and bottom with 1/4" thick solid oak edge banding on vertical edges	1209.00
M-5020-DF-O	End panel 50" high x 20" deep, 1 1/8" thick with 2 3/8" solid oak edge banding at top and bottom with 1/4" thick solid oak edge banding on vertical edges	1233.00
M-5022-DF-O	End panel 50" high x 22" deep, 1 1/8" thick with 2 3/8" solid oak edge banding at top and bottom with 1/4" thick solid oak edge banding on vertical edges	1401.00
M-5024-DF-O	End panel 50" high x 24" deep, 1 1/8" thick with 2 3/8" solid oak edge banding at top and bottom with 1/4" thick solid oak edge banding on vertical edges	1428.00
M-5025-DF-O	End panel 50" high x 25" deep, 1 1/8" thick with 2 3/8" solid oak edge banding at top and bottom with 1/4" thick solid oak edge banding on vertical edges	1512.00
M-5028-DF-O	End panel 50" high x 28" deep, 1 1/8" thick with 2 3/8" solid oak edge banding at top and bottom with 1/4" thick solid oak edge banding on vertical edges	1521.00
M-5032-DF-O	End panel 50" high x 32" deep, 1 1/8" thick with 2 3/8" solid oak edge banding at top and bottom with 1/4" thick solid oak edge banding on vertical edges	1760.00
M-6612-DF-O	End panel 66" high x 12" deep, 1 1/8" thick with 2 3/8" solid oak edge banding at top and bottom with 1/4" thick solid oak edge banding on vertical edges	1130.00
M-6613-DF-O	End panel 66" high x 13" deep, 1 1/8" thick with 2 3/8" solid oak edge banding at top and bottom with 1/4" thick solid oak edge banding on vertical edges	1280.00
M-6614-DF-O	End panel 66" high x 14" deep, 1 1/8" thick with 2 3/8" solid oak edge banding at top and bottom with 1/4" thick solid oak edge banding on vertical edges	1298.00
M-6616-DF-O	End panel 66" high x 16" deep, 1 1/8" thick with 2 3/8" solid oak edge banding at top and bottom with 1/4" thick solid oak edge banding on vertical edges	1439.00
M-6618-DF-O	End panel 66" high x 18" deep, 1 1/8" thick with 2 3/8" solid oak edge banding at top and bottom with 1/4" thick solid oak edge banding on vertical edges	1464.00
M-6620-DF-O	End panel 66" high x 20" deep, 1 1/8" thick with 2 3/8" solid oak edge banding at top and bottom with 1/4" thick solid oak edge banding on vertical edges	1331.00

MISIÓN

END PANELS IN OAK

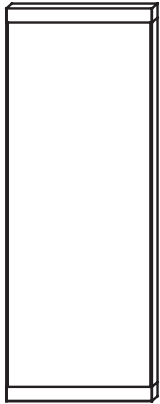

MODEL NUMBER	DESCRIPTION	LIST PRICE
M-6622-DF-O	End panel 66" high x 22" deep, 1 1/8" thick with 2 3/8" solid oak edge banding at top and bottom with 1/4" thick solid oak edge banding on vertical edges	1724.00
M-6624-DF-O	End panel 66" high x 24" deep, 1 1/8" thick with 2 3/8" solid oak edge banding at top and bottom with 1/4" thick solid oak edge banding on vertical edges	1746.00
M-6625-DF-O	End panel 66" high x 25" deep, 1 1/8" thick with 2 3/8" solid oak edge banding at top and bottom with 1/4" thick solid oak edge banding on vertical edges	1847.00
M-6628-DF-O	End panel 66" high x 28" deep, 1 1/8" thick with 2 3/8" solid oak edge banding at top and bottom with 1/4" thick solid oak edge banding on vertical edges	1865.00
M-6632-DF-O	End panel 66" high x 32" deep, 1 1/8" thick with 2 3/8" solid oak edge banding at top and bottom with 1/4" thick solid oak edge banding on vertical edges	2022.00
M-7812-DF-O	End panel 78" high x 12" deep, 1 1/8" thick with 2 3/8" solid oak edge banding at top and bottom with 1/4" thick solid oak edge banding on vertical edges	1263.00
M-7813-DF-O	End panel 78" high x 13" deep, 1 1/8" thick with 2 3/8" solid oak edge banding at top and bottom with 1/4" thick solid oak edge banding on vertical edges	1391.00
M-7814-DF-O	End panel 78" high x 14" deep, 1 1/8" thick with 2 3/8" solid oak edge banding at top and bottom with 1/4" thick solid oak edge banding on vertical edges	1415.00
M-7816-DF-O	End panel 78" high x 16" deep, 1 1/8" thick with 2 3/8" solid oak edge banding at top and bottom with 1/4" thick solid oak edge banding on vertical edges	1415.00
M-7818-DF-O	End panel 78" high x 18" deep, 1 1/8" thick with 2 3/8" solid oak edge banding at top and bottom with 1/4" thick solid oak edge banding on vertical edges	1514.00
M-7820-DF-O	End panel 78" high x 20" deep, 1 1/8" thick with 2 3/8" solid oak edge banding at top and bottom with 1/4" thick solid oak edge banding on vertical edges	1562.00
M-7822-DF-O	End panel 78" high x 22" deep, 1 1/8" thick with 2 3/8" solid oak edge banding at top and bottom with 1/4" thick solid oak edge banding on vertical edges	1743.00
M-7824-DF-O	End panel 78" high x 24" deep, 1 1/8" thick with 2 3/8" solid oak edge banding at top and bottom with 1/4" thick solid oak edge banding on vertical edges	1770.00

MISIÓN

END PANELS IN OAK



MODEL NUMBER	DESCRIPTION	LIST PRICE
M-7825-DF-O	End panel 78" high x 25" deep, 1 1/8" thick with 2 3/8" solid oak edge banding at top and bottom with 1/4" thick solid oak edge banding on vertical edges	1685.00
M-7828-DF-O	End panel 78" high x 28" deep, 1 1/8" thick with 2 3/8" solid oak edge banding at top and bottom with 1/4" thick solid oak edge banding on vertical edges	1794.00
M-7832-DF-O	End panel 78" high x 32" deep, 1 1/8" thick with 2 3/8" solid oak edge banding at top and bottom with 1/4" thick solid oak edge banding on vertical edges	2024.00
M-8412-DF-O	End panel 84" high x 12" deep, 1 1/8" thick with 2 3/8" solid oak edge banding at top and bottom with 1/4" thick solid oak edge banding on vertical edges	1362.00
M-8413-DF-O	End panel 84" high x 13" deep, 1 1/8" thick with 2 3/8" solid oak edge banding at top and bottom with 1/4" thick solid oak edge banding on vertical edges	1479.00
M-8414-DF-O	End panel 84" high x 14" deep, 1 1/8" thick with 2 3/8" solid oak edge banding at top and bottom with 1/4" thick solid oak edge banding on vertical edges	1491.00
M-8416-DF-O	End panel 84" high x 16" deep, 1 1/8" thick with 2 3/8" solid oak edge banding at top and bottom with 1/4" thick solid oak edge banding on vertical edges	1595.00
M-8418-DF-O	End panel 84" high x 18" deep, 1 1/8" thick with 2 3/8" solid oak edge banding at top and bottom with 1/4" thick solid oak edge banding on vertical edges	1619.00
M-8420-DF-O	End panel 84" high x 20" deep, 1 1/8" thick with 2 3/8" solid oak edge banding at top and bottom with 1/4" thick solid oak edge banding on vertical edges	1647.00
M-8422-DF-O	End panel 84" high x 22" deep, 1 1/8" thick with 2 3/8" solid oak edge banding at top and bottom with 1/4" thick solid oak edge banding on vertical edges	1854.00
M-8424-DF-O	End panel 84" high x 24" deep, 1 1/8" thick with 2 3/8" solid oak edge banding at top and bottom with 1/4" thick solid oak edge banding on vertical edges	1866.00
M-8425-DF-O	End panel 84" high x 25" deep, 1 1/8" thick with 2 3/8" solid oak edge banding at top and bottom with 1/4" thick solid oak edge banding on vertical edges	2048.00
M-8428-DF-O	End panel 84" high x 28" deep, 1 1/8" thick with 2 3/8" solid oak edge banding at top and bottom with 1/4" thick solid oak edge banding on vertical edges	2070.00

MISIÓN

END PANELS IN OAK



MODEL NUMBER	DESCRIPTION	LIST PRICE
M-8432-DF-O	End panel 84" high x 32" deep, 1 1/8" thick with 2 3/8" solid oak edge banding at top and bottom with 1/4" thick solid oak edge banding on vertical edges	2175.00
M-9012-DF-O	End panel 90" high x 12" deep, 1 1/8" thick with 2 3/8" solid oak edge banding at top and bottom with 1/4" thick solid oak edge banding on vertical edges	1362.00
M-9013-DF-O	End panel 90" high x 13" deep, 1 1/8" thick with 2 3/8" solid oak edge banding at top and bottom with 1/4" thick solid oak edge banding on vertical edges	1478.00
M-9014-DF-O	End panel 90" high x 14" deep, 1 1/8" thick with 2 3/8" solid oak edge banding at top and bottom with 1/4" thick solid oak edge banding on vertical edges	1491.00
M-9016-DF-O	End panel 90" high x 16" deep, 1 1/8" thick with 2 3/8" solid oak edge banding at top and bottom with 1/4" thick solid oak edge banding on vertical edges	1595.00
M-9018-DF-O	End panel 90" high x 18" deep, 1 1/8" thick with 2 3/8" solid oak edge banding at top and bottom with 1/4" thick solid oak edge banding on vertical edges	1622.00
M-9020-DF-O	End panel 90" high x 20" deep, 1 1/8" thick with 2 3/8" solid oak edge banding at top and bottom with 1/4" thick solid oak edge banding on vertical edges	1647.00
M-9022-DF-O	End panel 90" high x 22" deep, 1 1/8" thick with 2 3/8" solid oak edge banding at top and bottom with 1/4" thick solid oak edge banding on vertical edges	1856.00
M-9024-DF-O	End panel 90" high x 24" deep, 1 1/8" thick with 2 3/8" solid oak edge banding at top and bottom with 1/4" thick solid oak edge banding on vertical edges	1866.00
M-9025-DF-O	End panel 90" high x 25" deep, 1 1/8" thick with 2 3/8" solid oak edge banding at top and bottom with 1/4" thick solid oak edge banding on vertical edges	2046.00
M-9028-DF-O	End panel 90" high x 28" deep, 1 1/8" thick with 2 3/8" solid oak edge banding at top and bottom with 1/4" thick solid oak edge banding on vertical edges	2070.00
M-9032-DF-O	End panel 90" high x 32" deep, 1 1/8" thick with 2 3/8" solid oak edge banding at top and bottom with 1/4" thick solid oak edge banding on vertical edges	2172.00

MISIÓN

END PANELS IN OAK

SUFFIX-M	For maple end panels change suffix O to M and add 7 percent
SUFFIX-C	For cherry end panels change suffix O to C and contact factory for upcharge.

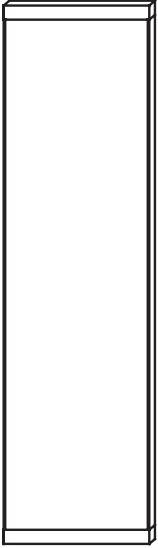

MISIÓN



END PANELS WITH VERTICAL SLATS IN OAK

MODEL NUMBER	DESCRIPTION	LIST PRICE
MA-4412-DF-O	End panel 44" high x 12" deep, 1 1/4" thick x 1 3/4" wide solid oak edge	2033.00
	banding all 4 sides with vertical slats	
MA-4413-DF-O	End panel 44" high x 13" deep, 1 1/4" thick x 1 3/4" wide solid oak edge	2073.00
	banding all 4 sides with vertical slats	
MA-4414-DF-O	End panel 44" high x 14" deep, 1 1/4" thick x 1 3/4" wide solid oak edge	2124.00
	banding all 4 sides with vertical slats	
MA-4416-DF-O	End panel 44" high x 16" deep, 1 1/4" thick x 1 3/4" wide solid oak edge	2256.00
	banding all 4 sides with vertical slats	
MA-4418-DF-O	End panel 44" high x 18" deep, 1 1/4" thick x 1 3/4" wide solid oak edge	2306.00
	banding all 4 sides with vertical slats	
MA-4420-DF-O	End panel 44" high x 20" deep, 1 1/4" thick x 1 3/4" wide solid oak edge	2351.00
	banding all 4 sides with vertical slats	
MA-4422-DF-O	End panel 44" high x 22" deep, 1 1/4" thick x 1 3/4" wide solid oak edge	2694.00
	banding all 4 sides with vertical slats	
MA-4424-DF-O	End panel 44" high x 24" deep, 1 1/4" thick x 1 3/4" wide solid oak edge	2739.00
	banding all 4 sides with vertical slats	
MA-4425-DF-O	End panel 44" high x 25" deep, 1 1/4" thick x 1 3/4" wide solid oak edge	2915.00
	banding all 4 sides with vertical slats	
MA-4428-DF-O	End panel 44" high x 28" deep, 1 1/4" thick x 1 3/4" wide solid oak edge	2934.00
	banding all 4 sides with vertical slats	
MA-4432-DF-O	End panel 44" high x 32" deep, 1 1/4" thick x 1 3/4" wide solid oak edge	3411.00
	banding all 4 sides with vertical slats	
MA-4812-DF-O	End panel 48" high x 12" deep, 1 1/4" thick x 1 3/4" wide solid oak edge	2034.00
	banding all 4 sides with vertical slats	
MA-4813-DF-O	End panel 48" high x 13" deep, 1 1/4" thick x 1 3/4" wide solid oak edge	2112.00
	banding all 4 sides with vertical slats	

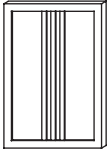

MISIÓN

END PANELS WITH VERTICAL SLATS IN OAK

MODEL NUMBER	DESCRIPTION	LIST PRICE
MA-4814-DF-O	End panel 48" high x 14" deep, 1 1/4" thick x 1 3/4" wide solid oak edge	1797.00
	banding all 4 sides with vertical slats	
MA-4816-DF-O	End panel 48" high x 16" deep, 1 1/4" thick x 1 3/4" wide solid oak edge	1902.00
	banding all 4 sides with vertical slats	
MA-4818-DF-O	End panel 48" high x 18" deep, 1 1/4" thick x 1 3/4" wide solid oak edge	1941.00
	banding all 4 sides with vertical slats	
MA-4820-DF-O	End panel 48" high x 20" deep, 1 1/4" thick x 1 3/4" wide solid oak edge	1979.00
	banding all 4 sides with vertical slats	
MA-4822-DF-O	End panel 48" high x 22" deep, 1 1/4" thick x 1 3/4" wide solid oak edge	2252.00
	banding all 4 sides with vertical slats	
MA-4824-DF-O	End panel 48" high x 24" deep, 1 1/4" thick x 1 3/4" wide solid oak edge	2291.00
	banding all 4 sides with vertical slats	
MA-4825-DF-O	End panel 48" high x 25" deep, 1 1/4" thick x 1 3/4" wide solid oak edge	2462.00
	banding all 4 sides with vertical slats	
MA-4828-DF-O	End panel 48" high x 28" deep, 1 1/4" thick x 1 3/4" wide solid oak edge	2462.00
	banding all 4 sides with vertical slats	
MA-4832-DF-O	End panel 48" high x 32" deep, 1 1/4" thick x 1 3/4" wide solid oak edge	2843.00
	banding all 4 sides with vertical slats	
MA-5012-DF-O	End panel 50" high x 12" deep, 1 1/4" thick x 1 3/4" wide solid oak edge	1838.00
	banding all 4 sides with vertical slats	
MA-5013-DF-O	End panel 50" high x 13" deep, 1 1/4" thick x 1 3/4" wide solid oak edge	1911.00
	banding all 4 sides with vertical slats	
MA-5014-DF-O	End panel 50" high x 14" deep, 1 1/4" thick x 1 3/4" wide solid oak edge	1911.00
	banding all 4 sides with vertical slats	
MA-5016-DF-O	End panel 50" high x 16" deep, 1 1/4" thick x 1 3/4" wide solid oak edge	2018.00
	banding all 4 sides with vertical slats	



MISIÓN

END PANELS WITH VERTICAL SLATS IN OAK

MODEL NUMBER	DESCRIPTION	LIST PRICE
MA-5018-DF-O	End panel 50" high x 18" deep, 1 1/4" thick x 1 3/4" thick solid oak edge	2070.00
	banding all 4 sides and vertical slats	
MA-5020-DF-O	End panel 50" high x 20" deep, 1 1/4" thick x 1 3/4" thick solid oak edge	2108.00
	banding all 4 sides and vertical slats	
MA-5022-DF-O	End panel 50" high x 22" deep, 1 1/4" thick x 1 3/4" wide solid oak edge	2397.00
	banding all 4 sides and vertical slats	
MA-5024-DF-O	End panel 50" high x 24" deep, 1 1/4" thick x 1 3/4" wide solid oak edge	2435.00
	banding all 4 sides and vertical slats	
MA-5025-DF-O	End panel 50" high x 25" deep, 1 1/4" thick x 1 3/4" wide solid oak edge	2559.00
	banding all 4 sides and vertical slats	
MA-5028-DF-O	End panel 50" high x 28" deep, 1 1/4" thick x 1 3/4" wide solid oak edge	2576.00
	banding all 4 sides and vertical slats	
MA-5032-DF-O	End panel 50" high x 32" deep, 1 1/4" thick x 1 3/4" wide solid oak edge	2973.00
	banding all 4 sides and vertical slats	
MA-6612-DF-O	End panel 66" high x 12" deep, 1 1/4" thick x 1 3/4" wide solid oak edge	1926.00
	banding all 4 sides and vertical slats	
MA-6613-DF-O	End panel 66" high x 13" deep, 1 1/4" thick x 1 3/4" wide solid oak edge	2018.00
	banding all 4 sides and vertical slats	
MA-6614-DF-O	End panel 66" high x 14" deep, 1 1/4" thick x 1 3/4" wide solid oak edge	2121.00
	banding all 4 sides and vertical slats	
MA-6616-DF-O	End panel 66" high x 16" deep, 1 1/4" thick x 1 3/4" wide solid oak edge	2268.00
	banding all 4 sides and vertical slats	
MA-6618-DF-O	End panel 66" high x 18" deep, 1 1/4" thick x 1 3/4" wide solid oak edge	2307.00
	banding all 4 sides and vertical slats	
MA-6620-DF-O	End panel 66" high x 20" deep, 1 1/4" thick x 1 3/4" wide solid oak edge	1613.00
	banding all 4 sides and vertical slats	

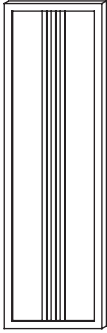

MISIÓN

END PANELS WITH VERTICAL SLATS IN OAK

MODEL NUMBER	DESCRIPTION	LIST PRICE
MA-6622-DF-O	End panel 66" high x 22" deep, 1 1/4" thick x 1 3/4" wide solid oak edge	2901.00
	banding all 4 sides with vertical slats	
MA-6624-DF-O	End panel 66" high x 24" deep, 1 1/4" thick x 1 3/4" wide solid oak edge	2943.00
	banding all 4 sides with vertical slats	
MA-6625-DF-O	End panel 66" high x 25" deep, 1 1/4" thick x 1 3/4" wide solid oak edge	3093.00
	banding all 4 sides with vertical slats	
MA-6628-DF-O	End panel 66" high x 28" deep, 1 1/4" thick x 1 3/4" wide solid oak edge	3116.00
	banding all 4 sides with vertical slats	
MA-6632-DF-O	End panel 66" high x 32" deep, 1 1/4" thick x 1 3/4" wide solid oak edge	3354.00
	banding all 4 sides with vertical slats	
MA-7812-DF-O	End panel 78" high x 12" deep, 1 1/4" thick x 1 3/4" wide solid oak edge	2216.00
	banding all 4 sides with vertical slats	
MA-7813-DF-O	End panel 78" high x 13" deep, 1 1/4" thick x 1 3/4" wide solid oak edge	2357.00
	banding all 4 sides with vertical slats	
MA-7814-DF-O	End panel 78" high x 14" deep, 1 1/4" thick x 1 3/4" wide solid oak edge	2418.00
	banding all 4 sides with vertical slats	
MA-7816-DF-O	End panel 78" high x 16" deep, 1 1/4" thick x 1 3/4" wide solid oak edge	2478.00
	banding all 4 sides with vertical slats	
MA-7818-DF-O	End panel 78" high x 18" deep, 1 1/4" thick x 1 3/4" wide solid oak edge	2516.00
	banding all 4 sides with vertical slats	
MA-7820-DF-O	End panel 78" high x 20" deep, 1 1/4" thick x 1 3/4" wide solid oak edge	2553.00
	banding all 4 sides with vertical slats	
MA-7822-DF-O	End panel 78" high x 22" deep, 1 1/4" thick x 1 3/4" wide solid oak edge	2829.00
	banding all 4 sides with vertical slats	
MA-7824-DF-O	End panel 78" high x 24" deep, 1 1/4" thick x 1 3/4" wide solid oak edge	2898.00
	banding all 4 sides with vertical slats	

MISIÓN

END PANELS WITH VERTICAL SLATS IN OAK

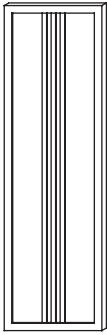

MODEL NUMBER	DESCRIPTION	LIST PRICE
MA-7825-DF-O	End panel 78" high x 25" deep, 1 1/4" thick x 1 3/4" wide solid oak edge banding on all 4 sides with vertical slats	2736.00
MA-7828-DF-O	End panel 78" high x 28" deep, 1 1/4" thick x 1 3/4" wide solid oak edge banding on all 4 sides with vertical slats	2772.00
MA-7832-DF-O	End panel 78" high x 32" deep, 1 1/4" thick x 1 3/4" wide solid oak edge banding on all 4 sides with vertical slats	3104.00
MA-8412-DF-O	End panel 84" high x 12" deep, 1 1/4" thick x 1 3/4" wide solid oak edge banding on all 4 sides with vertical slats	2163.00
MA-8413-DF-O	End panel 84" high x 13" deep, 1 1/4" thick x 1 3/4" wide solid oak edge banding on all 4 sides with vertical slats	2315.00
MA-8414-DF-O	End panel 84" high x 14" deep, 1 1/4" thick x 1 3/4" wide solid oak edge banding on all 4 sides with vertical slats	2331.00
MA-8416-DF-O	End panel 84" high x 16" deep, 1 1/4" thick x 1 3/4" wide solid oak edge banding on all 4 sides with vertical slats	2484.00
MA-8418-DF-O	End panel 84" high x 18" deep, 1 1/4" thick x 1 3/4" wide solid oak edge banding on all 4 sides with vertical slats	2519.00
MA-8420-DF-O	End panel 84" high x 20" deep, 1 1/4" thick x 1 3/4" wide solid oak edge banding on all 4 sides with vertical slats	2556.00
MA-8422-DF-O	End panel 84" high x 22" deep, 1 1/4" thick x 1 3/4" wide solid oak edge banding on all 4 sides with vertical slats	2861.00
MA-8424-DF-O	End panel 84" high x 24" deep, 1 1/4" thick x 1 3/4" wide solid oak edge banding on all 4 edges with vertical slats	2877.00
MA-8425-DF-O	End panel 84" high x 25" deep, 1 1/4" thick x 1 3/4" wide solid oak edge banding on all 4 edges with vertical slats	3140.00
MA-8428-DF-O	End panel 84" high x 28" deep, 1 1/4" thick x 1 3/4" wide solid oak edge banding on all 4 edges with vertical slats	3176.00

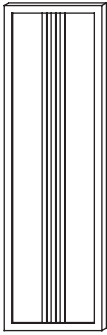

MISIÓN

END PANELS WITH VERTICAL SLATS IN OAK

MODEL NUMBER	DESCRIPTION	LIST PRICE
MA-8432-DF-O	End panel 84" high x 32" deep, 1 1/4" thick x 1 3/4" wide solid oak edge	3326.00
	banding on all 4 sides with vertical slats	
MA-9012-DF-O	End panel 90" high x 12" deep, 1 1/4" thick x 1 3/4" wide solid oak edge	2246.00
	banding on all 4 sides with vertical slats	
MA-9013-DF-O	End panel 90" high x 13" deep, 1 1/4" thick x 1 3/4" wide solid oak edge	2310.00
	banding on all 4 sides with vertical slats	
MA-9014-DF-O	End panel 90" high x 14" deep, 1 1/4" thick x 1 3/4" wide solid oak edge	2489.00
	banding on all 4 sides with vertical slats	
MA-9016-DF-O	End panel 90" high x 16" deep, 1 1/4" thick x 1 3/4" wide solid oak edge	2484.00
	banding on all 4 sides with vertical slats	
MA-9018-DF-O	End panel 90" high x 18" deep, 1 1/4" thick x 1 3/4" wide solid oak edge	2519.00
	banding on all 4 sides with vertical slats	
MA-9020-DF-O	End panel 90" high x 20" deep, 1 1/4" thick x 1 3/4" wide solid oak edge	2556.00
	banding on all 4 sides with vertical slats	
MA-9022-DF-O	End panel 90" high x 22" deep, 1 1/4" thick x 1 3/4" wide solid oak edge	2861.00
	banding on all 4 sides with vertical slats	
MA-9024-DF-O	End panel 90" high x 24" deep, 1 1/4" thick x 1 3/4" wide solid oak edge	2877.00
	banding on all 4 sides with vertical slats	
MA-9025-DF-O	End panel 90" high x 25" deep, 1 1/4" thick x 1 3/4" wide solid oak edge	3140.00
	banding on all 4 sides with vertical slats	
MA-9028-DF-O	End panel 90" high x 28" deep, 1 1/4" thick x 1 3/4" wide solid oak edge	3176.00
	banding on all 4 sides with vertical slats	
MA-9032-DF-O	End panel 90" high x 32" deep, 1 1/4" thick x 1 3/4" wide solid oak edge	3326.00
	banding on all 4 sides with vertical slats	

MISIÓN

END PANELS WITH VERTICAL SLATS IN OAK

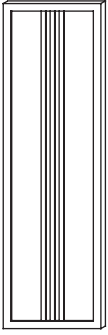

SUFFIX-M	For maple end panels change suffix O to M and add 7 percent
SUFFIX-C	For cherry end panels change suffix O to C and contact factory for upcharge.