



Revolution Products

CLASSICS LIBRARY FURNITURE 2026 PRICE LIST



Revolution Products
259 Whip O Will Drive
Clinton, SC 29325
864-547-5727

CLASSICS

Welcome to CLASSICS from Revolution Products.

Index

| | | |
|-------|--|------------|
| I. | Terms and Conditions | |
| II. | CLASSICS Leg Style Reading Tables | Pgs. 4-6 |
| III. | CLASSICS IT Tables Leg Style | Pgs. 7-8 |
| IV. | CLASSICS Reading Tables ~ Slatted End Frames | Pgs. 9-11 |
| V. | CLASSICS IT Tables ~ Slatted End Frame | Pg. 12-13 |
| VI. | CLASSICS IT Workstations with adjustable height work surfaces | Pg. 14-15 |
| VII. | CLASSICS Carrels | Pg. 16-18 |
| VIII. | CLASSICS End Panels | Pgs. 19-25 |

CLASSICS

TERMS OF SALE: All prices are FOB Clinton, SC. Net 30 days from date of shipment. All prices are list and subject to change without notice. Interest of 2% per month will be assessed on past due invoices. Possession of price list does not constitute authority to purchase or sell products herein.

TAXES: All applicable taxes are extra. If a client is tax exempt please provide tax certificate.

ORDERING: Orders must have all pertinent information provided before they will be processed and entered including model numbers, quantities and finish, laminate and fabric selections where appropriate. Please provide a requested by date, or not to ship before date on your order.

WARRANTY: All items are warranted for 10 years unless otherwise stated. Warranty is for initial purchaser and only valid as long as the product is owned by original customer. The warranty, which begins at date of manufacture, covers defects in materials and workmanship found during the normal usage of product during the warranty period. Revolution Products will at its option repair or replace the defective product with a comparable component or product. Warranty does not cover any "Customers Own Material" used in manufacture. Except as stated above, Revolution Products makes no express or implied warranties as to any product and in particular makes no warranty of fitness for any particular use. At Revolution Products option, product repair, or replacement is the customer's exclusive remedy for any and all product defects.

BIFMA AND ANSI TESTING: All products offered by Revolution Products meet or exceed applicable BIFMA and ANSI testing standards.

NEW ACCOUNTS: New Accounts can only be established with the approval of a Revolution Products representative. New accounts will be subject to special credit reference requirements and deposit terms before they are approved.

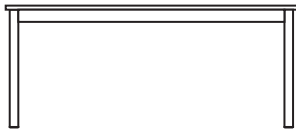

CLASSICS

READING TABLES - LEG STYLE

| MODEL NUMBER | DESCRIPTION | LIST PRICE |
|--------------|--|------------|
| CL-4272-O | Table 42" deep x 72" wide, HPL top 1 5/8" thick with 3/4" wide edge banding on all edges in oak, 2 1/2" solid oak legs with 2 1/4" aprons, legs attach to the underside of the top with metal plates and mechanical fasteners, a box keel runs the length of the table between the end aprons for added strength and support | 6492.00 |
| CL-4284-O | Table 42" deep x 84" wide, HPL top 1 5/8" thick with 3/4" wide edge banding on all edges in oak, 2 1/2" solid oak legs with 2 1/4" aprons, legs attach to the underside of the top with metal plates and mechanical fasteners, a box keel runs the length of the table between the end aprons for added strength and support | 7116.00 |
| CL-4296-O | Table 42" deep x 96" wide, HPL top 1 5/8" thick with 3/4" wide edge banding on all edges in oak, 2 1/2" solid oak legs with 2 1/4" aprons, legs attach to the underside of the top with metal plates and mechanical fasteners, a box keel runs the length of the table between the end aprons for added strength and support | 7743.00 |
| CL-4872-O | Table 48" deep x 72" wide, HPL top 1 5/8" thick with 3/4" wide edge banding on all edges in oak, 2 1/2" solid oak legs with 2 1/4" aprons, legs attach to the underside of the top with metal plates and mechanical fasteners, a box keel runs the length of the table between the end aprons for added strength and support | 6701.00 |
| CL-4884-O | Table 48" deep x 84" wide, HPL top 1 5/8" thick with 3/4" wide edge banding on all edges in oak, 2 1/2" solid oak legs with 2 1/4" aprons, legs attach to the underside of the top with metal plates and mechanical fasteners, a box keel runs the length of the table between the end aprons for added strength and support | 7328.00 |
| CL-4896-O | Table 48" deep x 96" wide, HPL top 1 5/8" thick with 3/4" wide edge banding on all edges in oak, 2 1/2" solid oak legs with 2 1/4" aprons, legs attach to the underside of the top with metal plates and mechanical fasteners, a box keel runs the length of the table between the end aprons for added strength and support | 7952.00 |

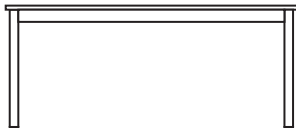

CLASSICS

READING TABLES -LEG STYLE

| MODEL NUMBER | DESCRIPTION | LIST PRICE |
|--------------|--|------------|
| CL-4242-O | Table 42" square, HPL top 1 5/8" thick with 3/4" wide oak edge banding on all edges, 2 1/2" solid oak legs, 2 1/2" high aprons, legs are attached to the top with metal plates and mechanical fasteners | 4601.00 |
| CL-4848-O | Table 48" square, HPL top 1 5/8" thick with 3/4" thick oak edge banding on all edges, 2 1/2" solid oak legs, 2 1/2" high aprons, legs are attached to the top with metal plates and mechanical fasteners | 4811.00 |
| CL-42R-O | Table 42" round, HPL top 1 5/8" thick with 3/4" thick oak edge banding, 2 1/2" square solid oak legs, 2 1/2" high aprons, legs are attached to the underside of top with metal plates and mechanical fasteners | 4811.00 |
| CL-48R-O | Table 48" round, HPL top 1 5/8" thick with 3/4" thick oak edge banding, 2 1/2" square solid oak legs, 2 1/2" high aprons, legs are attached to the underside of top with metal plates and mechanical fasteners | 5018.00 |
| SUFFIX-SW | For solid wood tops add per square foot | 129.00 |
| SUFFIX -M | For maple tables change suffix O to M and add 7 percent | |
| SUFFIX -C | For cherry tables change suffix O to C and consult factory for up charge. | |

CLASSICS

INFORMATION TECHNOLOGY TABLES WITH MONITOR RACKS LEG STYLE

| MODEL NUMBER | DESCRIPTION | LIST PRICE |
|---------------|--|------------|
| CL-3036-O-IT | IT table 30" deep x 36" wide, HPL top 1 5/8" thick with 3/4" edge banding on | 5148.00 |
| | all edges in oak, 10" high monitor rack across the back extending forward 10" on | |
| | each end, 2 1/2" solid oak legs with 2 1/4" aprons, legs attach to the | |
| | underside of the top with metal plates and mechanical fasteners, a box keel | |
| | runs the length of the table between the end aprons for added strength and | |
| | support | |
| CL-3048-O-IT | IT table 30" deep x 48" wide, HPL top 1 5/8" thick with 3/4" edge banding on | 5130.00 |
| | all edges in oak, 10" high monitor rack across the back extending forward 10" on | |
| | each end, 2 1/2" solid oak legs with 2 1/4" aprons, legs attach to the | |
| | underside of the top with metal plates and mechanical fasteners, a box keel | |
| | runs the length of the table between the end aprons for added strength and | |
| | support | |
| CL-3060-O-IT | IT table 30" deep x 60" wide, HPL top 1 5/8" thick with 3/4" edge banding on | 5691.00 |
| | all edges in oak, 10" high monitor rack across the back extending forward 10" on | |
| | each end, 2 1/2" solid oak legs with 2 1/4" aprons, legs attach to the | |
| | underside of the top with metal plates and mechanical fasteners, a box keel | |
| | runs the length of the table between the end aprons for added strength and | |
| | support | |
| CL-3072-O-IT2 | IT table 30" deep x 72" wide, HPL top 1 5/8" thick with 3/4" edge banding on | 6026.00 |
| | all edges, 10" high monitor rack across the back extending forward 10" on | |
| | each end, and 10" at the center point, dividing the table into 2 work areas, | |
| | 2 1/2" solid oak legs with 2 1/4" aprons, legs attach to the underside of the | |
| | top with metal plates and mechanical fasteners, a box keel runs the length | |
| | of the table between the end aprons for added strength and support | |
| | | |
| | | |

CLASSICS

INFORMATION TECHNOLOGY TABLES WITH MONITOR RACKS LEG STYLE

| MODEL NUMBER | DESCRIPTION | LIST PRICE |
|---------------|--|------------|
| CL-3096-O-IT2 | IT table 30" deep x 96" wide, HPL top 1 5/8" thick with 3/4" edge banding on all edges, 10" high monitor rack across the back extending forward 10" on each end, and 10" at the center point, dividing the table into 2 work areas, 2 1/2" solid oak legs with 2 1/4" aprons, legs attach to the underside of the top with metal plates and mechanical fasteners, a box keel runs the length of the table between the end aprons for added strength and support | 7215.00 |
| CL-3096-O-IT3 | IT table 30" deep x 96" wide, HPL top 1 5/8" thick with 3/4" edge banding on all edges, 10" high monitor rack across the back extending forward 10" on each end, and 10" at the 2 center points, dividing the table into 3 work areas, 2 1/2" solid oak legs with 2 1/4" aprons, legs attach to the underside of the top with metal plates and mechanical fasteners, a box keel runs the length of the table between the end aprons for added strength and support | 7277.00 |
| SUFFIX-SW | For solid wood tops add per square foot | 129.00 |
| SUFFIX -M | For maple tables change suffix O to M and add 7 percent | |
| SUFFIX -C | For cherry tables change suffix O to C and consult factory for up charge. | |

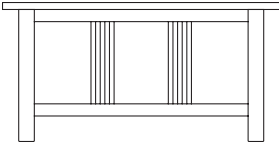

CLASSICS

READING TABLES -SLATTED END FRAME

| MODEL NUMBER | DESCRIPTION | LIST PRICE |
|--------------|--|------------|
| C-3648-O | Table 36" deep x 48" wide, HPL top 1 5/8" thick with 3/4" wide edge banding on all edges in oak, 2 end frames consisting of 2 1/2" solid oak legs, apron and stretcher 2 1/2" high X 2" thick with 6 each vertical pilasters 3/4" wide x 1 3/4" thick, aprons and stretchers are dowelled and mechanically fastened into the end frame, end frames attach to the underside of the top with metal plates, a box keel runs the length of the table between the end frames for added strength and support for the rectangular top | 6431.00 |
| C-3060-O | Table 30" deep x 60" wide, HPL top 1 5/8" thick with 3/4" wide edge banding on all edges in oak, 2 end frames consisting 2 1/2" solid oak legs, apron and stretcher 2 1/2" high X 2" thick with 6 each vertical pilasters 3/4" wide x 1 3/4" thick, aprons and stretchers are dowelled and mechanically fastened into the end frame, end frames attach to the underside of the top with metal plates, a box keel runs the length of the table between the end frames for added support | 7067.00 |
| C-3660-O | Table 36" deep x 60" wide, HPL top 1 5/8" thick with 3/4" wide edge banding on all edges in oak, 2 end frames consisting 2 1/2" solid oak legs, apron and stretcher 2 1/2" high x 2" thick with 6 each vertical pilasters 3/4" wide x 1 3/4" thick, aprons and stretchers are dowelled and mechanically fastened into the end frame, end frames attach to the underside of the top with metal plates, a box keel runs the length of the table between the end frames for added support | 7257.00 |
| C-3672-O | Table 36" deep x 72" wide, HPL top 1 5/8" thick with 3/4" wide edge banding on all edges in oak, 2 end frames consisting 2 1/2" solid oak legs, apron and stretcher 2 1/2" high x 2" thick with 6 each vertical pilasters 3/4" wide x 1 3/4" thick, aprons and stretchers are dowelled and mechanically fastened into the end frame, end frames attach to the underside of the top with metal plates, a box keel runs the length of the table between the end frames for added support | 8168.00 |
| C-3696-O | Table 36" deep x 96" wide, HPL top 1 5/8" thick with 3/4" wide edge banding on all edges in oak, 2 end frames consisting 2 1/2" solid oak legs, apron and stretcher 2 1/2" high x 2" thick with 6 each vertical pilasters 3/4" wide x 1 3/4" thick, aprons and stretchers are dowelled and mechanically fastened into the end frame, end frames attach to the underside of the top with metal plates, a box keel runs the length of the table between the end frames for added support | 8789.00 |

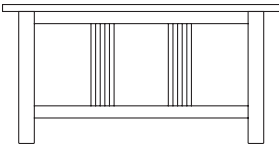

CLASSICS

READING TABLES - SLATTED END FRAME

| MODEL NUMBER | DESCRIPTION | LIST PRICE |
|--------------|--|------------|
| C-4272-O | Table 42" deep x 72" wide, HPL top 1 5/8" thick with 3/4" wide edge banding on all edges in oak, 2 end frames consisting 2 1/2" solid oak legs, apron and stretcher 2 1/2" high x 2" thick with 6 each vertical pilasters 3/4" wide x 1 3/4" thick, aprons and stretchers are dowelled and mechanically fastened into the end frame, end frames attach to the underside of the top with metal plates, a box keel runs the length of the table between the end frames for added support | 8343.00 |
| C-4284-O | Table 42" deep x 84" wide, HPL top 1 5/8" thick with 3/4" wide edge banding on all edges in oak, 2 end frames consisting 2 1/2" solid oak legs, apron and stretcher 2 1/2" high x 2" thick with 6 each vertical pilasters 3/4" wide x 1 3/4" thick, aprons and stretchers are dowelled and mechanically fastened into the end frame, end frames attach to the underside of the top with metal plates, a box keel runs the length of the table between the end frames for added support | 8849.00 |
| C-4296-O | Table 42" deep x 96" wide, HPL top 1 5/8" thick with 3/4" wide edge banding on all edges in oak, 2 end frames consisting 2 1/2" solid oak legs, apron and stretcher 2 1/2" high x 2" thick with 6 each vertical pilasters 3/4" wide x 1 3/4" thick, aprons and stretchers are dowelled and mechanically fastened into the end frame, end frames attach to the underside of the top with metal plates, a box keel runs the length of the table between the end frames for added support | 9596.00 |
| C-4872-O | Table 48" deep x 72" wide, HPL top 1 5/8" thick with 3/4" wide edge banding on all edges in oak, 2 end frames consisting 2 1/2" solid oak legs, apron and stretcher 2 1/2" high x 2" thick with 6 each vertical pilasters 3/4" wide x 1 3/4" thick, aprons and stretchers are dowelled and mechanically fastened into the end frame, end frames attach to the underside of the top with metal plates, a box keel runs the length of the table between the end frames for added support | 8598.00 |
| C-4884-O | Table 48" deep x 84" wide, HPL top 1 5/8" thick with 3/4" wide edge banding on all edges in oak, 2 end frames consisting 2 1/2" solid oak legs, apron and stretcher 2 1/2" high x 2" thick with 6 each vertical pilasters 3/4" wide x 1 3/4" thick, aprons and stretchers are dowelled and mechanically fastened into the end frame, end frames attach to the underside of the top with metal plates, a box keel runs the length of the table between the end frames for added support | 9350.00 |

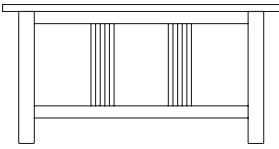

CLASSICS

READING TABLES - SLATTED END FRAME

| MODEL NUMBER | DESCRIPTION | LIST PRICE |
|--------------|---|------------|
| C-4896-O | Table 48" deep x 96" wide, HPL top 1 5/8" thick with 3/4" wide edge banding on all edges in oak, 2 end frames consisting 2 1/2" solid oak legs, apron and stretcher 2 1/2" high x 2" thick with 6 each vertical pilasters 3/4" wide x 1 3/4" thick , aprons and stretchers are dowelled and mechanically fastened into the end frame, end frames attach to the underside of the top with metal plates, a box keel runs the length of the table between the end frames for added support | 10101.00 |
| C-4242-O | Table 42" square, HPL top 1 5/8" thick with 3/4" wide oak edge banding on all edges in oak, 2 end frames consisting 2 1/2" solid oak legs, apron and stretcher 2 1/2" high x 2" thick with 6 each vertical pilasters 3/4" wide x 1 3/4" thick , aprons and stretchers are dowelled and mechanically fastened into the end frame, end frames attach to the underside of the top with metal plates, a box keel runs the length of the table between the end frames for added support | 7232.00 |
| C-4848-O | Table 48" square, HPL top 1 5/8" thick with 3/4" thick oak edge banding on all edges in oak, 2 end frames consisting 2 1/2" solid oak legs, apron and stretcher 2 1/2" high x 2" thick with 6 each vertical pilasters 3/4" wide x 1 3/4" thick , aprons and stretchers are dowelled and mechanically fastened into the end frame, end frames attach to the underside of the top with metal plates, a box keel runs the length of the table between the end frames for added support | 7481.00 |
| C-42R-O | Table 42" round, HPL top 1 5/8" thick with 3/4" thick oak edge banding, 2 1/2" edges in oak, 2 end frames consisting 2 1/2" solid oak legs, apron and stretcher 2 1/2" high x 2" thick with 6 each vertical pilasters 3/4" wide x 1 3/4" thick , aprons and stretchers are dowelled and mechanically fastened into the end frame, end frames attach to the underside of the top with metal plates, a box keel runs the length of the table between the end frames for added support | 7232.00 |
| C-48R-O | Table 48" round, HPL top 1 5/8" thick with 3/4" thick oak edge banding , 2 1/2" edges in oak, 2 end frames consisting 2 1/2" solid oak legs, apron and stretcher 2 1/2" high x 2" thick with 6 each vertical pilasters 3/4" wide x 1 3/4" thick , aprons and stretchers are dowelled and mechanically fastened into the end frame, end frames attach to the underside of the top with metal plates, a box keel runs the length of the table between the end frames for added support | 7481.00 |
| SUFFIX -M | For maple tables change suffix O to M and add 7 percent | |
| SUFFIX -C | For cherry tables change suffix O to C and consult factory for upcharge. | |

CLASSICS

INFORMATION TECHNOLOGY TABLES WITH MONITOR RACKS AND SLATTED END FRAMES

| MODEL NUMBER | DESCRIPTION | LIST PRICE |
|--------------|---|------------|
| C-3036-O-IT | IT table 30" deep x 36" wide, HPL top 1 5/8" thick with 3/4" edge banding on all edges, 10" high monitor rack across the back extending forward 10" on each end, 2 each end frames consisting of 2 1/2" solid oak legs, apron and stretcher 2 1/2" high X 2" thick with 6 each vertical pilasters 3/4" wide x 1 3/4" thick, aprons and stretchers are dowelled and mechanically fastened into the end frame, end frames attach to the underside of the top with metal plates, a box keel runs the length of the table between the end frames for added support | 7241.00 |
| C-3048-O-IT | IT table 30" deep x 48" wide, HPL top 1 5/8" thick with 3/4" edge banding on all edges, 10" high monitor rack across the back extending forward 10" on each end, 2 each end frames consisting of 2 1/2" solid oak legs, apron and stretcher 2 1/2" high X 2" thick with 6 each vertical pilasters 3/4" wide x 1 3/4" thick, aprons and stretchers are dowelled and mechanically fastened into the end frame, end frames attach to the underside of the top with metal plates, a box keel runs the length of the table between the end frames for added support | 8306.00 |
| C-3060-O-IT | IT table 30" deep x 60" wide, HPL top 1 5/8" thick with 3/4" edge banding on all edges, 10" high monitor rack across the back extending forward 10" on each end, 2 each end frames consisting of 2 1/2" solid oak legs, apron and stretcher 2 1/2" high X 2" thick with 6 each vertical pilasters 3/4" wide x 1 3/4" thick, aprons and stretchers are dowelled and mechanically fastened into the end frame, end frames attach to the underside of the top with metal plates, a box keel runs the length of the table between the end frames for added support | 8559.00 |
| C-3072-O-IT2 | IT table 30" deep x 72" wide, HPL top 1 5/8" thick with 3/4" edge banding on all edges, 10" high monitor rack across the back extending forward 10" on each end, and 10" at the center point, dividing the table into 2 work areas, 2 each end frames consisting of 2 1/2" solid oak legs, apron and stretcher 2 1/2" high X 2" thick with 6 each vertical pilasters 3/4" wide x 1 3/4" thick, aprons and stretchers are dowelled and mechanically fastened into the end frame, end frames attach to the underside of the top with metal plates, a box keel runs the length of the table between the end frames for added support | 8634.00 |

CLASSICS

INFORMATION TECHNOLOGY TABLES WITH MONITOR RACKS AND SLATTED END FRAMES

| MODEL NUMBER | DESCRIPTION | LIST PRICE |
|--------------|--|------------|
| C-3096-O-IT2 | IT table 30" deep x 96" wide, HPL top 1 5/8" thick with 3/4" edge banding on all edges, 10" high monitor rack across the back extending forward 10" on each end, and 10" at the center point, dividing the table into 2 work areas, 2 each end frames consisting of 2 1/2" solid oak legs, apron and stretcher 2 1/2" high X 2" thick with 6 each vertical pilasters 3/4" wide x 1 3/4" thick, aprons and stretchers are dowelled and mechanically fastened into the end frame, end frames attach to the underside of the top with metal plates, a box keel runs the length of the table between the end frames for added support | 10409.00 |
| C-3096-O-IT3 | IT table 30" deep x 96" wide, HPL top 1 5/8" thick with 3/4" edge banding on all edges, 10" high monitor rack across the back extending forward 10" on each end, and 10" at the 2 center points, dividing the table into 3 work areas, 2 each end frames consisting of 2 1/2" solid oak legs, apron and stretcher 2 1/2" high X 2" thick with 6 each vertical pilasters 3/4" wide x 1 3/4" thick, aprons and stretchers are dowelled and mechanically fastened into the end frame, end frames attach to the underside of the top with metal plates, a box keel runs the length of the table between the end frames for added support | 10512.00 |
| SUFFIX-SW | For solid wood tops add per square foot | 129.00 |
| SUFFIX -M | For maple tables change suffix O to M and add 7 percent | |
| SUFFIX -C | For cherry tables change suffix O to C and consult factory for up charge. | |
| C-IT-BB | Add for 1 3/4" Clear finish Butcher block top per square foot N/A in all sixes | 50.00 |
| C-IT-ADA | Add fo ADA height | 400.00 |
| C-IT-CH | Add for Counter Height | 400.00 |
| C-IT-BH | Add for Bar Height | 400.00 |
| C-IT-FTBS | Add for Front to Back Stretcher | 175.00 |
| C-IT-LHS | Add for Low Height Stretcher | 300.00 |
| C-IT-OSG | Add for Over size glides set of 4 | 35.00 |
| C-IT-CW | Add for Custom Width plus the next wider length | 225.00 |

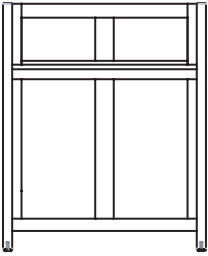

CLASSICS

SINGLE FACE INFORMATION TECHNOLOGY WORK STATIONS

| MODEL NUMBER | DESCRIPTION | LIST PRICE |
|----------------|---|------------|
| C-3136-O-ITS | IT work station starter 31" deep x 36" wide x 39" high, 1 1/4" thick end panels | 6050.00 |
| | with 3" solid oak post, 4" high top and bottom rails, 3" wide center rail with raised panel interior panels, HPL top 1 1/4" thick with 3/4" deep solid oak edge banding, back panel is 1 1/4" thick | |
| C-3136-O-ITS-A | IT work station adder 31" deep x 36" wide x 39" high, 1 1/4" thick intermediate | 4815.00 |
| | with 3" solid oak post, 4" high top and bottom rails, with flush interior panel, HPL top 1 1/4" thick with 3/4" deep solid oak edge banding, back panel is 1 1/4" thick | |
| C-3148-O-ITS | IT work station starter 31" deep x 48" wide x 39" high, 1 1/4" thick end panels | 6945.00 |
| | with 3" solid oak post, 4" high top and bottom rails, 3" wide center rail with raised panel interior panels, HPL top 1 1/4" thick with 3/4" deep solid oak edge banding, back panel is 1 1/4" thick | |
| C-3148-O-ITS-A | IT work station adder 31" deep x 48" wide x 39" high, 1 1/4" thick intermediate | 5561.00 |
| | with 3" solid oak post, 4" high top and bottom rails, with flush interior panel, HPL top 1 1/4" thick with 3/4" deep solid oak edge banding, back panel is 1 1/4" thick | |
| C-3172-O-ITS | IT work station starter 31" deep x 72" wide x 39" high, 1 1/4" thick end panels | 9536.00 |
| | with 3" solid oak post, 4" high top and bottom rails, 3" wide center rail with raised panel interior panels, HPL top 1 1/4" thick with 3/4" deep solid oak edge banding, back panel is 1 1/4" thick | |
| C-3172-O-ITS-A | IT work station adder 31" deep x 72" wide x 39" high, 1 1/8" thick intermediate | 8133.00 |
| | with 3" solid oak post, 4" high top and bottom rails, with flush interior panel, HPL top 1 1/4" thick with 3/4" deep solid oak edge banding, back panel is 1 1/4" thick | |
| | thick | |

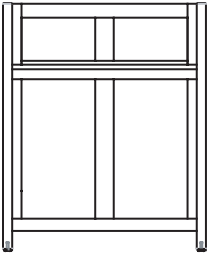

CLASSICS

DOUBLE FACE INFORMATION TECHNOLOGY WORK STATIONS

| MODEL NUMBER | DESCRIPTION | LIST PRICE |
|-----------------|---|------------|
| C-3136-O-ITDF | Carrel work station, double faced, starter 61" deep x 38" wide x 39" high, | 9173.00 |
| | 1 1/4" thick end panels with 3" solid oak posts, 4" high top and bottom rails, 3" wide center rail with raised panel interior panels, 2 each HPL tops 1 1/4" thick with 3/4" deep solid oak edge banding, 1 1/4" thick back panel | |
| C-3136-O-ITDF-A | Carrel work station, double faced, adder 61" deep x 36 1/2" wide x 39" high, | 6884.00 |
| | 1 1/4" thick intermediate panel with 3" solid oak posts, 4" high top and bottom rails, with flush interior panel, 2 each HPL tops 1 1/4" thick with 3/4" deep solid oak edge banding, back panel is 1 1/4" thick | |
| C-3148-O-ITDF | Carrel work station, double faced, starter 61" deep x 50" wide x 39" high, | 9944.00 |
| | 1 1/4" thick end panels with 3" solid oak posts, 4" high top and bottom rails, 3" wide center rail with raised panel interior panels, 2 each HPL tops 1 1/4" thick with 3/4" deep solid oak edge banding, 1 1/4" thick back panel | |
| C-3148-O-ITDF-A | Carrel work station, double faced, adder 61" deep x 48 1/2" wide x 39" high, | 7658.00 |
| | 1 1/4" thick intermediate panel with 3" solid oak posts, 4" high top and bottom rails, with flush interior panel, 2 each HPL tops 1 1/4" thick with 3/4" deep solid oak edge banding, back panel is 1 1/4" thick | |
| C-3172-O-ITDF | Carrel work station, double faced, starter 61" deep x 74" wide x 39" high, | 13460.00 |
| | 1 1/4" thick end panels with 3" solid oak posts, 4" high top and bottom rails, 3" wide center rail with raised panel interior panels, 2 each HPL tops 1 1/4" thick with 3/4" deep solid oak edge banding, 1 1/4" thick back panel | |
| C-3172-O-ITDF-A | Carrel work station, double faced, adder 61" deep x 72 1/2" wide x 39" high, | 10103.00 |
| | 1 1/4" thick intermediate panel with 3" solid oak posts, 4" high top and bottom rails, with flush interior panel, 2 each HPL tops 1 1/4" thick with 3/4" deep solid oak edge banding, back panel is 1 1/4" thick | |
| SUFFIX -M | For maple tables change suffix O to M and add 7 percent | |
| SUFFIX -C | For cherry tables change suffix O to C and consult factory for up charge. | |

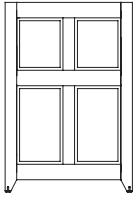

CLASSICS

SINGLE FACE STUDY CARRELS

| MODEL NUMBER | DESCRIPTION | LIST PRICE |
|--------------|---|------------|
| C-3136-O-C | Carrel work station starter 31" deep x 38" wide x 48" high, 1 1/4" thick end panels with 3" solid oak post, 4" high top and bottom rails, 3" wide center rail with raised panel interior panels, HPL top 1 1/4" thick with 3/4" deep solid oak edge banding, back panel is 1 1/4" thick | 6330.00 |
| C-3136-O-C-A | Carrel work station adder 31" deep x 36 1/2" wide x 48" high, 1 1/4" thick intermediate panel with 3" solid oak posts, 4" high top and bottom rails, with flush interior panel, HPL top 1 1/4" thick with 3/4" deep solid oak edge banding, back panel is 1 1/4" thick | 5024.00 |
| C-3150-O-C | Carrel work station starter 31" deep x 50" wide x 48" high, 1 1/4" thick end panels with 3" solid oak post, 4" high top and bottom rails, 3" wide center rail with raised panel interior panels, HPL top 1 1/4" thick with 3/4" deep solid oak edge banding, back panel is 1 1/4" thick | 7154.00 |
| C-3148-O-C-A | Carrel work station adder 31" deep x 48 1/2" wide x 48" high, 1 1/8" thick intermediate panel with 3" solid oak posts, 4" high top and bottom rails, with flush interior panel, HPL top 1 1/4" thick with 3/4" deep solid oak edge banding, back panel is 1 1/4" thick | 5769.00 |
| C-3174-O-C | Carrel work station starter 31" deep x 74" wide x 48" high, 1 1/2" thick end panels with 3" solid oak post, 4" high top and bottom rails, 3" wide center rail with raised panel interior panels, HPL top 1 1/4" thick with 3/4" deep solid oak edge banding, back panel is 1 1/4" thick | 9689.00 |
| C-3172-O-C-A | Carrel work station adder 31" deep x 72 1/2" wide x 48" high, 1 1/8" thick intermediate panel with 3" solid oak posts, 4" high top and bottom rails, with flush interior panel, HPL top 1 1/4" thick with 3/4" deep solid oak edge banding, back panel is 1 1/4" thick | 8342.00 |

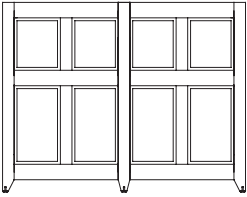

CLASSICS

DOUBLE FACE STUDY CARRELS

| MODEL NUMBER | DESCRIPTION | LIST PRICE |
|----------------|---|------------|
| C-3136-O-CDF | Carrel work station, double faced, starter 61" deep x 38" wide x 48" high, 1 1/4" thick end panel with 3" solid oak post, 4" high top and bottom rails, 3" wide center rail with raised panel interior panels, 2 each HPL tops 1 1/4" thick with 3/4" deep solid oak edge banding, back panel is 1 1/4" thick | 9333.00 |
| C-3136-O-CDF-A | Carrel work station, double faced, adder 61" deep x 36 1/2" wide x 48" high, 1 1/4" thick intermediate panel with 3" solid oak posts, 4" high top and bottom rails, with flush interior panel, 2 each HPL tops 1 1/4" thick with 3/4" deep solid oak edge banding, back panel is 1 1/4" thick | 7128.00 |
| C-3148-O-CDF | Carrel work station, double faced, starter 61" deep x 50" wide x 48" high, 1 1/4" thick end panel with 3" solid oak post, 4" high top and bottom rails, 3" wide center rail with raised panel interior panels, 2 each HPL tops 1 1/4" thick with 3/4" deep solid oak edge banding, back panel is 1 1/4" thick | 10152.00 |
| C-3148-O-CDF-A | Carrel work station, double faced, adder 61" deep x 48 1/2" wide x 48" high, 1 1/4" thick intermediate panel with 3" solid oak posts, 4" high top and bottom rails, with flush interior panel, 2 each HPL tops 1 1/4" thick with 3/4" deep solid oak edge banding, back panel is 1 1/4" thick | 7866.00 |
| C-3172-O-CDF | Carrel work station, double faced, starter 61" deep x 74" wide x 48" high, 1 1/4" thick end panel with 3" solid oak post, 4" high top and bottom rails, 3" wide center rail with raised panel interior panels, 2 each HPL tops 1 1/4" thick with 3/4" deep solid oak edge banding, back panel is 1 1/4" thick | 13668.00 |
| C-3172-O-CDF-A | Carrel work station, double faced, adder 61" deep x 72 1/2" wide x 48" high, 1 1/4" thick intermediate panel with 3" solid oak posts, 4" high top and bottom rails, with flush interior panel, HPL top 1 1/4" thick with 3/4" deep solid oak edge banding, back panel is 1 1/4" thick | 10311.00 |
| SUFFIX -M | For maple tables change suffix O to M and add 7 percent | |
| SUFFIX -C | For cherry tables change suffix O to C and consult factory for up charge. | |

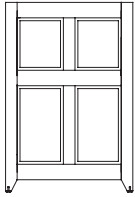

CLASSICS

HEXAGONAL CARRELS & DISPLAY UNITS

| MODEL NUMBER | DESCRIPTION | LIST PRICE |
|-----------------|---|------------|
| C-9849-O-1/2HEX | Half hexagonal OPAC station with 3 work spaces 98" x 49" with open central core for wiring access, 1 1/4" thick HPL work surfaces with 3/4" deep solid oak edge banding and 2" cord drop, 1 1/4" thick center panels, 1 1/4" thick end panels have 3" posts with 4" top and bottom rails, 3" center vertical rail and raised panel panel inserts | 14606.00 |
| C-9898-O-HEX | Hexagonal OPAC station with 6 work spaces 98" x 98" with central core for wiring access, 1 1/4" thick HPL work surfaces with 3/4" deep solid oak edge banding and 2" cord drop, 1 1/4" thick center panels, 1 1/4" thick end panels have 3" posts with 4" top and bottom rails, 3" center vertical rail and raised panel panel inserts | 25878.00 |
| C-AS-3045-O | Atlas stand with 3" posts, 4" top and bottom rails with 3" center rail and raised panel inserts, sloped top with 5 each pull out shelves | 8258.00 |
| C-DS-2445-O | Dictionary stand with 3" posts, 4" top and bottom rails, 3" vertical center rail and raised panel inserts, sloped top with base shelf and 1 adjustable shelf | 6171.00 |
| C-TI-90-DFT-O | Index table double faced, double tier 49" deep x 90" wide x 50" high, HPL top 1 1/4" thick with 1 5/8" high x 3/4" thick solid oak edge banding, 2 end frames consisting of 2 1/2" solid oak legs, apron and stretcher 2 1/2" high x 2" thick with 6 each vertical pilasters 2/4" wide x 1 3/4" thick , aprons and stretchers are dowelled and mechanically fastened into the end frame, end frames attach to the underside of the top with metal plates, a box keel runs the length of the table between the end, index rack has adjustable shelves | 10625.00 |
| C-6331-DSP-O | Display table 63 1/2" wide x 31" deep x 38 11/16" high, HPL top 1 1/4" thick with 1 5/8" high x 3/4" thick solid oak edge banding, 2 end frames consisting 2 1/2" solid oak legs, apron and stretcher 2 1/2" high x 2" thick with 6 each vertical pilasters 2/4" wide x 1 3/4" thick , aprons and stretchers are dowelled and mechanically fastened into the end frame, end frames attach to the underside of the top with metal plates, a box keel runs the length of the table between the end frames for added support, glass case to be 59" wide x 29" deep x 9 11/16" high | 12335.00 |
| | | |
| | | |

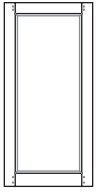

CLASSICS

END PANELS IN OAK

| MODEL NUMBER | DESCRIPTION | LIST PRICE |
|--------------|--|------------|
| C-4412-DF-O | End panel 44" high x 12" deep, 1" thick with 2 1/2" solid oak edge banding on all sides with raised panel insert | 1238.00 |
| C-4413-DF-O | End panel 44" high x 13" deep, 1" thick with 2 1/2" solid oak edge banding on all sides with raised panel insert | 1257.00 |
| C-4414-DF-O | End panel 44" high x 14" deep, 1" thick with 2 1/2" solid oak edge banding on all sides raised panel insert | 1277.00 |
| C-4416-DF-O | End panel 44" high x 16" deep, 1" thick with 2 1/2" solid oak edge banding on all sides with raised panel insert | 1296.00 |
| C-4418-DF-O | End panel 44" high x 18" deep, 1" thick with 2 1/2" solid oak edge banding on all sides raised panel insert | 1332.00 |
| C-4420-DF-O | End panel 44" high x 20" deep, 1" thick with 2 1/2" solid oak edge banding on all sides with raised panel insert | 1389.00 |
| C-4422-DF-O | End panel 44" high x 22" deep, 1" thick with 2 1/2" solid oak edge banding on all sides with raised panel insert | 1424.00 |
| C-4424-DF-O | End panel 44" high x 24" deep, 1" thick with 2 1/2" solid oak edge banding on all sides with raised panel insert | 1463.00 |
| C-4425-DF-O | End panel 44" high x 25" deep, 1" thick with 2 1/2" solid oak edge banding on all sides with raised panel insert | 1482.00 |
| C-4428-DF-O | End panel 44" high x 28" deep, 1" thick with 2 1/2" solid oak edge banding on all sides with raised panel insert | 1538.00 |
| C-4432-DF-O | End panel 44" high x 32" deep, 1" thick with 2 1/2" solid oak edge banding on all sides with raised panel insert | 1649.00 |
| C-4812-DF-O | End panel 48" high x 12" deep, 1" thick with 2 1/2" solid oak edge banding on all sides with raised panel insert | 1269.00 |
| C-4813-DF-O | End panel 48" high x 13" deep, 1" thick with 2 1/2" solid oak edge banding on all sides with raised panel insert | 1284.00 |

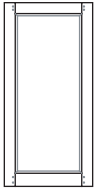

CLASSICS

END PANELS IN OAK

| MODEL NUMBER | DESCRIPTION | LIST PRICE |
|--------------|--|------------|
| C-4814-DF-O | End panel 48" high x 14" deep, 1" thick with 2 1/2" solid oak edge banding on all sides with raised panel insert | 1304.00 |
| C-4816-DF-O | End panel 48" high x 16" deep, 1" thick with 2 1/2" solid oak edge banding on all sides with raised panel insert | 1323.00 |
| C-4818-DF-O | End panel 48" high x 18" deep, 1" thick with 2 1/2" solid oak edge banding on all sides with raised panel insert | 1356.00 |
| C-4820-DF-O | End panel 48" high x 20" deep, 1" thick with 2 1/2" solid oak edge banding on all sides with raised panel insert | 1397.00 |
| C-4822-DF-O | End panel 48" high x 22" deep, 1" thick with 2 1/2" solid oak edge banding on all sides with raised panel insert | 1455.00 |
| C-4824-DF-O | End panel 48" high x 24" deep, 1" thick with 2 1/2" solid oak edge banding on all sides with raised panel insert | 1491.00 |
| C-4825-DF-O | End panel 48" high x 25" deep, 1" thick with 2 1/2" solid oak edge banding on all sides with raised panel insert | 1527.00 |
| C-4828-DF-O | End panel 48" high x 28" deep, 1" thick with 2 1/2" solid oak edge banding on all sides with raised panel insert | 1575.00 |
| C-4832-DF-O | End panel 48" high x 32" deep, 1" thick with 2 1/2" solid oak edge banding on all sides with raised panel insert | 1686.00 |
| C-5012-DF-O | End panel 50" high x 12" deep, 1" thick with 2 1/2" solid oak edge banding on all sides with raised panel insert | 1323.00 |
| C-5013-DF-O | End panel 50" high x 13" deep, 1" thick with 2 1/2" solid oak edge banding on all sides with raised panel insert | 1341.00 |
| C-5014-DF-O | End panel 50" high x 14" deep, 1" thick with 2 1/2" solid oak edge banding on all sides with raised panel insert | 1361.00 |
| C-5016-DF-O | End panel 50" high x 16" deep, 1" thick with 2 1/2" solid oak edge banding on all sides with raised panel insert | 1379.00 |

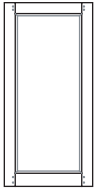

CLASSICS

END PANELS IN OAK

| MODEL NUMBER | DESCRIPTION | LIST PRICE |
|--------------|---|------------|
| C-5018-DF-O | End panel 50" high x 18" deep, 1" thick with 2 1/2" solid oak edge banding on all edges with raised panel insert | 1416.00 |
| C-5020-DF-O | End panel 50" high x 20" deep, 1" thick with 2 1/2" solid oak edge banding on all edges with raised panel insert | 1455.00 |
| C-5022-DF-O | End panel 50" high x 22" deep, 1" thick with 2 1/2" solid oak edge banding on all edges with raised panel insert | 1511.00 |
| C-5024-DF-O | End panel 50" high x 24" deep, 1" thick with 2 1/2" solid oak edge banding on all edges with raised panel insert | 1547.00 |
| C-5025-DF-O | End panel 50" high x 25" deep, 1" thick with 2 1/2" solid oak edge banding on all edges with raised panel insert | 1583.00 |
| C-5028-DF-O | End panel 50" high x 28" deep, 1" thick with 2 1/2" solid oak edge banding on all edges with raised panel insert | 1629.00 |
| C-5032-DF-O | End panel 50" high x 32" deep, 1" thick with 2 1/2" solid oak edge banding on all edges with raised panel insert | 1761.00 |
| C-6612-DF-O | End panel 66" high x 12" deep, 1" thick with 2 1/2" solid oak edge banding on all edges with horizontal rail 2 1/2" high dividing 2 raised inset panels | 1778.00 |
| C-6613-DF-O | End panel 66" high x 13" deep, 1" thick with 2 1/2" solid oak edge banding on all edges with horizontal rail 2 1/2" high dividing 2 raised inset panels | 1805.00 |
| C-6614-DF-O | End panel 66" high x 14" deep, 1" thick with 2 1/2" solid oak edge banding on all edges with horizontal rail 2 1/2" high dividing 2 raised inset panels | 1836.00 |
| C-6616-DF-O | End panel 66" high x 16" deep, 1" thick with 2 1/2" solid oak edge banding on all edges with horizontal rail 2 1/2" high dividing 2 raised inset panels | 1836.00 |
| C-6618-DF-O | End panel 66" high x 18" deep, 1" thick with 2 1/2" solid oak edge banding on all edges with horizontal rail 2 1/2" high dividing 2 raised inset panels | 1928.00 |
| C-6620-DF-O | End panel 66" high x 20" deep, 1" thick with 2 1/2" solid oak edge banding on all edges with horizontal rail 2 1/2" high dividing 2 raised inset panels | 1983.00 |

CLASSICS

END PANELS IN OAK

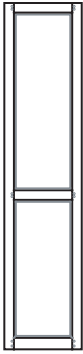

| MODEL NUMBER | DESCRIPTION | LIST PRICE |
|--------------|---|------------|
| C-6622-DF-O | End panel 66" high x 22" deep, 1" thick with 2 1/2" solid oak edge banding on all edges with horizontal rail 2 1/2" high dividing 2 raised inset panels | 1887.00 |
| C-6624-DF-O | End panel 66" high x 24" deep, 1" thick with 2 1/2" solid oak edge banding on all edges with horizontal rail 2 1/2" high dividing 2 raised inset panels | 1943.00 |
| C-6625-DF-O | End panel 66" high x 25" deep, 1" thick with 2 1/2" solid oak edge banding on all edges with horizontal rail 2 1/2" high dividing 2 raised inset panels | 2000.00 |
| C-6628-DF-O | End panel 66" high x 28" deep, 1" thick with 2 1/2" solid oak edge banding on all edges with horizontal rail 2 1/2" high dividing 2 raised inset panels | 2073.00 |
| C-6632-DF-O | End panel 66" high x 32" deep, 1" thick with 2 1/2" solid oak edge banding on all edges with horizontal rail 2 1/2" high dividing 2 raised inset panels | 2333.00 |
| C-7812-DF-O | End panel 78" high x 12" deep, 1" thick with 2 1/2" solid oak edge banding on all edges with horizontal rail 2 1/2" high dividing 2 raised inset panels | 1980.00 |
| C-7813-DF-O | End panel 78" high x 13" deep, 1" thick with 2 1/2" solid oak edge banding on all edges with horizontal rail 2 1/2" high dividing 2 raised inset panels | 2007.00 |
| C-7814-DF-O | End panel 78" high x 14" deep, 1" thick with 2 1/2" solid oak edge banding on all edges with horizontal rail 2 1/2" high dividing 2 raised inset panels | 2034.00 |
| C-7816-DF-O | End panel 78" high x 16" deep, 1" thick with 2 1/2" solid oak edge banding on all edges with horizontal rail 2 1/2" high dividing 2 raised inset panels | 2091.00 |
| C-7818-DF-O | End panel 78" high x 18" deep, 1" thick with 2 1/2" solid oak edge banding on all edges with horizontal rail 2 1/2" high dividing 2 raised inset panels | 2147.00 |
| C-7820-DF-O | End panel 78" high x 20" deep, 1" thick with 2 1/2" solid oak edge banding on all edges with horizontal rail 2 1/2" high dividing 2 raised inset panels | 2202.00 |
| C-7822-DF-O | End panel 78" high x 22" deep, 1" thick with 2 1/2" solid oak edge banding on all edges with horizontal rail 2 1/2" high dividing 2 raised inset panels | 2261.00 |
| C-7824-DF-O | End panel 78" high x 24" deep, 1" thick with 2 1/2" solid oak edge banding on all edges with horizontal rail 2 1/2" high dividing 2 raised inset panels | 2330.00 |

CLASSICS

END PANELS IN OAK

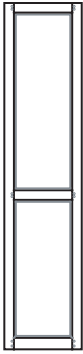

| MODEL NUMBER | DESCRIPTION | LIST PRICE |
|--------------|---|------------|
| C-7825-DF-O | End panel 78" high x 25" deep, 1" thick with 2 1/2" solid oak edge banding on all edges with horizontal rail 2 1/2" high dividing 2 raised inset panels | 2372.00 |
| C-7828-DF-O | End panel 78" high x 28" deep, 1" thick with 2 1/2" solid oak edge banding on all edges with horizontal rail 2 1/2" high dividing 2 raised inset panels | 2447.00 |
| C-7832-DF-O | End panel 78" high x 32" deep, 1" thick with 2 1/2" solid oak edge banding on all edges with horizontal rail 2 1/2" high dividing 2 raised inset panels | 2519.00 |
| C-8412-DF-O | End panel 84" high x 12" deep, 1" thick with 2 1/2" solid oak edge banding on all edges with horizontal rail 2 1/2" high dividing 2 raised inset panels | 2166.00 |
| C-8413-DF-O | End panel 84" high x 13" deep, 1" thick with 2 1/2" solid oak edge banding on all edges with horizontal rail 2 1/2" high dividing 2 raised inset panels | 2193.00 |
| C-8414-DF-O | End panel 84" high x 14" deep, 1" thick with 2 1/2" solid oak edge banding on all edges with horizontal rail 2 1/2" high dividing 2 raised inset panels | 2222.00 |
| C-8416-DF-O | End panel 84" high x 16" deep, 1" thick with 2 1/2" solid oak edge banding on all edges with horizontal rail 2 1/2" high dividing 2 raised inset panels | 2250.00 |
| C-8418-DF-O | End panel 84" high x 18" deep, 1" thick with 2 1/2" solid oak edge banding on all edges with horizontal rail 2 1/2" high dividing 2 raised inset panels | 2288.00 |
| C-8420-DF-O | End panel 84" high x 20" deep, 1" thick with 2 1/2" solid oak edge banding on all edges with horizontal rail 2 1/2" high dividing 2 raised inset panels | 2325.00 |
| C-8422-DF-O | End panel 84" high x 22" deep, 1" thick with 2 1/2" solid oak edge banding on all edges with horizontal rail 2 1/2" high dividing 2 raised inset panels | 2361.00 |
| C-8424-DF-O | End panel 84" high x 24" deep, 1" thick with 2 1/2" solid oak edge banding on all edges with horizontal rail 2 1/2" high dividing 2 raised inset panels | 2397.00 |
| C-8425-DF-O | End panel 84" high x 25" deep, 1" thick with 2 1/2" solid oak edge banding on all edges with horizontal rail 2 1/2" high dividing 2 raised inset panels | 2427.00 |
| C-8428-DF-O | End panel 84" high x 28" deep, 1" thick with 2 1/2" solid oak edge banding on all edges with horizontal rail 2 1/2" high dividing 2 raised inset panels | 2502.00 |

CLASSICS

END PANELS IN OAK

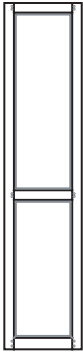

| MODEL NUMBER | DESCRIPTION | LIST PRICE |
|--------------|---|------------|
| C-8432-DF-O | End panel 84" high x 32" deep, 1" thick with 2 1/2" solid oak edge banding on all edges with horizontal rail 2 1/2" high dividing 2 raised inset panels | 2592.00 |
| C-9012-DF-O | End panel 90" high x 12" deep, 1" thick with 2 1/2" solid oak edge banding on all edges with horizontal rail 2 1/2" high dividing 2 raised inset panels | 2118.00 |
| C-9013-DF-O | End panel 90" high x 13" deep, 1" thick with 2 1/2" solid oak edge banding on all edges with horizontal rail 2 1/2" high dividing 2 raised inset panels | 2154.00 |
| C-9014-DF-O | End panel 90" high x 14" deep, 1" thick with 2 1/2" solid oak edge banding on all edges with horizontal rail 2 1/2" high dividing 2 raised inset panels | 2190.00 |
| C-9016-DF-O | End panel 90" high x 16" deep, 1" thick with 2 1/2" solid oak edge banding on all edges with horizontal rail 2 1/2" high dividing 2 raised inset panels | 2229.00 |
| C-9018-DF-O | End panel 90" high x 18" deep, 1" thick with 2 1/2" solid oak edge banding on all edges with horizontal rail 2 1/2" high dividing 2 raised inset panels | 2285.00 |
| C-9020-DF-O | End panel 90" high x 20" deep, 1" thick with 2 1/2" solid oak edge banding on all edges with horizontal rail 2 1/2" high dividing 2 raised inset panels | 2309.00 |
| C-9022-DF-O | End panel 90" high x 22" deep, 1" thick with 2 1/2" solid oak edge banding on all edges with horizontal rail 2 1/2" high dividing 2 raised inset panels | 2396.00 |
| C-9024-DF-O | End panel 90" high x 24" deep, 1" thick with 2 1/2" solid oak edge banding on all edges with horizontal rail 2 1/2" high dividing 2 raised inset panels | 2453.00 |
| C-9025-DF-O | End panel 90" high x 25" deep, 1" thick with 2 1/2" solid oak edge banding on all edges with horizontal rail 2 1/2" high dividing 2 raised inset panels | 2480.00 |
| C-9028-DF-O | End panel 90" high x 28" deep, 1" thick with 2 1/2" solid oak edge banding on all edges with horizontal rail 2 1/2" high dividing 2 raised inset panels | 2555.00 |
| C-9032-DF-O | End panel 90" high x 32" deep, 1" thick with 2 1/2" solid oak edge banding on all edges with horizontal rail 2 1/2" high dividing 2 raised inset panels | 2630.00 |

CLASSICS

END PANELS IN OAK

| | |
|----------|--|
| SUFFIX-M | For maple end panels change suffix O to M and add 7 percent |
| | |
| SUFFIX-C | For cherry end panels change suffix O to C and contact factory |

