



Revolution Products

MISIÓN LIBRARY FURNITURE

2024 PRICE LIST

EFFECTIVE JUNE 1ST 2023, PLEASE ADD 17% TO ALL LIST PRICES IN THIS CATALOG.



Revolution Products
259 Whip O Will Drive
Clinton, SC29325
864-201-1357

MISIÓN

Welcome to **MISIÓN** from Revolution Products. Based in the Arts and Crafts movement of furniture **MISIÓN** will compliment any architectural setting.

Effective July 1st 2021, please add 7% to all list prices in this catalog.

Index

- | | | |
|-------|---|------------|
| I. | Terms and Conditions | |
| II. | MISION Reading Tables | Pgs. 4-6 |
| III. | MISION IT Tables with monitor racks | Pgs. 7-8 |
| IV. | MISION IT Workstations with adjustable height work surfaces | Pgs. 9-10 |
| V. | MISION Single Face & Hexagonal Study Carrels | Pg. 11 |
| VI. | MISION Double Face Study Carrels | Pg. 12 |
| VII. | MISION Display Units | Pg. 13 |
| VIII. | MISION End Panels | Pgs. 14-27 |

MISIÓN

TERMS OF SALE: All prices are FOB Clinton, SC. Net 30 days from date of shipment. All prices are list and subject to change without notice. Interest of 2% per month will be assessed on past due invoices. Possession of price list does not constitute authority to purchase or sell products herein.

TAXES: All applicable taxes are extra. If a client is tax exempt please provide tax certificate.

ORDERING: Orders must have all pertinent information provided before they will be processed and entered including model numbers, quantities and finish, laminate and fabric selections where appropriate. Please provide a requested by date, or not to ship before date on your order.

WARRANTY: All items are warranted for 10 years unless otherwise stated. Warranty is for initial purchaser and only valid as long as the product is owned by original customer. The warranty, which begins at date of manufacture, covers defects in materials and workmanship found during the normal usage of product during the warranty period. Revolution Products will at its option repair or replace the defective product with a comparable component or product. Warranty does not cover any "Customers Own Material" used in manufacture. Except as stated above, Revolution Products makes no express or implied warranties as to any product and in particular makes no warranty of fitness for any particular use. At Revolution Products option, product repair, or replacement is the customer's exclusive remedy for any and all product defects.

BIFMA AND ANSI TESTING: All products offered by Revolution Products meet or exceed applicable BIFMA and ANSI testing standards.

NEW ACCOUNTS: New Accounts can only be established with the approval of a Revolution Products representative. New accounts will be subject to special credit reference requirements and deposit terms before they are approved.

MISIÓN

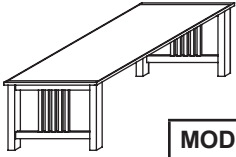

READING TABLES

MODEL NUMBER	DESCRIPTION	LIST PRICE
M-3648-O	Table 36" deep x 48" wide, HPL top 1 1/4" thick with 3/4" wide x 1 5/8" high drop	3424.00
	edge banding on all edges in oak, 2 end frames consisting of 2 1/2" solid oak	
	legs, apron and stretcher 2 1/2" high X 1 1/4" thick with 5 each vertical pilasters	
	1 7/8" wide x 3/4" thick, a ladder keel and metal leg plates add structural support	
	to the table	
M-3060-O	Table 30" deep x 60" wide, HPL top 1 1/4" thick with 3/4" wide x 1 5/8" high drop	3540.00
	edge banding on all edges in oak, 2 end frames consisting of 2 1/2" solid oak	
	legs, apron and stretcher 2 1/2" high X 1 1/4" thick with 5 each vertical pilasters	
	1 7/8" wide x 3/4" thick, a ladder keel and metal leg plates add structural support	
	to the table	
M-3660-O	Table 36" deep x 60" wide, HPL top 1 1/4" thick with 3/4" wide x 1 5/8" high drop	3595.00
	edge banding on all edges in oak, 2 end frames consisting of 2 1/2" solid oak	
	legs, apron and stretcher 2 1/2" high X 1 1/4" thick with 5 each vertical pilasters	
	1 7/8" wide x 3/4" thick, a ladder keel and metal leg plates add structural support	
	to the table	
M-3672-O	Table 36" deep x 72" wide, HPL top 1 1/4" thick with 3/4" wide x 1 5/8" high drop	3781.00
	edge banding on all edges in oak, 2 end frames consisting of 2 1/2" solid oak	
	legs, apron and stretcher 2 1/2" high X 1 1/4" thick with 5 each vertical pilasters	
	1 7/8" wide x 3/4" thick, a ladder keel and metal leg plates add structural support	
	to the table	
M-3696-O	Table 36" deep x 96" wide, HPL top 1 1/4" thick with 2 5/8" wide edge banding on	4537.00
	ends and 1/2" deep edge banding on long edges in oak, 2 end frames consisting	
	of 2 1/2" solid oak legs, apron and stretcher 2 1/2" high X 1 1/4" thick with 5 each	
	vertical pilasters 1 7/8" wide x 3/4" thick, a ladder keel and metal leg plates and structure	
	to the table	

MISIÓN

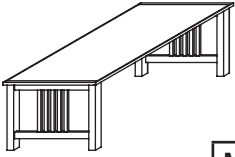

READING TABLES

MODEL NUMBER	DESCRIPTION	LIST PRICE
M-4272-O	Table 42" deep x 72" wide, HPL top 1 1/4" thick with 3/4" wide x 1 5/8" high drop edge banding on all edges in oak, 2 end frames consisting of 2 1/2" solid oak legs, apron and stretcher 2 1/2" high X 1 1/4" thick with 5 each vertical pilasters 1 7/8" wide x 3/4" thick, a ladder keel and metal leg plates add structural support to the table	4385.00
M-4284-O	Table 42" deep x 84" wide, HPL top 1 1/4" thick with 3/4" wide x 1 5/8" high drop edge banding on all edges in oak, 2 end frames consisting of 2 1/2" solid oak legs, apron and stretcher 2 1/2" high X 1 1/4" thick with 5 each vertical pilasters 1 7/8" wide x 3/4" thick, a ladder keel and metal leg plates add structural support to the table	4600.00
M-4296-O	Table 42" deep x 96" wide, HPL top 1 1/4" thick with 3/4" wide x 1 5/8" high drop edge banding on all edges in oak, 2 end frames consisting of 2 1/2" solid oak legs, apron and stretcher 2 1/2" high X 1 1/4" thick with 5 each vertical pilasters 1 7/8" wide x 3/4" thick, a ladder keel and metal leg plates add structural support to the table	4636.00
M-4872-O	Table 48" deep x 72" wide, HPL top 1 1/4" thick with 3/4" wide x 1 5/8" high drop edge banding on all edges in oak, 2 end frames consisting of 2 1/2" solid oak legs, apron and stretcher 2 1/2" high X 1 1/4" thick with 5 each vertical pilasters 1 7/8" wide x 3/4" thick, a ladder keel and metal leg plates add structural support to the table	4499.00
M-4884-O	Table 48" deep x 84" wide, HPL top 1 1/4" thick with 3/4" wide x 1 5/8" high drop edge banding on all edges in oak, 2 end frames consisting of 2 1/2" solid oak legs, apron and stretcher 2 1/2" high X 1 1/4" thick with 5 each vertical pilasters 1 7/8" wide x 3/4" thick, a ladder keel and metal leg plates add structural support to the table	4653.00

MISIÓN

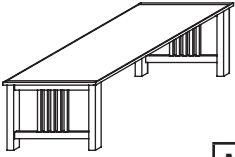

READING TABLES

MODEL NUMBER	DESCRIPTION	LIST PRICE
M-4896-O	Table 48" deep x 96" wide, HPL top 1 1/4" thick with 3/4" wide x 1 5/8" high drop edge banding on all edges in oak, 2 end frames consisting of 2 1/2" solid oak legs, apron and stretcher 2 1/2" high X 1 1/4" thick with 5 each vertical pilasters 1 7/8" wide x 3/4" thick, a ladder keel and metal leg plates add structural support to the table	4706.00
M-4242-O	Table 42" square, HPL top 1 1/4" thick with 3/4" wide x 1 5/8" deep drop edge banding on all edges, 2 1/2" solid oak legs, 2 1/2" high x 1 1/4" thick aprons	2699.00
M-4848-O	Table 48" square, HPL top 1 1/4" thick with 3/4" wide x 1 5/8" deep drop edge banding on all edges, 2 1/2" solid oak legs, 2 1/2" high x 1 1/4" thick aprons	2913.00
M-42R-O	Table 42" round, HPL top 1 1/4" thick with 3/4" wide x 1 5/8" deep drop edge banding on all edges, 2 1/2" square solid oak legs, 2 1/2" high aprons	2699.00
M-48R-O	Table 48" round, HPL top 1 1/4" thick with 3/4" wide x 1 5/8" deep drop edge banding on all edges, 2 1/2" square solid oak legs, 2 1/2" high aprons	3015.00
SUFFIX -M	For maple tables change suffix O to M and add 7 percent	
SUFFIX-C	For cherry tables change suffix O to C an consult factory for upcharge.	

MISIÓN

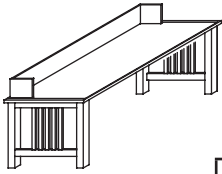

INFORMATION TECHNOLOGY TABLES WITH MONITOR RACKS

MODEL NUMBER	DESCRIPTION	LIST PRICE
M-3036-O-IT	IT table 30" deep x 36" wide, HPL top 1 1/4" thick with 3/4" wide x 1 5/8" high	6343.00
	drop edge banding on all edges in oak, 10" high monitor rack across the back	
	extending forward 10" on each end, 2 each end frames consisting of 2 1/2" solid	
	oak legs, apron and stretcher 2 1/2" high X 1 1/4" thick with 5 each vertical	
	pilasters 1 7/8" wide x 3/4" thick, a ladder keel and metal leg plates add	
	structural support to the table	
M-3048-O-IT	IT table 30" deep x 48" wide, HPL top 1 1/4" thick with 3/4" wide x 1 5/8" high	6154.00
	drop edge banding on all edges in oak, 10" high monitor rack across the back	
	extending forward 10" on each end, 2 each end frames consisting of 2 1/2" solid	
	oak legs, apron and stretcher 2 1/2" high X 1 1/4" thick with 5 each vertical	
	pilasters 1 7/8" wide x 3/4" thick, a ladder keel and metal leg plates add	
	structural support to the table	
M-3060-O-IT	IT table 30" deep x 60" wide, HPL top 1 1/4" thick with 3/4" wide x 1 5/8" high	6367.00
	drop edge banding on all edges in oak, 10" high monitor rack across the back	
	extending forward 10" on each end, 2 each end frames consisting of 2 1/2" solid	
	oak legs, apron and stretcher 2 1/2" high X 1 1/4" thick with 5 each vertical	
	pilasters 1 7/8" wide x 3/4" thick, a ladder keel and metal leg plates add	
	structural support to the table	
M-3072-O-IT2	IT table 30" deep x 72" wide, HPL top 1 1/4" thick with 3/4" wide x 1 5/8" high	6431.00
	drop edge banding on all edges in oak, 10" high monitor rack across the back	
	extending forward 10" on each end, and 10" at the center point, dividing	
	the table top into 2 separate work areas, 2 each end frames consisting of 2 1/2"	
	solid oak legs, apron and stretcher 2 1/2" high X 1 1/4" thick with 5 each	
	vertical pilasters 1 7/8" wide x 3/4" thick, a ladder keel and metal leg plates add	
	structural support to the table	

MISIÓN

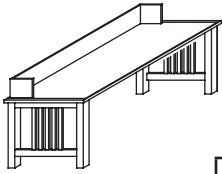

INFORMATION TECHNOLOGY TABLES WITH MONITOR RACKS

MODEL NUMBER	DESCRIPTION	LIST PRICE
M-3096-O-IT2	IT table 30" deep x 96" wide, HPL top 1 1/4" thick with 3/4" wide x 1 5/8" high	6343.00
	drop edge banding on all edges in oak, 10" high monitor rack across the back	
	extending forward 10" on each end, and 10" at the center point, dividing	
	the table top into 2 separate work areas, 2 each end frames consisting of 2 1/2"	
	solid oak legs, apron and stretcher 2 1/2" high X 1 1/4" thick with 5 each	
	vertical pilasters 1 7/8" wide x 3/4" thick, a ladder keel and metal leg plates add	
	structural support to the table	
M-3096-O-IT3	IT table 30" deep x 96" wide, HPL top 1 1/4" thick with 3/4" wide x 1 5/8" high	6412.00
	drop edges banding on all edges in oak, 10" high monitor rack across the back	
	extending forward 10" on each end, and 10" at two points point, dividing	
	the table top into 3 separate work areas, 2 each end frames consisting of 2 1/2"	
	solid oak legs, apron and stretcher 2 1/2" high X 1 1/4" thick with 5 each	
	vertical pilasters 1 7/8" wide x 3/4" thick, a ladder keel and metal leg plates add	
	structural support to the table	
SUFFIX -M	For maple IT tables change suffix O to M and add 7 percent	
SUFFIX -C	For cherry tables change suffix O to C an consult factory for upcharge.	

MISIÓN

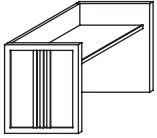

SINGLE FACE INFORMATION TECHNOLOGY WORK STATIONS WITH ADJUSTABLE HEIGHT WORK SURFACE

MODEL NUMBER	DESCRIPTION	LIST PRICE
M-3136-O-ITS	IT work station starter 31" deep x 36" wide x 39" high, 1 7/16" thick end panels	4220.00
	with 2 3/8" solid oak edge banding with vertical slats, adjustable height HPL top	
	1 1/4" thick with 3/4" deep solid oak edge banding on front edge	
M-3136-O-ITS-A	IT work station adder 31" deep x 36" wide x 39" high, 1 1/4" thick intermediate	3053.00
	panel with 1/4" solid oak edge banding, adjustable height HPL work surface	
	1 1/4" thick with 3/4" deep solid oak edge banding on front edge	
M-3148-O-ITS	IT work station starter 31" deep x 48" wide x 39" high, 1 7/16" thick end panels	4945.00
	with 2 3/8" solid oak edge banding with vertical slats, adjustable height HPL top	
	1 1/4" thick with 3/4" deep solid oak edge banding on front edge	
M-3148-O-ITS-A	IT work station adder 31" deep x 48" wide x 39" high, 1 1/4" thick intermediate	3655.00
	panel with 1/4" solid oak edge banding, adjustable height HPL work surface	
	1 1/4" thick with 3/4" deep solid oak edge banding on front edge	
M-3172-O-ITS	IT work station starter 31" deep x 72" wide x 39" high, 1 7/16" thick end panels	7041.00
	with 2 3/8" solid oak edge banding with vertical slats, adjustable height HPL top	
	1 1/4" thick with 3/4" deep solid oak edge banding on front edge and work	
	surface support	
M-3172-O-ITS-A	IT work station adder 31" deep x 72" wide x 39" high, 1 1/4" thick intermediate	5736.00
	panel with 1/4" solid oak edge banding, adjustable height HPL work surface	
	1 1/4" thick with 3/4" deep solid oak edge banding on front edge and work	
	surface support	

MISIÓN

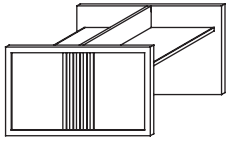

DOUBLE FACE INFORMATION TECHNOLOGY WORK STATIONS WITH ADJUSTABLE HEIGHT WORK SURFACE

MODEL NUMBER	DESCRIPTION	LIST PRICE
M-3136-O-ITDF	Carrel work station, double faced, starter 61" deep x 38" wide x 48" high,	6750.00
	1 7/16" thick end panels with 2 3/8" wide edge banding with 5 each 1 3/4" wide	
	vertical slats, 2 each 1 1/4" thick HPL work surfaces with 3/4" oak edge banding	
	on front edge	
M-3136-O-ITDF-A	Carrel work station, double faced, adder 61" deep x 36 1/2" wide x 48" high, 1 1/4" thick intermediate panel with 1/4" thick edge banding, 2 each 1 1/4" thick	4387.00
	HPL work surfaces with 3/4" thick oak edge banding on front edge	
M-3148-O-ITDF	Carrel work station, double faced, starter 61" deep x 50" wide x 48" high,	7371.00
	1 7/16" thick end panels with 2 3/8" wide edge banding with 5 each 1 3/4" wide	
	vertical slats, 2 each 1 1/4" thick HPL work surfaces with 3/4" oak edge banding	
	on front edge	
M-3148-O-ITDF-A	Carrel work station, double faced, adder 61" deep x 48 1/2" wide x 48" high, 1 1/4" thick intermediate panel with 1/4" thick edge banding, 2 each 1 1/4" thick	5014.00
	HPL work surfaces with 3/4" thick oak edge banding on front edge	
M-3172-O-ITDF	Carrel work station, double faced, starter 61" deep x 74" wide x 48" high,	9876.00
	1 7/16" thick end panels with 2 3/8" wide edge banding with 5 each 1 3/4" wide	
	vertical slats, 2 each 1 1/4" thick HPL work surfaces with 1/2" oak edge banding	
	on front edge and work surface support	
M-3172-O-ITDF-A	Carrel work station, double faced, adder 61" deep x 72 1/2" wide x 48" high, 1 1/4" thick intermediate panel with 1/4" thick edge banding, 2 each 1 1/4" thick	6992.00
	HPL work surfaces with 3/4" thick oak edge banding on front edge and work	
	surface support	
SUFFIX-M	For maple carrels change suffix O to M and add 7 percent.	
SUFFIX-C	For cherry tables change suffix O to C an consult factory for upcharge.	

MISIÓN

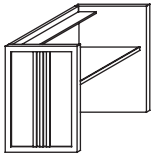

SINGLE FACE & HEXAGONAL STUDY CARRELS

MODEL NUMBER	DESCRIPTION	LIST PRICE
M-3136-O-C	Carrel work station starter 31" deep x 38" wide x 48" high, 1 7/16" thick end panels with 2 3/8" thick solid oak edge banding and 1 3/4" wide vertical slats, 1 1/4" thick HPL work surface with 3/4" deep solid oak edge banding on front edge	4387.00
M-3136-O-C-A	Carrel work station adder 31" deep x 36 1/2" wide x 48" high, 1 1/4" thick intermediate panel with 1/4" thick edge banding, 1 1/4" thick HPL work surface with 3/4" deep solid oak edge banding on front edge	2919.00
M-3150-O-C	Carrel work station starter 31" deep x 50" wide x 48" high, 1 7/16" thick end panels with 2 3/8" thick solid oak edge banding and 1 3/4" wide vertical slats, 1 1/4" thick HPL work surface with 3/4" deep solid oak edge banding on front edge	4863.00
M-3148-O-C-A	Carrel work station adder 31" deep x 48 1/2" wide x 48" high, 1 1/4" thick intermediate panel with 1/4" thick edge banding, 1 1/4" thick HPL work surface with 3/4" deep solid oak edge banding on front edge	3241.00
M-3174-O-C	Carrel work station starter 31" deep x 74" wide x 48" high, 1 7/16" thick end panels with 2 3/8" thick solid oak edge banding and 1 3/4" wide vertical slats, 1 1/4" thick HPL work surface with 3/4" deep solid oak edge banding on front edge and work surface support	6750.00
M-3172-O-C-A	Carrel work station adder 31" deep x 72 1/2" wide x 48" high, 1 1/4" thick intermediate panel with 1/4" thick edge banding, 1 1/4" thick HPL work surface with 3/4" deep solid oak edge banding on front edge and work surface support	5384.00
M-9898-O-HEX	Hexagonal OPAC station with 6 work spaces 98" x 98" with central core for wiring access, 1 1/4" thick HPL work surfaces with 3/4" deep solid oak edge banding on front edge, 1 1/4" thick divider panels with 1/4" solid oak edge banding	14855.00
M-9849-O-1/2HEX	Half hexagonal OPAC station with 3 work spaces 98" x 49" with open central core for wiring access, 1 1/4" thick HPL work surfaces with 3/4" deep solid oak edge banding on front edge, 1 1/4" thick divider panels with 1/4" solid oak edge banding	9622.00

MISIÓN

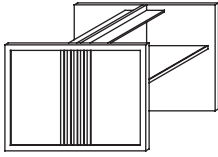

DOUBLE FACE STUDY CARRELS

MODEL NUMBER	DESCRIPTION	LIST PRICE
M-3136-O-CDF	Carrel work station, double faced, starter 61" deep x 38" wide x 48" high, 1 7/16" thick end panels with 2 3/8" wide edge banding with 5 each 1 3/4" wide vertical slats, 2 each 1 1/4" thick HPL work surfaces with 3/4" oak edge banding on front edge	6212.00
M-3136-O-CDF-A	Carrel work station, double faced, adder 61" deep x 36 1/2" wide x 48" high, 1 1/4" thick intermediate panel with 1/4" thick edge banding, 2 each 1 1/4" thick HPL work surfaces with 3/4" thick oak edge banding on front edge	3912.00
M-3148-O-CDF	Carrel work station, double faced, starter 61" deep x 50" wide x 48" high, 1 7/16" thick end panels with 2 3/8" wide edge banding with 5 each 1 3/4" wide vertical slats, 2 each 1 1/4" thick HPL work surfaces with 1/2" oak edge banding on front edge	6995.00
M-3148-O-CDF-A	Carrel work station, double faced, adder 61" deep x 48 1/2" wide x 48" high, 1 1/4" thick intermediate panel with 1/4" thick edge banding, 2 each 1 1/4" thick HPL work surfaces with 3/4" thick oak edge banding on front edge	4623.00
M-3172-O-CDF	Carrel work station, double faced, starter 61" deep x 74" wide x 48" high, 1 7/16" thick end panels with 2 3/8" wide edge banding with 5 each 1 3/4" wide vertical slats, 2 each 1 1/4" thick HPL work surfaces with 3/4" oak edge banding on front edge and work surface support	9606.00
M-3172-O-CDF-A	Carrel work station, double faced, adder 61" deep x 72 1/2" wide x 48" high, 1 1/4" thick intermediate panel with 1/4" thick edge banding, 2 each 1 1/4" thick HPL work surfaces with 3/4" thick oak edge banding on front edge and work surface support	6991.00
SUFFIX-M	For maple carrels change suffix O to M and add 7 percent.	
SUFFIX-C	For cherry tables change suffix O to C an consult factory for upcharge.	

MISIÓN

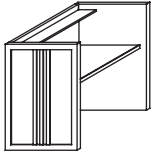

DISPLAY UNITS

MODEL NUMBER	DESCRIPTION	LIST PRICE
M-AS-3045-O	Atlas stand with 2 3/8" edge banding on end panels with vertical slats with 5 each pull out shelves	5374.00
M-DS-2445-O	Dictionary stand with 2 3/8" edge banding on end panels with vertical slats with base shelf and 1 adjustable shelf	4336.00
M-TI-72-DFT-O	Index table double faced, double tier 49" deep x 72" wide x 50" high, HPL top 1 1/4" thick with 3/4" wide x 1 5/8" high drop edge banding on all edges, 2 each end frames consisting of 2 1/2" solid oak legs, 2 1/2" high apron and stretcher with 5 each vertical pilasters 1 7/8" wide x 3/4" thick, double tier index rack with removable shelves, a ladder keel and metal leg plates for structural support	6336.00
M-TI-90-DFT-O	Index table double faced, double tier 49" deep x 90" wide x 50" high, HPL top 1 1/4" thick with 3/4" wide x 1 5/8" high drop edge banding on all edges, 2 each end frames consisting of 2 1/2" solid oak legs, 2 1/2" high apron and stretcher with 5 each vertical pilasters 1 7/8" wide x 3/4" thick, double tier index rack with removable shelves, a ladder keel and metal leg plates for structural support	7919.00
M-6331-DSP-O	Display table 63 1/2" wide x 31" deep x 38 11/16" high, HPL top 1 1/4" thick with 3/4" wide x 1 5/8" high drop edge banding on all edges, 2 each end frames consisting of 2 1/2" solid oak legs, 2 1/2" high apron and stretcher with 5 each vertical pilasters 1 7/8" wide x 3/4" thick, a ladder keel and metal leg plates for structural support glass case to be 59" wide x 29" deep x 9 11/16" high	9473.00
SUFFIX-M	For maple display products change suffix O to M and add 7 percent	
SUFFIX-C	For cherry tables change suffix O to C an consult factory for upcharge.	

MISIÓN

END PANELS IN OAK

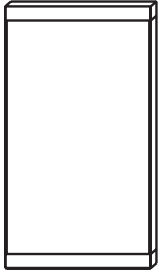

MODEL NUMBER	DESCRIPTION	LIST PRICE
M-4412-DF-O	End panel 44" high x 12" deep, 1 1/8" thick with 2 3/8" solid oak edge banding at top and bottom with 1/4" thick solid oak edge banding on vertical edges	725.00
M-4413-DF-O	End panel 44" high x 13" deep, 1 1/8" thick with 2 3/8" solid oak edge banding at top and bottom with 1/4" thick solid oak edge banding on vertical edges	751.00
M-4414-DF-O	End panel 44" high x 14" deep, 1 1/8" thick with 2 3/8" solid oak edge banding at top and bottom with 1/4" thick solid oak edge banding on vertical edges	755.00
M-4416-DF-O	End panel 44" high x 16" deep, 1 1/8" thick with 2 3/8" solid oak edge banding at top and bottom with 1/4" thick solid oak edge banding on vertical edges	802.00
M-4418-DF-O	End panel 44" high x 18" deep, 1 1/8" thick with 2 3/8" solid oak edge banding at top and bottom with 1/4" thick solid oak edge banding on vertical edges	821.00
M-4420-DF-O	End panel 44" high x 20" deep, 1 1/8" thick with 2 3/8" solid oak edge banding at top and bottom with 1/4" thick solid oak edge banding on vertical edges	837.00
M-4422-DF-O	End panel 44" high x 22" deep, 1 1/8" thick with 2 3/8" solid oak edge banding at top and bottom with 1/4" thick solid oak edge banding on vertical edges	959.00
M-4424-DF-O	End panel 44" high x 24" deep, 1 1/8" thick with 2 3/8" solid oak edge banding at top and bottom with 1/4" thick solid oak edge banding on vertical edges	976.00
M-4425-DF-O	End panel 44" high x 25" deep, 1 1/8" thick with 2 3/8" solid oak edge banding at top and bottom with 1/4" thick solid oak edge banding on vertical edges	1038.00
M-4428-DF-O	End panel 44" high x 28" deep, 1 1/8" thick with 2 3/8" solid oak edge banding at top and bottom with 1/4" thick solid oak edge banding on vertical edges	1043.00
M-4432-DF-O	End panel 44" high x 32" deep, 1 1/8" thick with 2 3/8" solid oak edge banding at top and bottom with 1/4" thick solid oak edge banding on vertical edges	1217.00
M-4812-DF-O	End panel 48" high x 12" deep, 1 1/8" thick with 2 3/8" solid oak edge banding at top and bottom with 1/4" thick solid oak edge banding on vertical edges	725.00
M-4813-DF-O	End panel 48" high x 13" deep, 1 1/8" thick with 2 3/8" solid oak edge banding at top and bottom with 1/4" thick solid oak edge banding on vertical edges	751.00

MISIÓN

END PANELS IN OAK

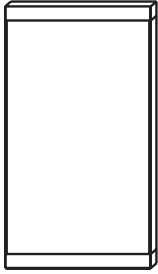

MODEL NUMBER	DESCRIPTION	LIST PRICE
M-4814-DF-O	End panel 48" high x 14" deep, 1 1/8" thick with 2 3/8" solid oak edge banding at top and bottom with 1/4" thick solid oak edge banding on vertical edges	755.00
M-4816-DF-O	End panel 48" high x 16" deep, 1 1/8" thick with 2 3/8" solid oak edge banding at top and bottom with 1/4" thick solid oak edge banding on vertical edges	802.00
M-4818-DF-O	End panel 48" high x 18" deep, 1 1/8" thick with 2 3/8" solid oak edge banding at top and bottom with 1/4" thick solid oak edge banding on vertical edges	821.00
M-4820-DF-O	End panel 48" high x 20" deep, 1 1/8" thick with 2 3/8" solid oak edge banding at top and bottom with 1/4" thick solid oak edge banding on vertical edges	837.00
M-4822-DF-O	End panel 48" high x 22" deep, 1 1/8" thick with 2 3/8" solid oak edge banding at top and bottom with 1/4" thick solid oak edge banding on vertical edges	959.00
M-4824-DF-O	End panel 48" high x 24" deep, 1 1/8" thick with 2 3/8" solid oak edge banding at top and bottom with 1/4" thick solid oak edge banding on vertical edges	976.00
M-4825-DF-O	End panel 48" high x 25" deep, 1 1/8" thick with 2 3/8" solid oak edge banding at top and bottom with 1/4" thick solid oak edge banding on vertical edges	1038.00
M-4828-DF-O	End panel 48" high x 28" deep, 1 1/8" thick with 2 3/8" solid oak edge banding at top and bottom with 1/4" thick solid oak edge banding on vertical edges	1043.00
M-4832-DF-O	End panel 48" high x 32" deep, 1 1/8" thick with 2 3/8" solid oak edge banding at top and bottom with 1/4" thick solid oak edge banding on vertical edges	1216.00
M-5012-DF-O	End panel 50" high x 12" deep, 1 1/8" thick with 2 3/8" solid oak edge banding at top and bottom with 1/4" thick solid oak edge banding on vertical edges	774.00
M-5013-DF-O	End panel 50" high x 13" deep, 1 1/8" thick with 2 3/8" solid oak edge banding at top and bottom with 1/4" thick solid oak edge banding on vertical edges	807.00
M-5014-DF-O	End panel 50" high x 14" deep, 1 1/8" thick with 2 3/8" solid oak edge banding at top and bottom with 1/4" thick solid oak edge banding on vertical edges	824.00
M-5016-DF-O	End panel 50" high x 16" deep, 1 1/8" thick with 2 3/8" solid oak edge banding at top and bottom with 1/4" thick solid oak edge banding on vertical edges	853.00

MISIÓN

END PANELS IN OAK

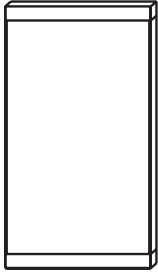

MODEL NUMBER	DESCRIPTION	LIST PRICE
M-5018-DF-O	End panel 50" high x 18" deep, 1 1/8" thick with 2 3/8" solid oak edge banding at top and bottom with 1/4" thick solid oak edge banding on vertical edges	806.00
M-5020-DF-O	End panel 50" high x 20" deep, 1 1/8" thick with 2 3/8" solid oak edge banding at top and bottom with 1/4" thick solid oak edge banding on vertical edges	822.00
M-5022-DF-O	End panel 50" high x 22" deep, 1 1/8" thick with 2 3/8" solid oak edge banding at top and bottom with 1/4" thick solid oak edge banding on vertical edges	934.00
M-5024-DF-O	End panel 50" high x 24" deep, 1 1/8" thick with 2 3/8" solid oak edge banding at top and bottom with 1/4" thick solid oak edge banding on vertical edges	952.00
M-5025-DF-O	End panel 50" high x 25" deep, 1 1/8" thick with 2 3/8" solid oak edge banding at top and bottom with 1/4" thick solid oak edge banding on vertical edges	1008.00
M-5028-DF-O	End panel 50" high x 28" deep, 1 1/8" thick with 2 3/8" solid oak edge banding at top and bottom with 1/4" thick solid oak edge banding on vertical edges	1014.00
M-5032-DF-O	End panel 50" high x 32" deep, 1 1/8" thick with 2 3/8" solid oak edge banding at top and bottom with 1/4" thick solid oak edge banding on vertical edges	1173.00
M-6612-DF-O	End panel 66" high x 12" deep, 1 1/8" thick with 2 3/8" solid oak edge banding at top and bottom with 1/4" thick solid oak edge banding on vertical edges	753.00
M-6613-DF-O	End panel 66" high x 13" deep, 1 1/8" thick with 2 3/8" solid oak edge banding at top and bottom with 1/4" thick solid oak edge banding on vertical edges	853.00
M-6614-DF-O	End panel 66" high x 14" deep, 1 1/8" thick with 2 3/8" solid oak edge banding at top and bottom with 1/4" thick solid oak edge banding on vertical edges	865.00
M-6616-DF-O	End panel 66" high x 16" deep, 1 1/8" thick with 2 3/8" solid oak edge banding at top and bottom with 1/4" thick solid oak edge banding on vertical edges	959.00
M-6618-DF-O	End panel 66" high x 18" deep, 1 1/8" thick with 2 3/8" solid oak edge banding at top and bottom with 1/4" thick solid oak edge banding on vertical edges	976.00
M-6620-DF-O	End panel 66" high x 20" deep, 1 1/8" thick with 2 3/8" solid oak edge banding at top and bottom with 1/4" thick solid oak edge banding on vertical edges	887.00

MISIÓN

END PANELS IN OAK

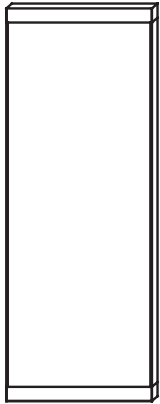

MODEL NUMBER	DESCRIPTION	LIST PRICE
M-6622-DF-O	End panel 66" high x 22" deep, 1 1/8" thick with 2 3/8" solid oak edge banding at top and bottom with 1/4" thick solid oak edge banding on vertical edges	1149.00
M-6624-DF-O	End panel 66" high x 24" deep, 1 1/8" thick with 2 3/8" solid oak edge banding at top and bottom with 1/4" thick solid oak edge banding on vertical edges	1164.00
M-6625-DF-O	End panel 66" high x 25" deep, 1 1/8" thick with 2 3/8" solid oak edge banding at top and bottom with 1/4" thick solid oak edge banding on vertical edges	1231.00
M-6628-DF-O	End panel 66" high x 28" deep, 1 1/8" thick with 2 3/8" solid oak edge banding at top and bottom with 1/4" thick solid oak edge banding on vertical edges	1243.00
M-6632-DF-O	End panel 66" high x 32" deep, 1 1/8" thick with 2 3/8" solid oak edge banding at top and bottom with 1/4" thick solid oak edge banding on vertical edges	1348.00
M-7812-DF-O	End panel 78" high x 12" deep, 1 1/8" thick with 2 3/8" solid oak edge banding at top and bottom with 1/4" thick solid oak edge banding on vertical edges	842.00
M-7813-DF-O	End panel 78" high x 13" deep, 1 1/8" thick with 2 3/8" solid oak edge banding at top and bottom with 1/4" thick solid oak edge banding on vertical edges	927.00
M-7814-DF-O	End panel 78" high x 14" deep, 1 1/8" thick with 2 3/8" solid oak edge banding at top and bottom with 1/4" thick solid oak edge banding on vertical edges	943.00
M-7816-DF-O	End panel 78" high x 16" deep, 1 1/8" thick with 2 3/8" solid oak edge banding at top and bottom with 1/4" thick solid oak edge banding on vertical edges	943.00
M-7818-DF-O	End panel 78" high x 18" deep, 1 1/8" thick with 2 3/8" solid oak edge banding at top and bottom with 1/4" thick solid oak edge banding on vertical edges	1009.00
M-7820-DF-O	End panel 78" high x 20" deep, 1 1/8" thick with 2 3/8" solid oak edge banding at top and bottom with 1/4" thick solid oak edge banding on vertical edges	1041.00
M-7822-DF-O	End panel 78" high x 22" deep, 1 1/8" thick with 2 3/8" solid oak edge banding at top and bottom with 1/4" thick solid oak edge banding on vertical edges	1162.00
M-7824-DF-O	End panel 78" high x 24" deep, 1 1/8" thick with 2 3/8" solid oak edge banding at top and bottom with 1/4" thick solid oak edge banding on vertical edges	1180.00

MISIÓN

END PANELS IN OAK



MODEL NUMBER	DESCRIPTION	LIST PRICE
M-7825-DF-O	End panel 78" high x 25" deep, 1 1/8" thick with 2 3/8" solid oak edge banding at top and bottom with 1/4" thick solid oak edge banding on vertical edges	1123.00
M-7828-DF-O	End panel 78" high x 28" deep, 1 1/8" thick with 2 3/8" solid oak edge banding at top and bottom with 1/4" thick solid oak edge banding on vertical edges	1196.00
M-7832-DF-O	End panel 78" high x 32" deep, 1 1/8" thick with 2 3/8" solid oak edge banding at top and bottom with 1/4" thick solid oak edge banding on vertical edges	1349.00
M-8412-DF-O	End panel 84" high x 12" deep, 1 1/8" thick with 2 3/8" solid oak edge banding at top and bottom with 1/4" thick solid oak edge banding on vertical edges	908.00
M-8413-DF-O	End panel 84" high x 13" deep, 1 1/8" thick with 2 3/8" solid oak edge banding at top and bottom with 1/4" thick solid oak edge banding on vertical edges	986.00
M-8414-DF-O	End panel 84" high x 14" deep, 1 1/8" thick with 2 3/8" solid oak edge banding at top and bottom with 1/4" thick solid oak edge banding on vertical edges	994.00
M-8416-DF-O	End panel 84" high x 16" deep, 1 1/8" thick with 2 3/8" solid oak edge banding at top and bottom with 1/4" thick solid oak edge banding on vertical edges	1063.00
M-8418-DF-O	End panel 84" high x 18" deep, 1 1/8" thick with 2 3/8" solid oak edge banding at top and bottom with 1/4" thick solid oak edge banding on vertical edges	1079.00
M-8420-DF-O	End panel 84" high x 20" deep, 1 1/8" thick with 2 3/8" solid oak edge banding at top and bottom with 1/4" thick solid oak edge banding on vertical edges	1098.00
M-8422-DF-O	End panel 84" high x 22" deep, 1 1/8" thick with 2 3/8" solid oak edge banding at top and bottom with 1/4" thick solid oak edge banding on vertical edges	1236.00
M-8424-DF-O	End panel 84" high x 24" deep, 1 1/8" thick with 2 3/8" solid oak edge banding at top and bottom with 1/4" thick solid oak edge banding on vertical edges	1244.00
M-8425-DF-O	End panel 84" high x 25" deep, 1 1/8" thick with 2 3/8" solid oak edge banding at top and bottom with 1/4" thick solid oak edge banding on vertical edges	1365.00
M-8428-DF-O	End panel 84" high x 28" deep, 1 1/8" thick with 2 3/8" solid oak edge banding at top and bottom with 1/4" thick solid oak edge banding on vertical edges	1380.00

MISIÓN

END PANELS IN OAK



MODEL NUMBER	DESCRIPTION	LIST PRICE
M-8432-DF-O	End panel 84" high x 32" deep, 1 1/8" thick with 2 3/8" solid oak edge banding at top and bottom with 1/4" thick solid oak edge banding on vertical edges	1450.00
M-9012-DF-O	End panel 90" high x 12" deep, 1 1/8" thick with 2 3/8" solid oak edge banding at top and bottom with 1/4" thick solid oak edge banding on vertical edges	908.00
M-9013-DF-O	End panel 90" high x 13" deep, 1 1/8" thick with 2 3/8" solid oak edge banding at top and bottom with 1/4" thick solid oak edge banding on vertical edges	985.00
M-9014-DF-O	End panel 90" high x 14" deep, 1 1/8" thick with 2 3/8" solid oak edge banding at top and bottom with 1/4" thick solid oak edge banding on vertical edges	994.00
M-9016-DF-O	End panel 90" high x 16" deep, 1 1/8" thick with 2 3/8" solid oak edge banding at top and bottom with 1/4" thick solid oak edge banding on vertical edges	1063.00
M-9018-DF-O	End panel 90" high x 18" deep, 1 1/8" thick with 2 3/8" solid oak edge banding at top and bottom with 1/4" thick solid oak edge banding on vertical edges	1081.00
M-9020-DF-O	End panel 90" high x 20" deep, 1 1/8" thick with 2 3/8" solid oak edge banding at top and bottom with 1/4" thick solid oak edge banding on vertical edges	1098.00
M-9022-DF-O	End panel 90" high x 22" deep, 1 1/8" thick with 2 3/8" solid oak edge banding at top and bottom with 1/4" thick solid oak edge banding on vertical edges	1237.00
M-9024-DF-O	End panel 90" high x 24" deep, 1 1/8" thick with 2 3/8" solid oak edge banding at top and bottom with 1/4" thick solid oak edge banding on vertical edges	1244.00
M-9025-DF-O	End panel 90" high x 25" deep, 1 1/8" thick with 2 3/8" solid oak edge banding at top and bottom with 1/4" thick solid oak edge banding on vertical edges	1364.00
M-9028-DF-O	End panel 90" high x 28" deep, 1 1/8" thick with 2 3/8" solid oak edge banding at top and bottom with 1/4" thick solid oak edge banding on vertical edges	1380.00
M-9032-DF-O	End panel 90" high x 32" deep, 1 1/8" thick with 2 3/8" solid oak edge banding at top and bottom with 1/4" thick solid oak edge banding on vertical edges	1448.00

MISIÓN

END PANELS IN OAK

SUFFIX-M	For maple end panels change suffix O to M and add 7 percent
SUFFIX-C	For cherry end panels change suffix O to C and contact factory for upcharge.

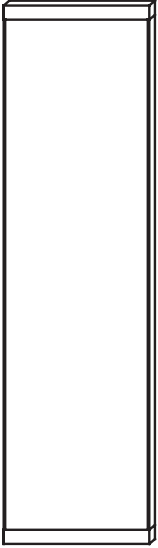

MISIÓN



END PANELS WITH VERTICAL SLATS IN OAK

MODEL NUMBER	DESCRIPTION	LIST PRICE
MA-4412-DF-O	End panel 44" high x 12" deep, 1 1/4" thick x 1 3/4" wide solid oak edge	1355.00
	banding all 4 sides with vertical slats	
MA-4413-DF-O	End panel 44" high x 13" deep, 1 1/4" thick x 1 3/4" wide solid oak edge	1382.00
	banding all 4 sides with vertical slats	
MA-4414-DF-O	End panel 44" high x 14" deep, 1 1/4" thick x 1 3/4" wide solid oak edge	1416.00
	banding all 4 sides with vertical slats	
MA-4416-DF-O	End panel 44" high x 16" deep, 1 1/4" thick x 1 3/4" wide solid oak edge	1504.00
	banding all 4 sides with vertical slats	
MA-4418-DF-O	End panel 44" high x 18" deep, 1 1/4" thick x 1 3/4" wide solid oak edge	1537.00
	banding all 4 sides with vertical slats	
MA-4420-DF-O	End panel 44" high x 20" deep, 1 1/4" thick x 1 3/4" wide solid oak edge	1567.00
	banding all 4 sides with vertical slats	
MA-4422-DF-O	End panel 44" high x 22" deep, 1 1/4" thick x 1 3/4" wide solid oak edge	1796.00
	banding all 4 sides with vertical slats	
MA-4424-DF-O	End panel 44" high x 24" deep, 1 1/4" thick x 1 3/4" wide solid oak edge	1826.00
	banding all 4 sides with vertical slats	
MA-4425-DF-O	End panel 44" high x 25" deep, 1 1/4" thick x 1 3/4" wide solid oak edge	1943.00
	banding all 4 sides with vertical slats	
MA-4428-DF-O	End panel 44" high x 28" deep, 1 1/4" thick x 1 3/4" wide solid oak edge	1956.00
	banding all 4 sides with vertical slats	
MA-4432-DF-O	End panel 44" high x 32" deep, 1 1/4" thick x 1 3/4" wide solid oak edge	2274.00
	banding all 4 sides with vertical slats	
MA-4812-DF-O	End panel 48" high x 12" deep, 1 1/4" thick x 1 3/4" wide solid oak edge	1356.00
	banding all 4 sides with vertical slats	
MA-4813-DF-O	End panel 48" high x 13" deep, 1 1/4" thick x 1 3/4" wide solid oak edge	1408.00
	banding all 4 sides with vertical slats	

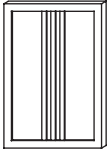

MISIÓN

END PANELS WITH VERTICAL SLATS IN OAK

MODEL NUMBER	DESCRIPTION	LIST PRICE
MA-4814-DF-O	End panel 48" high x 14" deep, 1 1/4" thick x 1 3/4" wide solid oak edge	1198.00
	banding all 4 sides with vertical slats	
MA-4816-DF-O	End panel 48" high x 16" deep, 1 1/4" thick x 1 3/4" wide solid oak edge	1268.00
	banding all 4 sides with vertical slats	
MA-4818-DF-O	End panel 48" high x 18" deep, 1 1/4" thick x 1 3/4" wide solid oak edge	1294.00
	banding all 4 sides with vertical slats	
MA-4820-DF-O	End panel 48" high x 20" deep, 1 1/4" thick x 1 3/4" wide solid oak edge	1319.00
	banding all 4 sides with vertical slats	
MA-4822-DF-O	End panel 48" high x 22" deep, 1 1/4" thick x 1 3/4" wide solid oak edge	1501.00
	banding all 4 sides with vertical slats	
MA-4824-DF-O	End panel 48" high x 24" deep, 1 1/4" thick x 1 3/4" wide solid oak edge	1527.00
	banding all 4 sides with vertical slats	
MA-4825-DF-O	End panel 48" high x 25" deep, 1 1/4" thick x 1 3/4" wide solid oak edge	1641.00
	banding all 4 sides with vertical slats	
MA-4828-DF-O	End panel 48" high x 28" deep, 1 1/4" thick x 1 3/4" wide solid oak edge	1641.00
	banding all 4 sides with vertical slats	
MA-4832-DF-O	End panel 48" high x 32" deep, 1 1/4" thick x 1 3/4" wide solid oak edge	1895.00
	banding all 4 sides with vertical slats	
MA-5012-DF-O	End panel 50" high x 12" deep, 1 1/4" thick x 1 3/4" wide solid oak edge	1225.00
	banding all 4 sides with vertical slats	
MA-5013-DF-O	End panel 50" high x 13" deep, 1 1/4" thick x 1 3/4" wide solid oak edge	1274.00
	banding all 4 sides with vertical slats	
MA-5014-DF-O	End panel 50" high x 14" deep, 1 1/4" thick x 1 3/4" wide solid oak edge	1274.00
	banding all 4 sides with vertical slats	
MA-5016-DF-O	End panel 50" high x 16" deep, 1 1/4" thick x 1 3/4" wide solid oak edge	1345.00
	banding all 4 sides with vertical slats	

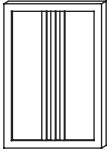

MISIÓN

END PANELS WITH VERTICAL SLATS IN OAK

MODEL NUMBER	DESCRIPTION	LIST PRICE
MA-5018-DF-O	End panel 50" high x 18" deep, 1 1/4" thick x 1 3/4" thick solid oak edge	1380.00
	banding all 4 sides and vertical slats	
MA-5020-DF-O	End panel 50" high x 20" deep, 1 1/4" thick x 1 3/4" thick solid oak edge	1405.00
	banding all 4 sides and vertical slats	
MA-5022-DF-O	End panel 50" high x 22" deep, 1 1/4" thick x 1 3/4" wide solid oak edge	1598.00
	banding all 4 sides and vertical slats	
MA-5024-DF-O	End panel 50" high x 24" deep, 1 1/4" thick x 1 3/4" wide solid oak edge	1623.00
	banding all 4 sides and vertical slats	
MA-5025-DF-O	End panel 50" high x 25" deep, 1 1/4" thick x 1 3/4" wide solid oak edge	1706.00
	banding all 4 sides and vertical slats	
MA-5028-DF-O	End panel 50" high x 28" deep, 1 1/4" thick x 1 3/4" wide solid oak edge	1717.00
	banding all 4 sides and vertical slats	
MA-5032-DF-O	End panel 50" high x 32" deep, 1 1/4" thick x 1 3/4" wide solid oak edge	1982.00
	banding all 4 sides and vertical slats	
MA-6612-DF-O	End panel 66" high x 12" deep, 1 1/4" thick x 1 3/4" wide solid oak edge	1284.00
	banding all 4 sides and vertical slats	
MA-6613-DF-O	End panel 66" high x 13" deep, 1 1/4" thick x 1 3/4" wide solid oak edge	1345.00
	banding all 4 sides and vertical slats	
MA-6614-DF-O	End panel 66" high x 14" deep, 1 1/4" thick x 1 3/4" wide solid oak edge	1414.00
	banding all 4 sides and vertical slats	
MA-6616-DF-O	End panel 66" high x 16" deep, 1 1/4" thick x 1 3/4" wide solid oak edge	1512.00
	banding all 4 sides and vertical slats	
MA-6618-DF-O	End panel 66" high x 18" deep, 1 1/4" thick x 1 3/4" wide solid oak edge	1538.00
	banding all 4 sides and vertical slats	
MA-6620-DF-O	End panel 66" high x 20" deep, 1 1/4" thick x 1 3/4" wide solid oak edge	1075.00
	banding all 4 sides and vertical slats	

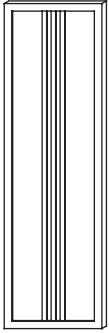

MISIÓN

END PANELS WITH VERTICAL SLATS IN OAK

MODEL NUMBER	DESCRIPTION	LIST PRICE
MA-6622-DF-O	End panel 66" high x 22" deep, 1 1/4" thick x 1 3/4" wide solid oak edge	1934.00
	banding all 4 sides with vertical slats	
MA-6624-DF-O	End panel 66" high x 24" deep, 1 1/4" thick x 1 3/4" wide solid oak edge	1962.00
	banding all 4 sides with vertical slats	
MA-6625-DF-O	End panel 66" high x 25" deep, 1 1/4" thick x 1 3/4" wide solid oak edge	2062.00
	banding all 4 sides with vertical slats	
MA-6628-DF-O	End panel 66" high x 28" deep, 1 1/4" thick x 1 3/4" wide solid oak edge	2077.00
	banding all 4 sides with vertical slats	
MA-6632-DF-O	End panel 66" high x 32" deep, 1 1/4" thick x 1 3/4" wide solid oak edge	2236.00
	banding all 4 sides with vertical slats	
MA-7812-DF-O	End panel 78" high x 12" deep, 1 1/4" thick x 1 3/4" wide solid oak edge	1477.00
	banding all 4 sides with vertical slats	
MA-7813-DF-O	End panel 78" high x 13" deep, 1 1/4" thick x 1 3/4" wide solid oak edge	1571.00
	banding all 4 sides with vertical slats	
MA-7814-DF-O	End panel 78" high x 14" deep, 1 1/4" thick x 1 3/4" wide solid oak edge	1612.00
	banding all 4 sides with vertical slats	
MA-7816-DF-O	End panel 78" high x 16" deep, 1 1/4" thick x 1 3/4" wide solid oak edge	1652.00
	banding all 4 sides with vertical slats	
MA-7818-DF-O	End panel 78" high x 18" deep, 1 1/4" thick x 1 3/4" wide solid oak edge	1677.00
	banding all 4 sides with vertical slats	
MA-7820-DF-O	End panel 78" high x 20" deep, 1 1/4" thick x 1 3/4" wide solid oak edge	1702.00
	banding all 4 sides with vertical slats	
MA-7822-DF-O	End panel 78" high x 22" deep, 1 1/4" thick x 1 3/4" wide solid oak edge	1886.00
	banding all 4 sides with vertical slats	
MA-7824-DF-O	End panel 78" high x 24" deep, 1 1/4" thick x 1 3/4" wide solid oak edge	1932.00
	banding all 4 sides with vertical slats	

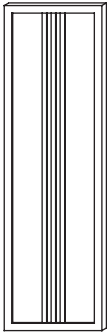

MISIÓN

END PANELS WITH VERTICAL SLATS IN OAK

MODEL NUMBER	DESCRIPTION	LIST PRICE
MA-7825-DF-O	End panel 78" high x 25" deep, 1 1/4" thick x 1 3/4" wide solid oak edge banding on all 4 sides with vertical slats	1824.00
MA-7828-DF-O	End panel 78" high x 28" deep, 1 1/4" thick x 1 3/4" wide solid oak edge banding on all 4 sides with vertical slats	1848.00
MA-7832-DF-O	End panel 78" high x 32" deep, 1 1/4" thick x 1 3/4" wide solid oak edge banding on all 4 sides with vertical slats	2069.00
MA-8412-DF-O	End panel 84" high x 12" deep, 1 1/4" thick x 1 3/4" wide solid oak edge banding on all 4 sides with vertical slats	1442.00
MA-8413-DF-O	End panel 84" high x 13" deep, 1 1/4" thick x 1 3/4" wide solid oak edge banding on all 4 sides with vertical slats	1543.00
MA-8414-DF-O	End panel 84" high x 14" deep, 1 1/4" thick x 1 3/4" wide solid oak edge banding on all 4 sides with vertical slats	1554.00
MA-8416-DF-O	End panel 84" high x 16" deep, 1 1/4" thick x 1 3/4" wide solid oak edge banding on all 4 sides with vertical slats	1656.00
MA-8418-DF-O	End panel 84" high x 18" deep, 1 1/4" thick x 1 3/4" wide solid oak edge banding on all 4 sides with vertical slats	1679.00
MA-8420-DF-O	End panel 84" high x 20" deep, 1 1/4" thick x 1 3/4" wide solid oak edge banding on all 4 sides with vertical slats	1704.00
MA-8422-DF-O	End panel 84" high x 22" deep, 1 1/4" thick x 1 3/4" wide solid oak edge banding on all 4 sides with vertical slats	1907.00
MA-8424-DF-O	End panel 84" high x 24" deep, 1 1/4" thick x 1 3/4" wide solid oak edge banding on all 4 edges with vertical slats	1918.00
MA-8425-DF-O	End panel 84" high x 25" deep, 1 1/4" thick x 1 3/4" wide solid oak edge banding on all 4 edges with vertical slats	2093.00
MA-8428-DF-O	End panel 84" high x 28" deep, 1 1/4" thick x 1 3/4" wide solid oak edge banding on all 4 edges with vertical slats	2117.00

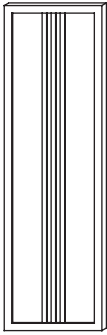

MISIÓN

END PANELS WITH VERTICAL SLATS IN OAK

MODEL NUMBER	DESCRIPTION	LIST PRICE
MA-8432-DF-O	End panel 84" high x 32" deep, 1 1/4" thick x 1 3/4" wide solid oak edge	2217.00
	banding on all 4 sides with vertical slats	
MA-9012-DF-O	End panel 90" high x 12" deep, 1 1/4" thick x 1 3/4" wide solid oak edge	1497.00
	banding on all 4 sides with vertical slats	
MA-9013-DF-O	End panel 90" high x 13" deep, 1 1/4" thick x 1 3/4" wide solid oak edge	1540.00
	banding on all 4 sides with vertical slats	
MA-9014-DF-O	End panel 90" high x 14" deep, 1 1/4" thick x 1 3/4" wide solid oak edge	1659.00
	banding on all 4 sides with vertical slats	
MA-9016-DF-O	End panel 90" high x 16" deep, 1 1/4" thick x 1 3/4" wide solid oak edge	1656.00
	banding on all 4 sides with vertical slats	
MA-9018-DF-O	End panel 90" high x 18" deep, 1 1/4" thick x 1 3/4" wide solid oak edge	1679.00
	banding on all 4 sides with vertical slats	
MA-9020-DF-O	End panel 90" high x 20" deep, 1 1/4" thick x 1 3/4" wide solid oak edge	1704.00
	banding on all 4 sides with vertical slats	
MA-9022-DF-O	End panel 90" high x 22" deep, 1 1/4" thick x 1 3/4" wide solid oak edge	1907.00
	banding on all 4 sides with vertical slats	
MA-9024-DF-O	End panel 90" high x 24" deep, 1 1/4" thick x 1 3/4" wide solid oak edge	1918.00
	banding on all 4 sides with vertical slats	
MA-9025-DF-O	End panel 90" high x 25" deep, 1 1/4" thick x 1 3/4" wide solid oak edge	2093.00
	banding on all 4 sides with vertical slats	
MA-9028-DF-O	End panel 90" high x 28" deep, 1 1/4" thick x 1 3/4" wide solid oak edge	2117.00
	banding on all 4 sides with vertical slats	
MA-9032-DF-O	End panel 90" high x 32" deep, 1 1/4" thick x 1 3/4" wide solid oak edge	2217.00
	banding on all 4 sides with vertical slats	

MISIÓN

END PANELS WITH VERTICAL SLATS IN OAK

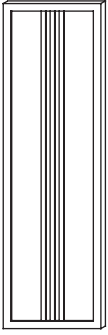

SUFFIX-M	For maple end panels change suffix O to M and add 7 percent
SUFFIX-C	For cherry end panels change suffix O to C and contact factory for upcharge.