



Revolution Products

CLASSICS LIBRARY FURNITURE 2024 PRICE LIST

EFFECTIVE JUNE 1ST 2023, PLEASE ADD 17% TO ALL LIST PRICES IN THIS CATALOG.



Revolution Products
259 Whip O Will Drive
Clinton, SC 29325
800-241-9810

CLASSICS

Welcome to CLASSICS from Revolution Products.
Effective July 1st 2021, please add 7% to all list prices in this catalog.

Index

- | | | |
|-------|--|------------|
| I. | Terms and Conditions | |
| II. | CLASSICS Leg Style Reading Tables | Pgs. 4-6 |
| III. | CLASSICS IT Tables Leg Style | Pgs. 7-8 |
| IV. | CLASSICS Reading Tables ~ Slatted End Frames | Pgs. 9-11 |
| V. | CLASSICS IT Tables ~ Slatted End Frame | Pg. 12-13 |
| VI. | CLASSICS IT Workstations with adjustable
height work surfaces | Pg. 14-15 |
| VII. | CLASSICS Carrels | Pg. 16-18 |
| VIII. | CLASSICS End Panels | Pgs. 19-25 |

CLASSICS

TERMS OF SALE: All prices are FOB Clinton, SC. Net 30 days from date of shipment. All prices are list and subject to change without notice. Interest of 2% per month will be assessed on past due invoices. Possession of price list does not constitute authority to purchase or sell products herein.

TAXES: All applicable taxes are extra. If a client is tax exempt please provide tax certificate.

ORDERING: Orders must have all pertinent information provided before they will be processed and entered including model numbers, quantities and finish, laminate and fabric selections where appropriate. Please provide a requested by date, or not to ship before date on your order.

WARRANTY: All items are warranted for 10 years unless otherwise stated. Warranty is for initial purchaser and only valid as long as the product is owned by original customer. The warranty, which begins at date of manufacture, covers defects in materials and workmanship found during the normal usage of product during the warranty period. Revolution Products will at its option repair or replace the defective product with a comparable component or product. Warranty does not cover any "Customers Own Material" used in manufacture. Except as stated above, Revolution Products makes no express or implied warranties as to any product and in particular makes no warranty of fitness for any particular use. At Revolution Products option, product repair, or replacement is the customer's exclusive remedy for any and all product defects.

BIFMA AND ANSI TESTING: All products offered by Revolution Products meet or exceed applicable BIFMA and ANSI testing standards.

NEW ACCOUNTS: New Accounts can only be established with the approval of a Revolution Products representative. New accounts will be subject to special credit reference requirements and deposit terms before they are approved.

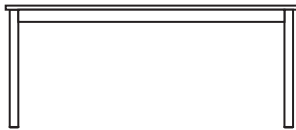

CLASSICS

READING TABLES - LEG STYLE

MODEL NUMBER	DESCRIPTION	LIST PRICE
CL-4272-O	Table 42" deep x 72" wide, HPL top 1 5/8" thick with 3/4" wide edge banding on all edges in oak, 2 1/2" solid oak legs with 2 1/4" aprons, legs attach to the underside of the top with metal plates and mechanical fasteners, a box keel runs the length of the table between the end aprons for added strength and support	4328.00
CL-4284-O	Table 42" deep x 84" wide, HPL top 1 5/8" thick with 3/4" wide edge banding on all edges in oak, 2 1/2" solid oak legs with 2 1/4" aprons, legs attach to the underside of the top with metal plates and mechanical fasteners, a box keel runs the length of the table between the end aprons for added strength and support	4744.00
CL-4296-O	Table 42" deep x 96" wide, HPL top 1 5/8" thick with 3/4" wide edge banding on all edges in oak, 2 1/2" solid oak legs with 2 1/4" aprons, legs attach to the underside of the top with metal plates and mechanical fasteners, a box keel runs the length of the table between the end aprons for added strength and support	5162.00
CL-4872-O	Table 48" deep x 72" wide, HPL top 1 5/8" thick with 3/4" wide edge banding on all edges in oak, 2 1/2" solid oak legs with 2 1/4" aprons, legs attach to the underside of the top with metal plates and mechanical fasteners, a box keel runs the length of the table between the end aprons for added strength and support	4467.00
CL-4884-O	Table 48" deep x 84" wide, HPL top 1 5/8" thick with 3/4" wide edge banding on all edges in oak, 2 1/2" solid oak legs with 2 1/4" aprons, legs attach to the underside of the top with metal plates and mechanical fasteners, a box keel runs the length of the table between the end aprons for added strength and support	4885.00
CL-4896-O	Table 48" deep x 96" wide, HPL top 1 5/8" thick with 3/4" wide edge banding on all edges in oak, 2 1/2" solid oak legs with 2 1/4" aprons, legs attach to the underside of the top with metal plates and mechanical fasteners, a box keel runs the length of the table between the end aprons for added strength and support	5301.00

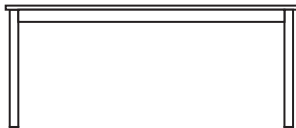

CLASSICS

READING TABLES -LEG STYLE

MODEL NUMBER	DESCRIPTION	LIST PRICE
CL-4242-O	Table 42" square, HPL top 1 5/8" thick with 3/4" wide oak edge banding on all edges, 2 1/2" solid oak legs, 2 1/2" high aprons, legs are attached to the top with metal plates and mechanical fasteners	3067.00
CL-4848-O	Table 48" square, HPL top 1 5/8" thick with 3/4" thick oak edge banding on all edges, 2 1/2" solid oak legs, 2 1/2" high aprons, legs are attached to the top with metal plates and mechanical fasteners	3207.00
CL-42R-O	Table 42" round, HPL top 1 5/8" thick with 3/4" thick oak edge banding, 2 1/2" square solid oak legs, 2 1/2" high aprons, legs are attached to the underside of top with metal plates and mechanical fasteners	3207.00
CL-48R-O	Table 48" round, HPL top 1 5/8" thick with 3/4" thick oak edge banding, 2 1/2" square solid oak legs, 2 1/2" high aprons, legs are attached to the underside of top with metal plates and mechanical fasteners	3345.00
SUFFIX-SW	For solid wood tops add \$86.00 per square foot.	
SUFFIX -M	For maple tables change suffix O to M and add 7 percent	
SUFFIX -C	For cherry tables change suffix O to C and consult factory for up charge.	

CLASSICS

INFORMATION TECHNOLOGY TABLES WITH MONITOR RACKS LEG STYLE

MODEL NUMBER	DESCRIPTION	LIST PRICE
CL-3036-O-IT	IT table 30" deep x 36" wide, HPL top 1 5/8" thick with 3/4" edge banding on	3432.00
	all edges in oak, 10" high monitor rack across the back extending forward 10" on	
	each end, 2 1/2" solid oak legs with 2 1/4" aprons, legs attach to the	
	underside of the top with metal plates and mechanical fasteners, a box keel	
	runs the length of the table between the end aprons for added strength and	
	support	
CL-3048-O-IT	IT table 30" deep x 48" wide, HPL top 1 5/8" thick with 3/4" edge banding on	3420.00
	all edges in oak, 10" high monitor rack across the back extending forward 10" on	
	each end, 2 1/2" solid oak legs with 2 1/4" aprons, legs attach to the	
	underside of the top with metal plates and mechanical fasteners, a box keel	
	runs the length of the table between the end aprons for added strength and	
	support	
CL-3060-O-IT	IT table 30" deep x 60" wide, HPL top 1 5/8" thick with 3/4" edge banding on	3794.00
	all edges in oak, 10" high monitor rack across the back extending forward 10" on	
	each end, 2 1/2" solid oak legs with 2 1/4" aprons, legs attach to the	
	underside of the top with metal plates and mechanical fasteners, a box keel	
	runs the length of the table between the end aprons for added strength and	
	support	
CL-3072-O-IT2	IT table 30" deep x 72" wide, HPL top 1 5/8" thick with 3/4" edge banding on	4017.00
	all edges, 10" high monitor rack across the back extending forward 10" on	
	each end, and 10" at the center point, dividing the table into 2 work areas,	
	2 1/2" solid oak legs with 2 1/4" aprons, legs attach to the underside of the	
	top with metal plates and mechanical fasteners, a box keel runs the length	
	of the table between the end aprons for added strength and support	

CLASSICS

INFORMATION TECHNOLOGY TABLES WITH MONITOR RACKS LEG STYLE

MODEL NUMBER	DESCRIPTION	LIST PRICE
CL-3096-O-IT2	IT table 30" deep x 96" wide, HPL top 1 5/8" thick with 3/4" edge banding on all edges, 10" high monitor rack across the back extending forward 10" on each end, and 10" at the center point, dividing the table into 2 work areas, 2 1/2" solid oak legs with 2 1/4" aprons, legs attach to the underside of the top with metal plates and mechanical fasteners, a box keel runs the length of the table between the end aprons for added strength and support	4810.00
CL-3096-O-IT3	IT table 30" deep x 96" wide, HPL top 1 5/8" thick with 3/4" edge banding on all edges, 10" high monitor rack across the back extending forward 10" on each end, and 10" at the 2 center points, dividing the table into 3 work areas, 2 1/2" solid oak legs with 2 1/4" aprons, legs attach to the underside of the top with metal plates and mechanical fasteners, a box keel runs the length of the table between the end aprons for added strength and support	4851.00
SUFFIX-SW	For solid wood tops add \$86.00 per square foot.	
SUFFIX -M	For maple tables change suffix O to M and add 7 percent	
SUFFIX -C	For cherry tables change suffix O to C and consult factory for up charge.	

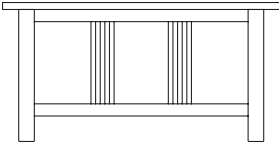

CLASSICS

READING TABLES -SLATTED END FRAME

MODEL NUMBER	DESCRIPTION	LIST PRICE
C-3648-O	Table 36" deep x 48" wide, HPL top 1 5/8" thick with 3/4" wide edge banding on all edges in oak, 2 end frames consisting of 2 1/2" solid oak legs, apron and stretcher 2 1/2" high X 2" thick with 6 each vertical pilasters 3/4" wide x 1 3/4" thick, aprons and stretchers are dowelled and mechanically fastened into the end frame, end frames attach to the underside of the top with metal plates, a box keel runs the length of the table between the end frames for added strength and support for the rectangular top	4287.00
C-3060-O	Table 30" deep x 60" wide, HPL top 1 5/8" thick with 3/4" wide edge banding on all edges in oak, 2 end frames consisting 2 1/2" solid oak legs, apron and stretcher 2 1/2" high X 2" thick with 6 each vertical pilasters 3/4" wide x 1 3/4" thick, aprons and stretchers are dowelled and mechanically fastened into the end frame, end frames attach to the underside of the top with metal plates, a box keel runs the length of the table between the end frames for added support	4711.00
C-3660-O	Table 36" deep x 60" wide, HPL top 1 5/8" thick with 3/4" wide edge banding on all edges in oak, 2 end frames consisting 2 1/2" solid oak legs, apron and stretcher 2 1/2" high x 2" thick with 6 each vertical pilasters 3/4" wide x 1 3/4" thick, aprons and stretchers are dowelled and mechanically fastened into the end frame, end frames attach to the underside of the top with metal plates, a box keel runs the length of the table between the end frames for added support	4838.00
C-3672-O	Table 36" deep x 72" wide, HPL top 1 5/8" thick with 3/4" wide edge banding on all edges in oak, 2 end frames consisting 2 1/2" solid oak legs, apron and stretcher 2 1/2" high x 2" thick with 6 each vertical pilasters 3/4" wide x 1 3/4" thick, aprons and stretchers are dowelled and mechanically fastened into the end frame, end frames attach to the underside of the top with metal plates, a box keel runs the length of the table between the end frames for added support	5445.00
C-3696-O	Table 36" deep x 96" wide, HPL top 1 5/8" thick with 3/4" wide edge banding on all edges in oak, 2 end frames consisting 2 1/2" solid oak legs, apron and stretcher 2 1/2" high x 2" thick with 6 each vertical pilasters 3/4" wide x 1 3/4" thick, aprons and stretchers are dowelled and mechanically fastened into the end frame, end frames attach to the underside of the top with metal plates, a box keel runs the length of the table between the end frames for added support	5859.00

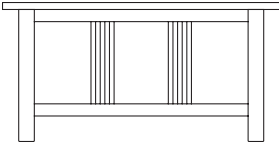

CLASSICS

READING TABLES - SLATTED END FRAME

MODEL NUMBER	DESCRIPTION	LIST PRICE
C-4272-O	Table 42" deep x 72" wide, HPL top 1 5/8" thick with 3/4" wide edge banding on all edges in oak, 2 end frames consisting 2 1/2" solid oak legs, apron and stretcher 2 1/2" high x 2" thick with 6 each vertical pilasters 3/4" wide x 1 3/4" thick , aprons and stretchers are dowelled and mechanically fastened into the end frame, end frames attach to the underside of the top with metal plates, a box keel runs the length of the table between the end frames for added support	5562.00
C-4284-O	Table 42" deep x 84" wide, HPL top 1 5/8" thick with 3/4" wide edge banding on all edges in oak, 2 end frames consisting 2 1/2" solid oak legs, apron and stretcher 2 1/2" high x 2" thick with 6 each vertical pilasters 3/4" wide x 1 3/4" thick , aprons and stretchers are dowelled and mechanically fastened into the end frame, end frames attach to the underside of the top with metal plates, a box keel runs the length of the table between the end frames for added support	5899.00
C-4296-O	Table 42" deep x 96" wide, HPL top 1 5/8" thick with 3/4" wide edge banding on all edges in oak, 2 end frames consisting 2 1/2" solid oak legs, apron and stretcher 2 1/2" high x 2" thick with 6 each vertical pilasters 3/4" wide x 1 3/4" thick , aprons and stretchers are dowelled and mechanically fastened into the end frame, end frames attach to the underside of the top with metal plates, a box keel runs the length of the table between the end frames for added support	6397.00
C-4872-O	Table 48" deep x 72" wide, HPL top 1 5/8" thick with 3/4" wide edge banding on all edges in oak, 2 end frames consisting 2 1/2" solid oak legs, apron and stretcher 2 1/2" high x 2" thick with 6 each vertical pilasters 3/4" wide x 1 3/4" thick , aprons and stretchers are dowelled and mechanically fastened into the end frame, end frames attach to the underside of the top with metal plates, a box keel runs the length of the table between the end frames for added support	5732.00
C-4884-O	Table 48" deep x 84" wide, HPL top 1 5/8" thick with 3/4" wide edge banding on all edges in oak, 2 end frames consisting 2 1/2" solid oak legs, apron and stretcher 2 1/2" high x 2" thick with 6 each vertical pilasters 3/4" wide x 1 3/4" thick , aprons and stretchers are dowelled and mechanically fastened into the end frame, end frames attach to the underside of the top with metal plates, a box keel runs the length of the table between the end frames for added support	6233.00

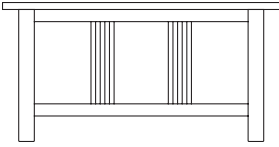

CLASSICS

READING TABLES - SLATTED END FRAME

MODEL NUMBER	DESCRIPTION	LIST PRICE
C-4896-O	Table 48" deep x 96" wide, HPL top 1 5/8" thick with 3/4" wide edge banding on all edges in oak, 2 end frames consisting 2 1/2" solid oak legs, apron and stretcher 2 1/2" high x 2" thick with 6 each vertical pilasters 3/4" wide x 1 3/4" thick , aprons and stretchers are dowelled and mechanically fastened into the end frame, end frames attach to the underside of the top with metal plates, a box keel runs the length of the table between the end frames for added support	6734.00
C-4242-O	Table 42" square, HPL top 1 5/8" thick with 3/4" wide oak edge banding on all edges in oak, 2 end frames consisting 2 1/2" solid oak legs, apron and stretcher 2 1/2" high x 2" thick with 6 each vertical pilasters 3/4" wide x 1 3/4" thick , aprons and stretchers are dowelled and mechanically fastened into the end frame, end frames attach to the underside of the top with metal plates, a box keel runs the length of the table between the end frames for added support	4821.00
C-4848-O	Table 48" square, HPL top 1 5/8" thick with 3/4" thick oak edge banding on all edges in oak, 2 end frames consisting 2 1/2" solid oak legs, apron and stretcher 2 1/2" high x 2" thick with 6 each vertical pilasters 3/4" wide x 1 3/4" thick , aprons and stretchers are dowelled and mechanically fastened into the end frame, end frames attach to the underside of the top with metal plates, a box keel runs the length of the table between the end frames for added support	4987.00
C-42R-O	Table 42" round, HPL top 1 5/8" thick with 3/4" thick oak edge banding, 2 1/2" edges in oak, 2 end frames consisting 2 1/2" solid oak legs, apron and stretcher 2 1/2" high x 2" thick with 6 each vertical pilasters 3/4" wide x 1 3/4" thick , aprons and stretchers are dowelled and mechanically fastened into the end frame, end frames attach to the underside of the top with metal plates, a box keel runs the length of the table between the end frames for added support	4821.00
C-48R-O	Table 48" round, HPL top 1 5/8" thick with 3/4" thick oak edge banding , 2 1/2" edges in oak, 2 end frames consisting 2 1/2" solid oak legs, apron and stretcher 2 1/2" high x 2" thick with 6 each vertical pilasters 3/4" wide x 1 3/4" thick , aprons and stretchers are dowelled and mechanically fastened into the end frame, end frames attach to the underside of the top with metal plates, a box keel runs the length of the table between the end frames for added support	4987.00
SUFFIX -M	For maple tables change suffix O to M and add 7 percent	
SUFFIX -C	For cherry tables change suffix O to C and consult factory for upcharge.	



CLASSICS

INFORMATION TECHNOLOGY TABLES WITH MONITOR RACKS AND SLATTED END FRAMES

MODEL NUMBER	DESCRIPTION	LIST PRICE
C-3036-O-IT	IT table 30" deep x 36" wide, HPL top 1 5/8" thick with 3/4" edge banding on all edges, 10" high monitor rack across the back extending forward 10" on each end, 2 each end frames consisting of 2 1/2" solid oak legs, apron and stretcher 2 1/2" high X 2" thick with 6 each vertical pilasters 3/4" wide x 1 3/4" thick, aprons and stretchers are dowelled and mechanically fastened into the end frame, end frames attach to the underside of the top with metal plates, a box keel runs the length of the table between the end frames for added support	4827.00
C-3048-O-IT	IT table 30" deep x 48" wide, HPL top 1 5/8" thick with 3/4" edge banding on all edges, 10" high monitor rack across the back extending forward 10" on each end, 2 each end frames consisting of 2 1/2" solid oak legs, apron and stretcher 2 1/2" high X 2" thick with 6 each vertical pilasters 3/4" wide x 1 3/4" thick, aprons and stretchers are dowelled and mechanically fastened into the end frame, end frames attach to the underside of the top with metal plates, a box keel runs the length of the table between the end frames for added support	5537.00
C-3060-O-IT	IT table 30" deep x 60" wide, HPL top 1 5/8" thick with 3/4" edge banding on all edges, 10" high monitor rack across the back extending forward 10" on each end, 2 each end frames consisting of 2 1/2" solid oak legs, apron and stretcher 2 1/2" high X 2" thick with 6 each vertical pilasters 3/4" wide x 1 3/4" thick, aprons and stretchers are dowelled and mechanically fastened into the end frame, end frames attach to the underside of the top with metal plates, a box keel runs the length of the table between the end frames for added support	5706.00
C-3072-O-IT2	IT table 30" deep x 72" wide, HPL top 1 5/8" thick with 3/4" edge banding on all edges, 10" high monitor rack across the back extending forward 10" on each end, and 10" at the center point, dividing the table into 2 work areas, 2 each end frames consisting of 2 1/2" solid oak legs, apron and stretcher 2 1/2" high X 2" thick with 6 each vertical pilasters 3/4" wide x 1 3/4" thick, aprons and stretchers are dowelled and mechanically fastened into the end frame, end frames attach to the underside of the top with metal plates, a box keel runs the length of the table between the end frames for added support	5756.00

CLASSICS

INFORMATION TECHNOLOGY TABLES WITH MONITOR RACKS AND SLATTED END FRAMES

MODEL NUMBER	DESCRIPTION	LIST PRICE
C-3096-O-IT2	IT table 30" deep x 96" wide, HPL top 1 5/8" thick with 3/4" edge banding on all edges, 10" high monitor rack across the back extending forward 10" on each end, and 10" at the center point, dividing the table into 2 work areas, 2 each end frames consisting of 2 1/2" solid oak legs, apron and stretcher 2 1/2" high X 2" thick with 6 each vertical pilasters 3/4" wide x 1 3/4" thick, aprons and stretchers are dowelled and mechanically fastened into the end frame, end frames attach to the underside of the top with metal plates, a box keel runs the length of the table between the end frames for added support	6939.00
C-3096-O-IT3	IT table 30" deep x 96" wide, HPL top 1 5/8" thick with 3/4" edge banding on all edges, 10" high monitor rack across the back extending forward 10" on each end, and 10" at the 2 center points, dividing the table into 3 work areas, 2 each end frames consisting of 2 1/2" solid oak legs, apron and stretcher 2 1/2" high X 2" thick with 6 each vertical pilasters 3/4" wide x 1 3/4" thick, aprons and stretchers are dowelled and mechanically fastened into the end frame, end frames attach to the underside of the top with metal plates, a box keel runs the length of the table between the end frames for added support	7008.00
SUFFIX-SW	For solid wood tops add \$86.00 per square foot.	
SUFFIX -M	For maple tables change suffix O to M and add 7 percent	
SUFFIX -C	For cherry tables change suffix O to C and consult factory for up charge.	

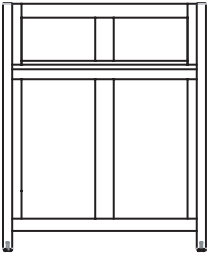

CLASSICS

SINGLE FACE INFORMATION TECHNOLOGY WORK STATIONS

MODEL NUMBER	DESCRIPTION	LIST PRICE
C-3136-O-ITS	IT work station starter 31" deep x 36" wide x 39" high, 1 1/4" thick end panels	4033.00
	with 3" solid oak post, 4" high top and bottom rails, 3" wide center rail with raised panel interior panels, HPL top 1 1/4" thick with 3/4" deep solid oak edge banding, back panel is 1 1/4" thick	
C-3136-O-ITS-A	IT work station adder 31" deep x 36" wide x 39" high, 1 1/4" thick intermediate	3210.00
	with 3" solid oak post, 4" high top and bottom rails, with flush interior panel, HPL top 1 1/4" thick with 3/4" deep solid oak edge banding, back panel is 1 1/4" thick	
C-3148-O-ITS	IT work station starter 31" deep x 48" wide x 39" high, 1 1/4" thick end panels	4630.00
	with 3" solid oak post, 4" high top and bottom rails, 3" wide center rail with raised panel interior panels, HPL top 1 1/4" thick with 3/4" deep solid oak edge banding, back panel is 1 1/4" thick	
C-3148-O-ITS-A	IT work station adder 31" deep x 48" wide x 39" high, 1 1/4" thick intermediate	3707.00
	with 3" solid oak post, 4" high top and bottom rails, with flush interior panel, HPL top 1 1/4" thick with 3/4" deep solid oak edge banding, back panel is 1 1/4" thick	
C-3172-O-ITS	IT work station starter 31" deep x 72" wide x 39" high, 1 1/4" thick end panels	6357.00
	with 3" solid oak post, 4" high top and bottom rails, 3" wide center rail with raised panel interior panels, HPL top 1 1/4" thick with 3/4" deep solid oak edge banding, back panel is 1 1/4" thick	
C-3172-O-ITS-A	IT work station adder 31" deep x 72" wide x 39" high, 1 1/8" thick intermediate	5422.00
	with 3" solid oak post, 4" high top and bottom rails, with flush interior panel, HPL top 1 1/4" thick with 3/4" deep solid oak edge banding, back panel is 1 1/4" thick	

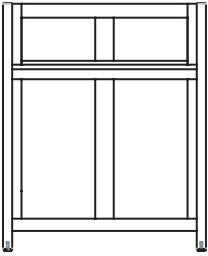

CLASSICS

DOUBLE FACE INFORMATION TECHNOLOGY WORK STATIONS

MODEL NUMBER	DESCRIPTION	LIST PRICE
C-3136-O-ITDF	Carrel work station, double faced, starter 61" deep x 38" wide x 39" high,	6115.00
	1 1/4" thick end panels with 3" solid oak posts, 4" high top and bottom rails, 3" wide center rail with raised panel interior panels, 2 each HPL tops 1 1/4" thick with 3/4" deep solid oak edge banding, 1 1/4" thick back panel	
C-3136-O-ITDF-A	Carrel work station, double faced, adder 61" deep x 36 1/2" wide x 39" high,	4589.00
	1 1/4" thick intermediate panel with 3" solid oak posts, 4" high top and bottom rails, with flush interior panel, 2 each HPL tops 1 1/4" thick with 3/4" deep solid oak edge banding, back panel is 1 1/4" thick	
C-3148-O-ITDF	Carrel work station, double faced, starter 61" deep x 50" wide x 39" high,	6629.00
	1 1/4" thick end panels with 3" solid oak posts, 4" high top and bottom rails, 3" wide center rail with raised panel interior panels, 2 each HPL tops 1 1/4" thick with 3/4" deep solid oak edge banding, 1 1/4" thick back panel	
C-3148-O-ITDF-A	Carrel work station, double faced, adder 61" deep x 48 1/2" wide x 39" high,	5105.00
	1 1/4" thick intermediate panel with 3" solid oak posts, 4" high top and bottom rails, with flush interior panel, 2 each HPL tops 1 1/4" thick with 3/4" deep solid oak edge banding, back panel is 1 1/4" thick	
C-3172-O-ITDF	Carrel work station, double faced, starter 61" deep x 74" wide x 39" high,	8973.00
	1 1/4" thick end panels with 3" solid oak posts, 4" high top and bottom rails, 3" wide center rail with raised panel interior panels, 2 each HPL tops 1 1/4" thick with 3/4" deep solid oak edge banding, 1 1/4" thick back panel	
C-3172-O-ITDF-A	Carrel work station, double faced, adder 61" deep x 72 1/2" wide x 39" high,	6735.00
	1 1/4" thick intermediate panel with 3" solid oak posts, 4" high top and bottom rails, with flush interior panel, 2 each HPL tops 1 1/4" thick with 3/4" deep solid oak edge banding, back panel is 1 1/4" thick	
SUFFIX -M	For maple tables change suffix O to M and add 7 percent	
SUFFIX -C	For cherry tables change suffix O to C and consult factory for up charge.	

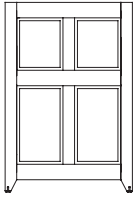

CLASSICS

SINGLE FACE STUDY CARRELS

MODEL NUMBER	DESCRIPTION	LIST PRICE
C-3136-O-C	Carrel work station starter 31" deep x 38" wide x 48" high, 1 1/4" thick end panels with 3" solid oak post, 4" high top and bottom rails, 3" wide center rail with raised panel interior panels, HPL top 1 1/4" thick with 3/4" deep solid oak edge banding, back panel is 1 1/4" thick	4220.00
C-3136-O-C-A	Carrel work station adder 31" deep x 36 1/2" wide x 48" high, 1 1/4" thick intermediate panel with 3" solid oak posts, 4" high top and bottom rails, with flush interior panel, HPL top 1 1/4" thick with 3/4" deep solid oak edge banding, back panel is 1 1/4" thick	3349.00
C-3150-O-C	Carrel work station starter 31" deep x 50" wide x 48" high, 1 1/4" thick end panels with 3" solid oak post, 4" high top and bottom rails, 3" wide center rail with raised panel interior panels, HPL top 1 1/4" thick with 3/4" deep solid oak edge banding, back panel is 1 1/4" thick	4769.00
C-3148-O-C-A	Carrel work station adder 31" deep x 48 1/2" wide x 48" high, 1 1/8" thick intermediate panel with 3" solid oak posts, 4" high top and bottom rails, with flush interior panel, HPL top 1 1/4" thick with 3/4" deep solid oak edge banding, back panel is 1 1/4" thick	3846.00
C-3174-O-C	Carrel work station starter 31" deep x 74" wide x 48" high, 1 1/2" thick end panels with 3" solid oak post, 4" high top and bottom rails, 3" wide center rail with raised panel interior panels, HPL top 1 1/4" thick with 3/4" deep solid oak edge banding, back panel is 1 1/4" thick	6459.00
C-3172-O-C-A	Carrel work station adder 31" deep x 72 1/2" wide x 48" high, 1 1/8" thick intermediate panel with 3" solid oak posts, 4" high top and bottom rails, with flush interior panel, HPL top 1 1/4" thick with 3/4" deep solid oak edge banding, back panel is 1 1/4" thick	5561.00

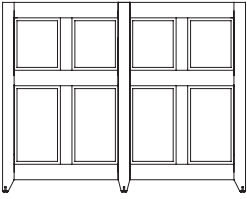

CLASSICS

DOUBLE FACE STUDY CARRELS

MODEL NUMBER	DESCRIPTION	LIST PRICE
C-3136-O-CDF	Carrel work station, double faced, starter 61" deep x 38" wide x 48" high, 1 1/4"	6222.00
	thick end panel with 3" solid oak post, 4" high top and bottom rails, 3" wide center	
	rail with raised panel interior panels, 2 each HPL tops 1 1/4" thick with 3/4" deep	
	solid oak edge banding, back panel is 1 1/4" thick	
C-3136-O-CDF-A	Carrel work station, double faced, adder 61" deep x 36 1/2" wide x 48" high,	4752.00
	1 1/4" thick intermediate panel with 3" solid oak posts, 4" high top and bottom	
	rails, with flush interior panel, 2 each HPL tops 1 1/4" thick with 3/4" deep solid	
	oak edge banding, back panel is 1 1/4" thick	
C-3148-O-CDF	Carrel work station, double faced, starter 61" deep x 50" wide x 48" high, 1 1/4"	6768.00
	thick end panel with 3" solid oak post, 4" high top and bottom rails, 3" wide center	
	rail with raised panel interior panels, 2 each HPL tops 1 1/4" thick with 3/4" deep	
	solid oak edge banding, back panel is 1 1/4" thick	
C-3148-O-CDF-A	Carrel work station, double faced, adder 61" deep x 48 1/2" wide x 48" high,	5244.00
	1 1/4" thick intermediate panel with 3" solid oak posts, 4" high top and bottom	
	rails, with flush interior panel, 2 each HPL tops 1 1/4" thick with 3/4" deep solid	
	banding, back panel is 1 1/4" thick	
C-3172-O-CDF	Carrel work station, double faced, starter 61" deep x 74" wide x 48" high, 1 1/4"	9112.00
	thick end panel with 3" solid oak post, 4" high top and bottom rails, 3" wide center	
	rail with raised panel interior panels, 2 each HPL tops 1 1/4" thick with 3/4" deep	
	solid oak edge banding, back panel is 1 1/4" thick	
C-3172-O-CDF-A	Carrel work station, double faced, adder 61" deep x 72 1/2" wide x 48" high,	6874.00
	1 1/4" thick intermediate panel with 3" solid oak posts, 4" high top and bottom	
	rails, with flush interior panel, HPL top 1 1/4" thick with 3/4" deep solid oak edge	
	banding, back panel is 1 1/4" thick	
SUFFIX -M	For maple tables change suffix O to M and add 7 percent	
SUFFIX -C	For cherry tables change suffix O to C and consult factory for up charge.	

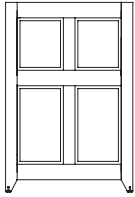

CLASSICS

HEXAGONAL CARRELS & DISPLAY UNITS

MODEL NUMBER	DESCRIPTION	LIST PRICE
C-9849-O-1/2HEX	Half hexagonal OPAC station with 3 work spaces 98" x 49" with open central core for wiring access, 1 1/4" thick HPL work surfaces with 3/4" deep solid oak edge banding and 2" cord drop, 1 1/4" thick center panels, 1 1/4" thick end panels have 3" posts with 4" top and bottom rails, 3" center vertical rail and raised panel panel inserts	9737.00
C-9898-O-HEX	Hexagonal OPAC station with 6 work spaces 98" x 98" with central core for wiring access, 1 1/4" thick HPL work surfaces with 3/4" deep solid oak edge banding and 2" cord drop, 1 1/4" thick center panels, 1 1/4" thick end panels have 3" posts with 4" top and bottom rails, 3" center vertical rail and raised panel panel inserts	17252.00
C-AS-3045-O	Atlas stand with 3" posts, 4" top and bottom rails with 3" center rail and raised panel inserts, sloped top with 5 each pull out shelves	5505.00
C-DS-2445-O	Dictionary stand with 3" posts, 4" top and bottom rails, 3" vertical center rail and raised panel inserts, sloped top with base shelf and 1 adjustable shelf	4114.00
C-TI-90-DFT-O	Index table double faced, double tier 49" deep x 90" wide x 50" high, HPL top 1 1/4" thick with 1 5/8" high x 3/4" thick solid oak edge banding, 2 end frames consisting of 2 1/2" solid oak legs, apron and stretcher 2 1/2" high x 2" thick with 6 each vertical pilasters 2/4" wide x 1 3/4" thick , aprons and stretchers are dowelled and mechanically fastened into the end frame, end frames attach to the underside of the top with metal plates, a box keel runs the length of the table between the end, index rack has adjustable shelves	7083.00
C-6331-DSP-O	Display table 63 1/2" wide x 31" deep x 38 11/16" high, HPL top 1 1/4" thick with 1 5/8" high x 3/4" thick solid oak edge banding, 2 end frames consisting 2 1/2" solid oak legs, apron and stretcher 2 1/2" high x 2" thick with 6 each vertical pilasters 2/4" wide x 1 3/4" thick , aprons and stretchers are dowelled and mechanically fastened into the end frame, end frames attach to the underside of the top with metal plates, a box keel runs the length of the table between the end frames for added support, glass case to be 59" wide x 29" deep x 9 11/16" high	8223.00

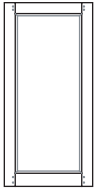

CLASSICS

END PANELS IN OAK

MODEL NUMBER	DESCRIPTION	LIST PRICE
C-4412-DF-O	End panel 44" high x 12" deep, 1" thick with 2 1/2" solid oak edge banding on all sides with raised panel insert	825.00
C-4413-DF-O	End panel 44" high x 13" deep, 1" thick with 2 1/2" solid oak edge banding on all sides with raised panel insert	838.00
C-4414-DF-O	End panel 44" high x 14" deep, 1" thick with 2 1/2" solid oak edge banding on all sides raised panel insert	851.00
C-4416-DF-O	End panel 44" high x 16" deep, 1" thick with 2 1/2" solid oak edge banding on all sides with raised panel insert	864.00
C-4418-DF-O	End panel 44" high x 18" deep, 1" thick with 2 1/2" solid oak edge banding on all sides raised panel insert	888.00
C-4420-DF-O	End panel 44" high x 20" deep, 1" thick with 2 1/2" solid oak edge banding on all sides with raised panel insert	926.00
C-4422-DF-O	End panel 44" high x 22" deep, 1" thick with 2 1/2" solid oak edge banding on all sides with raised panel insert	949.00
C-4424-DF-O	End panel 44" high x 24" deep, 1" thick with 2 1/2" solid oak edge banding on all sides with raised panel insert	975.00
C-4425-DF-O	End panel 44" high x 25" deep, 1" thick with 2 1/2" solid oak edge banding on all sides with raised panel insert	988.00
C-4428-DF-O	End panel 44" high x 28" deep, 1" thick with 2 1/2" solid oak edge banding on all sides with raised panel insert	1025.00
C-4432-DF-O	End panel 44" high x 32" deep, 1" thick with 2 1/2" solid oak edge banding on all sides with raised panel insert	1099.00
C-4812-DF-O	End panel 48" high x 12" deep, 1" thick with 2 1/2" solid oak edge banding on all sides with raised panel insert	846.00
C-4813-DF-O	End panel 48" high x 13" deep, 1" thick with 2 1/2" solid oak edge banding on all sides with raised panel insert	856.00

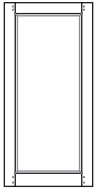

CLASSICS

END PANELS IN OAK

MODEL NUMBER	DESCRIPTION	LIST PRICE
C-4814-DF-O	End panel 48" high x 14" deep, 1" thick with 2 1/2" solid oak edge banding on all sides with raised panel insert	869.00
C-4816-DF-O	End panel 48" high x 16" deep, 1" thick with 2 1/2" solid oak edge banding on all sides with raised panel insert	882.00
C-4818-DF-O	End panel 48" high x 18" deep, 1" thick with 2 1/2" solid oak edge banding on all sides with raised panel insert	904.00
C-4820-DF-O	End panel 48" high x 20" deep, 1" thick with 2 1/2" solid oak edge banding on all sides with raised panel insert	931.00
C-4822-DF-O	End panel 48" high x 22" deep, 1" thick with 2 1/2" solid oak edge banding on all sides with raised panel insert	970.00
C-4824-DF-O	End panel 48" high x 24" deep, 1" thick with 2 1/2" solid oak edge banding on all sides with raised panel insert	994.00
C-4825-DF-O	End panel 48" high x 25" deep, 1" thick with 2 1/2" solid oak edge banding on all sides with raised panel insert	1018.00
C-4828-DF-O	End panel 48" high x 28" deep, 1" thick with 2 1/2" solid oak edge banding on all sides with raised panel insert	1050.00
C-4832-DF-O	End panel 48" high x 32" deep, 1" thick with 2 1/2" solid oak edge banding on all sides with raised panel insert	1124.00
C-5012-DF-O	End panel 50" high x 12" deep, 1" thick with 2 1/2" solid oak edge banding on all sides with raised panel insert	882.00
C-5013-DF-O	End panel 50" high x 13" deep, 1" thick with 2 1/2" solid oak edge banding on all sides with raised panel insert	894.00
C-5014-DF-O	End panel 50" high x 14" deep, 1" thick with 2 1/2" solid oak edge banding on all sides with raised panel insert	907.00
C-5016-DF-O	End panel 50" high x 16" deep, 1" thick with 2 1/2" solid oak edge banding on all sides with raised panel insert	919.00

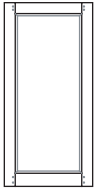

CLASSICS

END PANELS IN OAK

MODEL NUMBER	DESCRIPTION	LIST PRICE
C-5018-DF-O	End panel 50" high x 18" deep, 1" thick with 2 1/2" solid oak edge banding on all edges with raised panel insert	944.00
C-5020-DF-O	End panel 50" high x 20" deep, 1" thick with 2 1/2" solid oak edge banding on all edges with raised panel insert	970.00
C-5022-DF-O	End panel 50" high x 22" deep, 1" thick with 2 1/2" solid oak edge banding on all edges with raised panel insert	1007.00
C-5024-DF-O	End panel 50" high x 24" deep, 1" thick with 2 1/2" solid oak edge banding on all edges with raised panel insert	1031.00
C-5025-DF-O	End panel 50" high x 25" deep, 1" thick with 2 1/2" solid oak edge banding on all edges with raised panel insert	1055.00
C-5028-DF-O	End panel 50" high x 28" deep, 1" thick with 2 1/2" solid oak edge banding on all edges with raised panel insert	1086.00
C-5032-DF-O	End panel 50" high x 32" deep, 1" thick with 2 1/2" solid oak edge banding on all edges with raised panel insert	1174.00
C-6612-DF-O	End panel 66" high x 12" deep, 1" thick with 2 1/2" solid oak edge banding on all edges with horizontal rail 2 1/2" high dividing 2 raised inset panels	1185.00
C-6613-DF-O	End panel 66" high x 13" deep, 1" thick with 2 1/2" solid oak edge banding on all edges with horizontal rail 2 1/2" high dividing 2 raised inset panels	1203.00
C-6614-DF-O	End panel 66" high x 14" deep, 1" thick with 2 1/2" solid oak edge banding on all edges with horizontal rail 2 1/2" high dividing 2 raised inset panels	1224.00
C-6616-DF-O	End panel 66" high x 16" deep, 1" thick with 2 1/2" solid oak edge banding on all edges with horizontal rail 2 1/2" high dividing 2 raised inset panels	1224.00
C-6618-DF-O	End panel 66" high x 18" deep, 1" thick with 2 1/2" solid oak edge banding on all edges with horizontal rail 2 1/2" high dividing 2 raised inset panels	1285.00
C-6620-DF-O	End panel 66" high x 20" deep, 1" thick with 2 1/2" solid oak edge banding on all edges with horizontal rail 2 1/2" high dividing 2 raised inset panels	1322.00

CLASSICS

END PANELS IN OAK

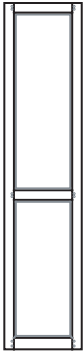

MODEL NUMBER	DESCRIPTION	LIST PRICE
C-6622-DF-O	End panel 66" high x 22" deep, 1" thick with 2 1/2" solid oak edge banding on all edges with horizontal rail 2 1/2" high dividing 2 raised inset panels	1258.00
C-6624-DF-O	End panel 66" high x 24" deep, 1" thick with 2 1/2" solid oak edge banding on all edges with horizontal rail 2 1/2" high dividing 2 raised inset panels	1295.00
C-6625-DF-O	End panel 66" high x 25" deep, 1" thick with 2 1/2" solid oak edge banding on all edges with horizontal rail 2 1/2" high dividing 2 raised inset panels	1333.00
C-6628-DF-O	End panel 66" high x 28" deep, 1" thick with 2 1/2" solid oak edge banding on all edges with horizontal rail 2 1/2" high dividing 2 raised inset panels	1382.00
C-6632-DF-O	End panel 66" high x 32" deep, 1" thick with 2 1/2" solid oak edge banding on all edges with horizontal rail 2 1/2" high dividing 2 raised inset panels	1555.00
C-7812-DF-O	End panel 78" high x 12" deep, 1" thick with 2 1/2" solid oak edge banding on all edges with horizontal rail 2 1/2" high dividing 2 raised inset panels	1320.00
C-7813-DF-O	End panel 78" high x 13" deep, 1" thick with 2 1/2" solid oak edge banding on all edges with horizontal rail 2 1/2" high dividing 2 raised inset panels	1338.00
C-7814-DF-O	End panel 78" high x 14" deep, 1" thick with 2 1/2" solid oak edge banding on all edges with horizontal rail 2 1/2" high dividing 2 raised inset panels	1356.00
C-7816-DF-O	End panel 78" high x 16" deep, 1" thick with 2 1/2" solid oak edge banding on all edges with horizontal rail 2 1/2" high dividing 2 raised inset panels	1394.00
C-7818-DF-O	End panel 78" high x 18" deep, 1" thick with 2 1/2" solid oak edge banding on all edges with horizontal rail 2 1/2" high dividing 2 raised inset panels	1431.00
C-7820-DF-O	End panel 78" high x 20" deep, 1" thick with 2 1/2" solid oak edge banding on all edges with horizontal rail 2 1/2" high dividing 2 raised inset panels	1468.00
C-7822-DF-O	End panel 78" high x 22" deep, 1" thick with 2 1/2" solid oak edge banding on all edges with horizontal rail 2 1/2" high dividing 2 raised inset panels	1507.00
C-7824-DF-O	End panel 78" high x 24" deep, 1" thick with 2 1/2" solid oak edge banding on all edges with horizontal rail 2 1/2" high dividing 2 raised inset panels	1553.00

CLASSICS

END PANELS IN OAK

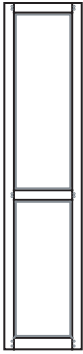

MODEL NUMBER	DESCRIPTION	LIST PRICE
C-7825-DF-O	End panel 78" high x 25" deep, 1" thick with 2 1/2" solid oak edge banding on all edges with horizontal rail 2 1/2" high dividing 2 raised inset panels	1581.00
C-7828-DF-O	End panel 78" high x 28" deep, 1" thick with 2 1/2" solid oak edge banding on all edges with horizontal rail 2 1/2" high dividing 2 raised inset panels	1631.00
C-7832-DF-O	End panel 78" high x 32" deep, 1" thick with 2 1/2" solid oak edge banding on all edges with horizontal rail 2 1/2" high dividing 2 raised inset panels	1679.00
C-8412-DF-O	End panel 84" high x 12" deep, 1" thick with 2 1/2" solid oak edge banding on all edges with horizontal rail 2 1/2" high dividing 2 raised inset panels	1444.00
C-8413-DF-O	End panel 84" high x 13" deep, 1" thick with 2 1/2" solid oak edge banding on all edges with horizontal rail 2 1/2" high dividing 2 raised inset panels	1462.00
C-8414-DF-O	End panel 84" high x 14" deep, 1" thick with 2 1/2" solid oak edge banding on all edges with horizontal rail 2 1/2" high dividing 2 raised inset panels	1481.00
C-8416-DF-O	End panel 84" high x 16" deep, 1" thick with 2 1/2" solid oak edge banding on all edges with horizontal rail 2 1/2" high dividing 2 raised inset panels	1500.00
C-8418-DF-O	End panel 84" high x 18" deep, 1" thick with 2 1/2" solid oak edge banding on all edges with horizontal rail 2 1/2" high dividing 2 raised inset panels	1525.00
C-8420-DF-O	End panel 84" high x 20" deep, 1" thick with 2 1/2" solid oak edge banding on all edges with horizontal rail 2 1/2" high dividing 2 raised inset panels	1550.00
C-8422-DF-O	End panel 84" high x 22" deep, 1" thick with 2 1/2" solid oak edge banding on all edges with horizontal rail 2 1/2" high dividing 2 raised inset panels	1574.00
C-8424-DF-O	End panel 84" high x 24" deep, 1" thick with 2 1/2" solid oak edge banding on all edges with horizontal rail 2 1/2" high dividing 2 raised inset panels	1598.00
C-8425-DF-O	End panel 84" high x 25" deep, 1" thick with 2 1/2" solid oak edge banding on all edges with horizontal rail 2 1/2" high dividing 2 raised inset panels	1618.00
C-8428-DF-O	End panel 84" high x 28" deep, 1" thick with 2 1/2" solid oak edge banding on all edges with horizontal rail 2 1/2" high dividing 2 raised inset panels	1668.00

CLASSICS

END PANELS IN OAK

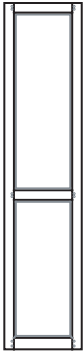

MODEL NUMBER	DESCRIPTION	LIST PRICE
C-8432-DF-O	End panel 84" high x 32" deep, 1" thick with 2 1/2" solid oak edge banding on all edges with horizontal rail 2 1/2" high dividing 2 raised inset panels	1728.00
C-9012-DF-O	End panel 90" high x 12" deep, 1" thick with 2 1/2" solid oak edge banding on all edges with horizontal rail 2 1/2" high dividing 2 raised inset panels	1412.00
C-9013-DF-O	End panel 90" high x 13" deep, 1" thick with 2 1/2" solid oak edge banding on all edges with horizontal rail 2 1/2" high dividing 2 raised inset panels	1436.00
C-9014-DF-O	End panel 90" high x 14" deep, 1" thick with 2 1/2" solid oak edge banding on all edges with horizontal rail 2 1/2" high dividing 2 raised inset panels	1460.00
C-9016-DF-O	End panel 90" high x 16" deep, 1" thick with 2 1/2" solid oak edge banding on all edges with horizontal rail 2 1/2" high dividing 2 raised inset panels	1486.00
C-9018-DF-O	End panel 90" high x 18" deep, 1" thick with 2 1/2" solid oak edge banding on all edges with horizontal rail 2 1/2" high dividing 2 raised inset panels	1523.00
C-9020-DF-O	End panel 90" high x 20" deep, 1" thick with 2 1/2" solid oak edge banding on all edges with horizontal rail 2 1/2" high dividing 2 raised inset panels	1539.00
C-9022-DF-O	End panel 90" high x 22" deep, 1" thick with 2 1/2" solid oak edge banding on all edges with horizontal rail 2 1/2" high dividing 2 raised inset panels	1597.00
C-9024-DF-O	End panel 90" high x 24" deep, 1" thick with 2 1/2" solid oak edge banding on all edges with horizontal rail 2 1/2" high dividing 2 raised inset panels	1635.00
C-9025-DF-O	End panel 90" high x 25" deep, 1" thick with 2 1/2" solid oak edge banding on all edges with horizontal rail 2 1/2" high dividing 2 raised inset panels	1653.00
C-9028-DF-O	End panel 90" high x 28" deep, 1" thick with 2 1/2" solid oak edge banding on all edges with horizontal rail 2 1/2" high dividing 2 raised inset panels	1703.00
C-9032-DF-O	End panel 90" high x 32" deep, 1" thick with 2 1/2" solid oak edge banding on all edges with horizontal rail 2 1/2" high dividing 2 raised inset panels	1753.00

CLASSICS

END PANELS IN OAK

SUFFIX-M	For maple end panels change suffix O to M and add 7 percent
SUFFIX-C	For cherry end panels change suffix O to C and contact factory

